



# Fengates Road, Redhill

£950,000





“

Not only have we loved living in this house but the sense of community on the street has made it such a wonderful place to live and start a family.

”



This stunning property on Fengates Road offers a harmonious blend of modern living and timeless elegance. With extensive extensions and meticulous refurbishments, it stands as a testament to refined taste and thoughtful design.

The home features four spacious bedrooms, each providing a serene retreat. The heart of the home is the expansive kitchen/diner—a space that invites culinary creativity as well as an ideal hosting area. Stepping outside through the stylish French doors, you have a beautifully presented south facing, landscaped garden. The ground floor extension benefits from underfloor heating. There is a utility room which offers needed convenience in modern day life.



Inside, contemporary interiors with light-filled rooms, neutral tones, and high-quality finishes create an inviting atmosphere. Every detail, from fixtures to flooring, has been carefully considered. Situated on Fengates Road, this property enjoys convenient access to local amenities, schools, and transport links.

Whether you're hosting friends in the open-plan kitchen or relaxing in the garden, this home offers a lifestyle of comfort and sophistication. Arrange a viewing today to experience the charm of Fengates Road firsthand!



# Need to know

- Substantial four bedroom detached home
- Meticulously refurbished and thoughtfully designed
- Extended kitchen / dining room with underfloor heating and a central island
- Immaculate condition throughout
- Equidistance to Redhill & Reigate towns
- Walking distance to local amenities, schools and train stations
- Four spacious bedrooms serviced by an en suite and a family bathroom
- Downstairs toilet for added convenience
- South facing landscaped garden
- Driveway and ample off street parking

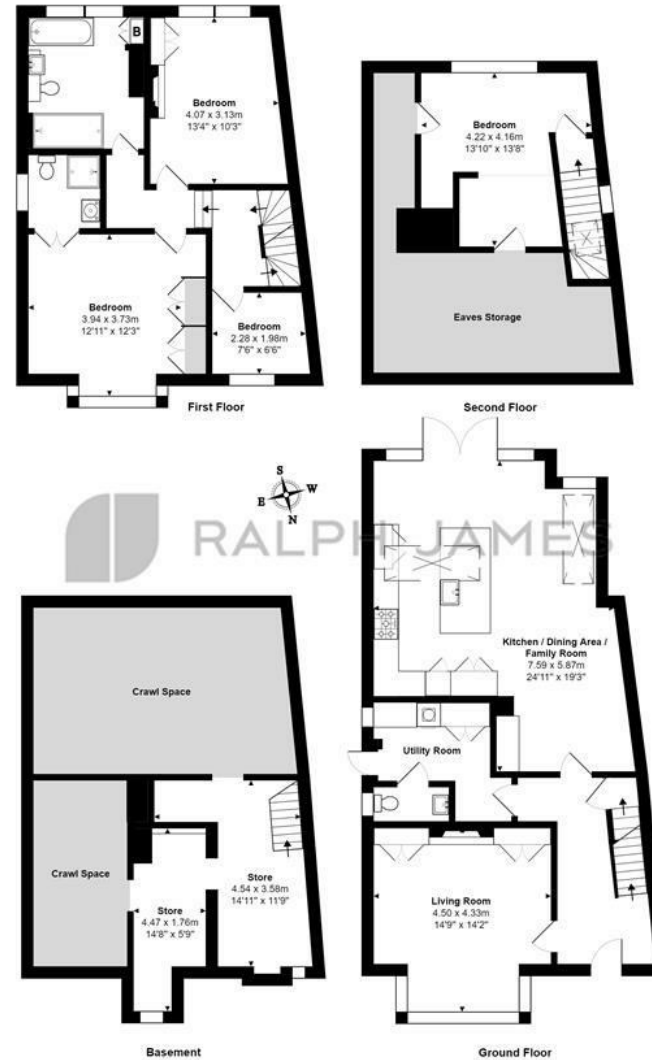

Fengates Road, Redhill  
Total Area: 173.3 m<sup>2</sup> ... 1866 ft<sup>2</sup> (excluding crawl space, eaves storage)

FOR ILLUSTRATIVE PURPOSES ONLY.

Whilst every attempt has been made to ensure the accuracy of the floor plan shown, all measurements, positioning, fixtures, features, fittings and any other data shown are an approximate interpretation for illustrative purposes only and are not to scale.

No responsibility is taken for any error, omission, mis-statement or use of data shown.

The above statement applies to both: 'STIR Moving London LTD' and the Company or individual displaying this floor plan.

Unauthorised reproduction prohibited.

AD 588 Moving London LTD (www.stirmoving.london)

## Interested?

redhill@ralphjames.co.uk  
01737 765 555

1

ralphjames.co.uk

RALPH JAMES