

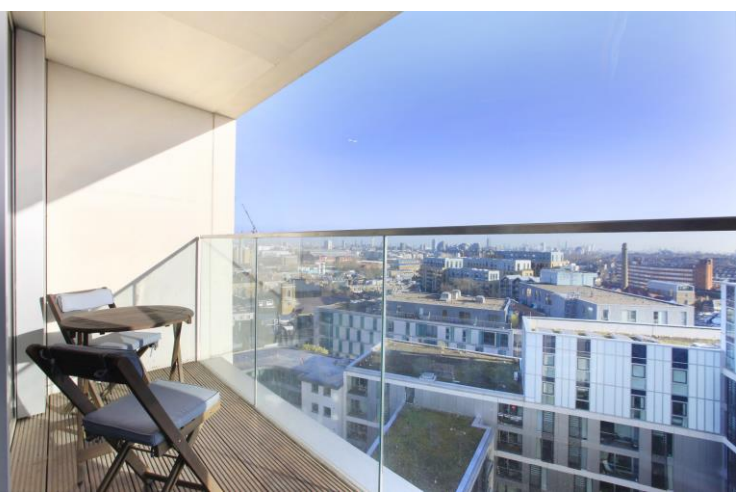

Copperlight Apartments

16 Buckhold Road, SW18

CHESTERTONS





This delightful 11th floor apartment is set within 'The Filaments', a development in the heart of Wandsworth. Floor to ceiling windows flood this property with natural light and the apartment has been neutrally decorated throughout.

This beautifully finished apartment comprises of a spacious open-plan kitchen/reception room providing generous entertaining space and benefitting from a private balcony. There is a well-appointed modern kitchen with integrated appliances, the double bedroom has built-in wardrobes and sliding doors leading to the balcony and there is a contemporary bathroom.

The property further benefits a lift, 24 hour concierge and beautifully landscaped communal gardens.

This impressive development is located in Wandsworth Town and has excellent transport links, including Wandsworth Town mainline station, East Putney Tube station and numerous bus links, a short distance away. An abundance of shops, cafes, bars and restaurants local to Wandsworth Town Centre and Southside shopping centre are also on the doorstep of this stunning apartment.

- A modern apartment in a stunning, sought after development
- Fantastic accommodation on the 11th floor of The Copperlight building in The Filaments
- A beautifully presented, open plan lounge/kitchen boasting high specification fixtures and fittings
- A double bedroom with built-in wardrobes
- Modern bathroom
- Private balcony with stunning views

Asking Price £450,000

Energy Efficiency Rating		Current	Potential
90-100	A		
81-89	B		
72-80	C		
63-71	D		
54-62	E		
45-53	F		
35-44	G		
Not energy efficient - higher running costs			
EU Directive 2002/91/EC			
England, Scotland & Wales			

Tenure: Leasehold 237 years
Service Charge: £3600
Ground Rent: £400
Local Authority: Wandsworth Council
Council Tax Band: D

Chestertons Wandsworth Sales

47 East Hill
Wandsworth
London
SW18 2QE
wandsworth@chestertons.co.uk
0208 104 7530

Copperlight Apartments, SW18

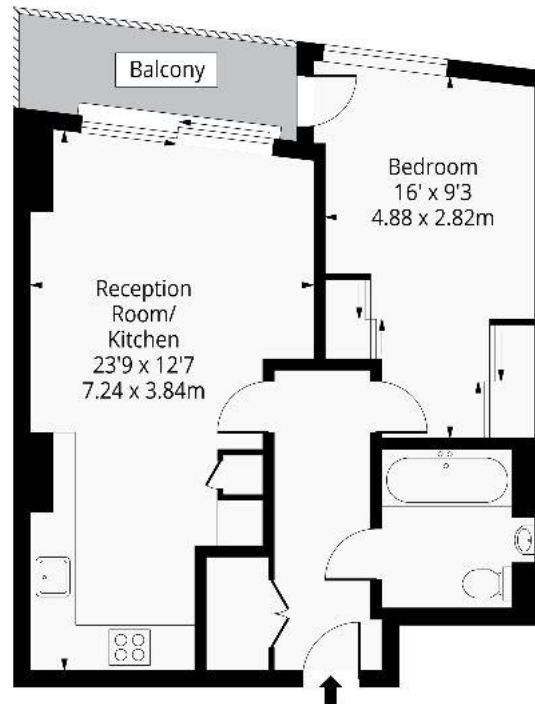

Eleventh Floor

Approx Gross Internal Area **523 Sq Ft - 48.58 Sq M**

For Illustration Purposes Only - Not To Scale

Ref: No. 38568

Chesterton UK Services Limited trading as Chestertons for themselves and for the vendor of this property whose agents they are, give notice that (i) these particulars do not constitute any part of an offer or contract, (ii) all statements contained within these particulars are made without responsibility on the part of Chestertons or the vendor, (iii) whilst made in good faith, none of the statements contained within these particulars are to be relied upon as a statement or representation of fact, (iv) any intending purchasers must satisfy themselves by inspection or otherwise as to the correctness of each of the statements contained within these particulars, (v) the vendor does not make or give either Chestertons or any person in their employment any authority to make or give representation or warranty whatsoever in relation to this property. Wide angle lenses may be used. ©Copyright Chestertons | Chesterton UK Services Limited | Registered Office 40 Connaught Street, Hyde Park, London W2 2AB Registered Company Number 05334580.



This paper is
100% recyclable