



**NASH
& CO**

Kensington Gardens
Camden | Bath



Summary

A characterful good sized three storey mid-terrace Victorian property in the stunning Camden area of Bath. Accommodation comprises – first floor entrance hallway; front double bedroom; middle double bedroom and kitchen to the rear; stairs lead down to the ground floor level and with living room, bathroom and shower room; to the second floor are 3 more double bedrooms. The sunny rear garden is south facing with sloping lawn and patio area and beautiful Views.

Location

The Camden area of Bath is situated on the northern slopes overlooking the city centre. There is proximity to the shops and cafés in Larkhall Village, as well as the varied amenities on London Road, including Morrison's supermarket, petrol station, Italian deli, pub and café. There is a local convenience store on Fairfield Road and pharmacy on Camden Road. The nearby Kensington Meadows provide a pleasant green space and walking route beside the River Avon. Likewise, there are more countryside walks to be enjoyed via Charlcombe Lane which leads up to Lansdown and beyond.



- Mid-terrace Victorian property
- Well presented
- Tenanted only until 30th June 2024
- Stunning views to the rear
- Versatile accommodation

- South facing garden
- Camden location
- Easy access to amenities on London Road
- Period features
- Freehold title

nashandcobath.co.uk

enquiries@nashandcobath.co.uk



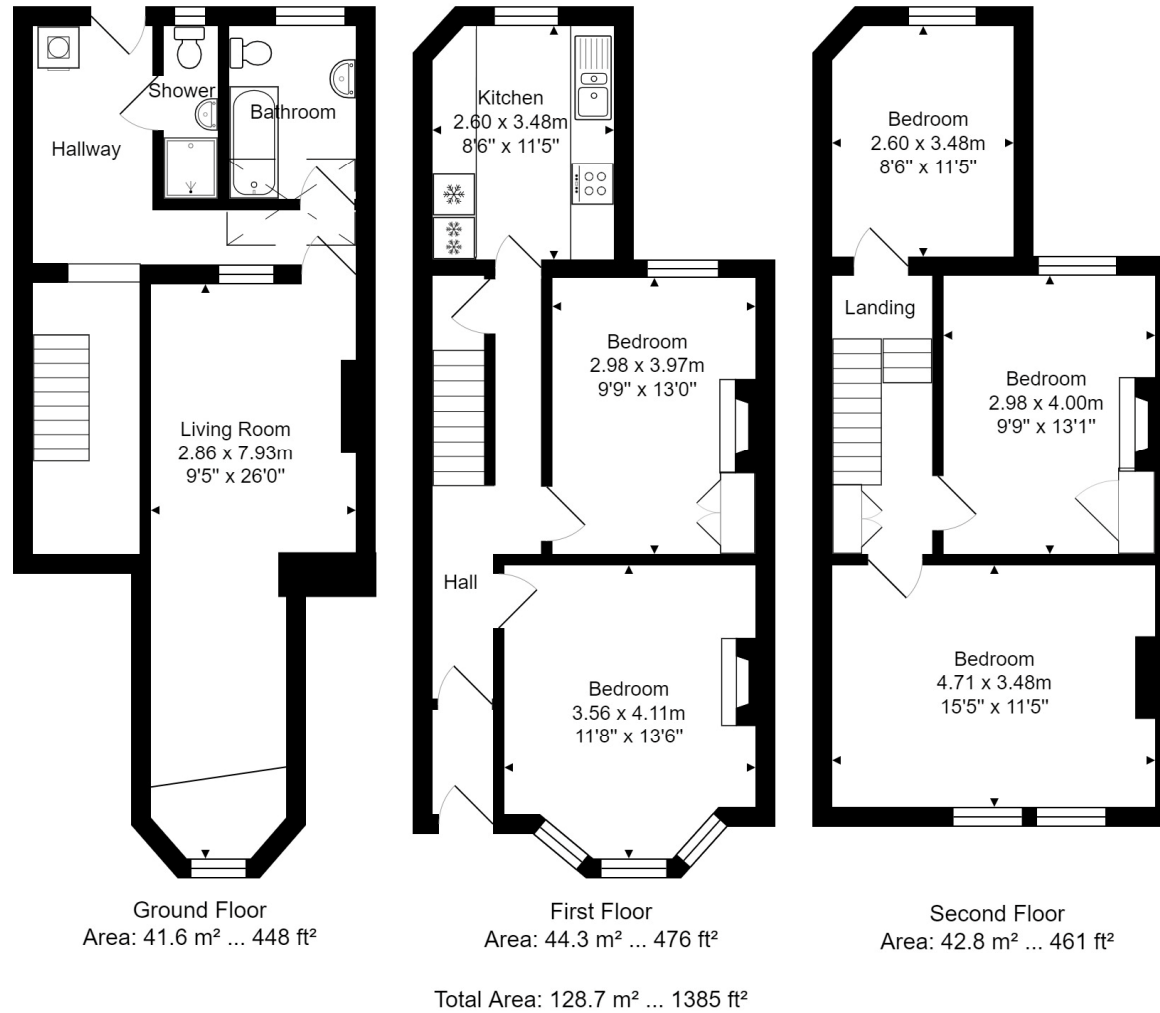

Nash & Co is a trading name of Nash & Co (Bath) Ltd, a company registered in England & Wales under registration number 09405604 with its registered office at 39 Oolite Road, Bath, BA2 2UU.

Agents Note: These particulars are set out as a general outline only for the guidance of intended purchasers and do not constitute an offer of contract or part thereof. For your information, the agent has not tested any apparatus, equipment, fixtures and fittings or services, so cannot verify they are in working order. A buyer is advised to obtain verification from the solicitor or surveyor. Please note that measurements are approximate only.