



Brooklyn Road,
Burntwood, WS7 4SJ

Offers in the Region Of £255,000

Offers in the Region Of £255,000

3  1  1 

NO ONWARD CHAIN Welcome to Brooklyn Road, a superbly presented three bedroom bungalow situated on the sought after Ridgeway Estate in Burntwood/Hammerwich borders.

An internal inspection reveals a welcoming entrance porch, inviting entrance hall, spacious living room, modern kitchen with space for appliances, versatile garden room, three generous bedrooms and completing the accommodation is the bathroom.

Externally the property boasts an easily maintained garden with plenty of space and side access, to the fore is a multi vehicle driveway providing off road parking.

Nearby amenities include a handful of local shops, easily accessible transport links and also fantastic local cafe's and dog walks.

CALL NOW TO VIEW!!!





Property Specification

HIGHLY SOUGHT AFTER LOCATION
BURNTWOOD/HAMMERWICH BORDERS
THREE BEDROOMS
SPACIOUS LIVING ROOM
MODERN KITCHEN

Porch

Hallway

Living Room 4.90m (16'1") x 3.84m (12'7")

Kitchen 3.18m (10'5") x 2.93m (9'7")

Bedroom 1 4.39m (14'5") x 3.18m (10'5")

Bedroom 2 3.18m (10'5") x 2.44m (8')

Bedroom 3 2.50m (8'2") x 2.00m (6'7")

Bathroom

Garden Room

Agent's Note:

Every care has been taken with the preparation of these Sales Particulars but they are for general guidance only and complete accuracy cannot be guaranteed. If there is any point which is of particular importance, professional verification should be sought. The mention of any fixtures, fittings and/or appliances does not imply they are in full efficient working order as they have not been tested. All dimensions are approximate. Photographs are reproduced for general information and it cannot be inferred that any item shown is included in the sale. These Sales Particulars do not constitute a contract or part of a contract.
Came on the market:

Viewer's Note:

Services connected: Gas, Electric, Water, Drainage
Council tax band: C
Tenure: Freehold

Floor Plan

This floor plan is not drawn to scale and is for illustration purposes only

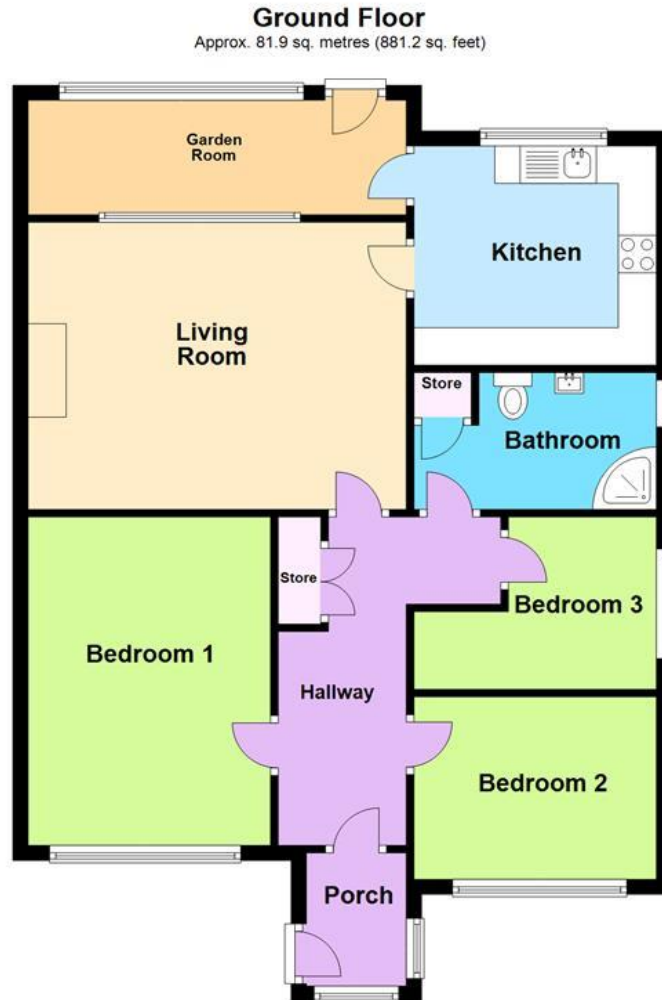

Total area: approx. 81.9 sq. metres (881.2 sq. feet)

Energy Efficiency Rating

**New
Instruction
Awaiting
E.P.C.**

Map Location

