



Orchard Road, Spixworth, NR10 3QE

This end-terrace property is ideally situated within the popular village of Spixworth, offering generous and versatile accommodation perfect for families, first-time buyers, or investors.

OIRO £210,000

GROUND FLOOR
414 sq.ft. (38.4 sq.m.) approx.

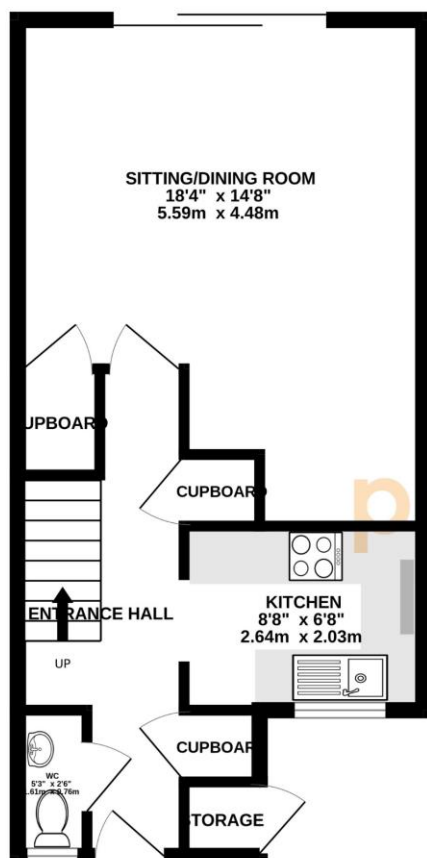

1ST FLOOR
367 sq.ft. (34.1 sq.m.) approx.

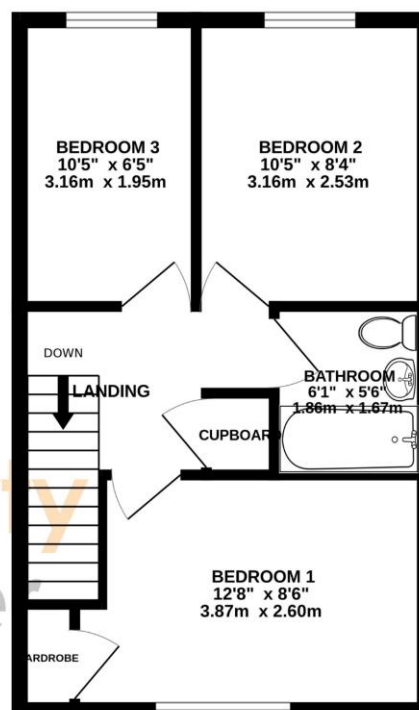

Room Dimensions

Entrance Hall

Ground Floor WC

Kitchen - 8'8" x 6'8" (2.64m x 2.03m)

Sitting/Dining Room - 18'4" x 14'8" (5.59m x 4.48m)

Bedroom One - 12'8" x 8'6" (3.87m x 2.60m)

Bedroom Two - 10'5" x 8'4" (3.16m x 2.53m)

Bedroom Three - 10'5" x 6'5" (3.16m x 1.95m)

Bathroom - 6'1" x 5'6" (1.86m x 1.67m)

Selling your home?

If you are considering selling your home please contact us for your no obligation free market appraisal.

Get in touch today!

Tel: 01603 666006



40 Exchange Street, Norwich, Norfolk, NR2 1AX



T 01603 666006

propertyladderonline.com

IMPORTANT NOTICE: Property Ladder, their clients and any joint agents give notice that: 1. They are not authorised to make or give any representations or warranties in relation to the property either here or elsewhere, either on their own behalf or on behalf of their client or otherwise. They assume no responsibility for any statement that may be made in these particulars. These particulars do not form part of any offer or contract and must not be relied upon as statements or representations of fact. 2. Any areas, measurements or distances are approximate. The text, photographs and plans are for guidance only and are not necessarily comprehensive. It should not be assumed that the property has all necessary planning, building regulation or other consents and Property Ladder have not tested any services, equipment or facilities. Purchasers must satisfy themselves by inspection or otherwise.