



Wolsey Street, London, E1

BUTLER & STAG





**Guide Price £400,000 - £425,000**  
**Nestled on one of Whitechapel's few remaining cobblestone streets (Wolsey Street), this well-proportioned two-bedroom apartment offers a unique blend of light filled space, and convenience. Set in the vibrant heart of East London, the property is just moments from excellent transport links, diverse local amenities, and the cultural energy that defines the area.**



## Leasehold

- Second Floor Apartment
- Two Bedrooms
- Located Moments From Whitechapel Tube Station (Elizabeth/District/Circle/Hammersmith Line)
- Secure Gated Development
- Separate Kitchen
- Bathroom

The apartment features a spacious light filled reception room, separate kitchen, two generous bedrooms, and a modern bathroom. The layout offers great natural light throughout and excellent potential for first-time buyers or investors alike.

Residents benefit from secure entry, well-maintained communal areas, and a strong sense of community within the building. With Whitechapel Station (Elizabeth Line, District, Hammersmith & City, and Overground) just a short walk away, central London and beyond are easily accessible.

Opportunities to live on a street like this in Whitechapel are increasingly rare—ideal for those seeking an authentic East London home with great connectivity.

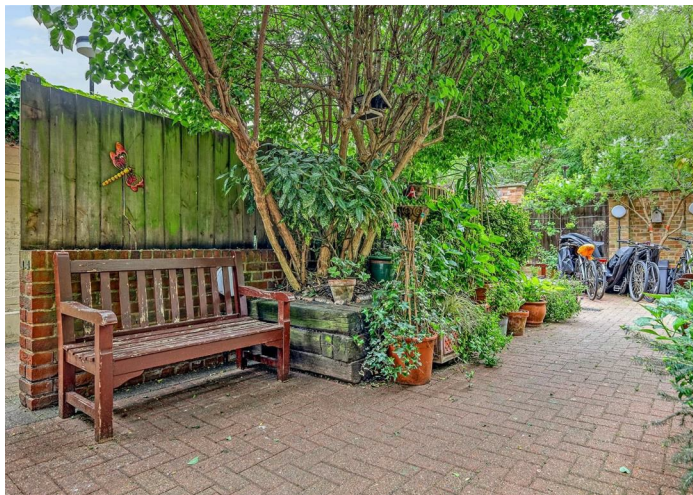





## Sandhurst House

Approx. Gross Internal Area 49.9 sq. metres (537.3 sq. feet)

BUTLER & STAG

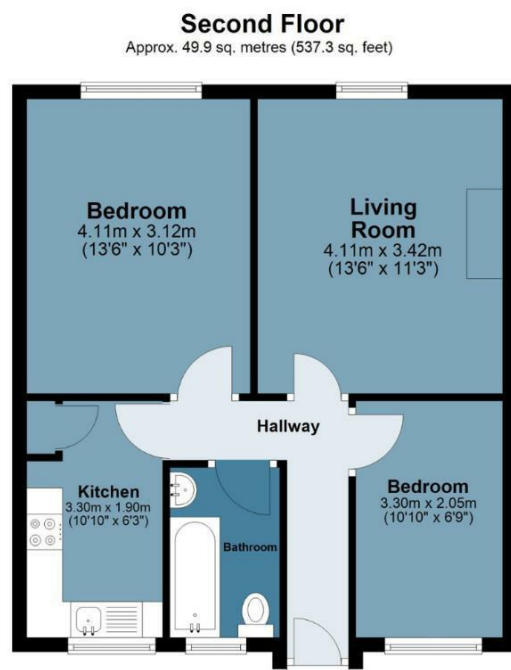

Measurements are approximate and for illustration purposes only. While we do not doubt the accuracy and completeness, we advise you conduct a careful independent assessment of the property to determine monetary value  
© @modephoto.uk www.modephoto.co.uk

IMPORTANT NOTICE - These particulars have been prepared in good faith and they are not intended to constitute part of an offer or contract. We have not performed a structural survey on this property and the services, appliances and specific fittings have not been tested. All photographs, measurements, floor plans and distances referred to are given as a guide and should not be relied upon.

BUTLER & STAG

☎ 020 8102 1236

🏠 508 Roman Road, Bow, London, E3 5LU

✉ bow@butlerandstag.com

[www.butlerandstag.uk](http://www.butlerandstag.uk)