



White Horse Lane, London, E1

BUTLER  STAG





## **\*Short Let 3-6 Months\* Smart and well- presented one bedroom apartment set within a modern development in the heart of Stepney Green.**



- Short Let of 3-6 Months
- Stepney Green Tube Station 0.3 Miles Away
- Residents Bike-Store and Landscaped Communal Gardens
- Offered Part Furnished
- One Bedroom Modern Apartment
- Private West-Facing Balcony
- Underfloor Heating / Water Softener
- Available Now!

Situated on the second floor of Sketch Apartments, this contemporary home offers both style and convenience and boasts a west-facing balcony which provides the perfect space to unwind and enjoy the surrounding urban landscape.

The open-plan concept living/dining area is the heart of the home, featuring large windows that flood the space with light. The layout is ideal for entertaining, whilst the balcony creates a fantastic extension to the main living space.

The sleek, modern kitchen is equipped with high-end appliances, ample cabinetry and quartz work surfaces. The bedroom is generously sized and the elegant bathroom boasts modern fixtures and a bath tub.

The apartment is finished to a high standard with quality flooring and contemporary décor throughout.

The building offers secure entry, bicycle storage and landscaped communal gardens to enjoy.

Located in the heart of Stepney Green, you'll have easy access to excellent transport links, including the nearby Stepney Green underground station. The area is also home to an array of local shops, cafes and parks, offering the perfect balance of city living with a community feel.

Offered part furnished and available immediately.

EPC Rating B  
Council Tax Band C







## Sketch Apartments, E1

Approx. Gross Internal Area 47 Sq M ( 502 Sq Ft )

BUTLER & STAG

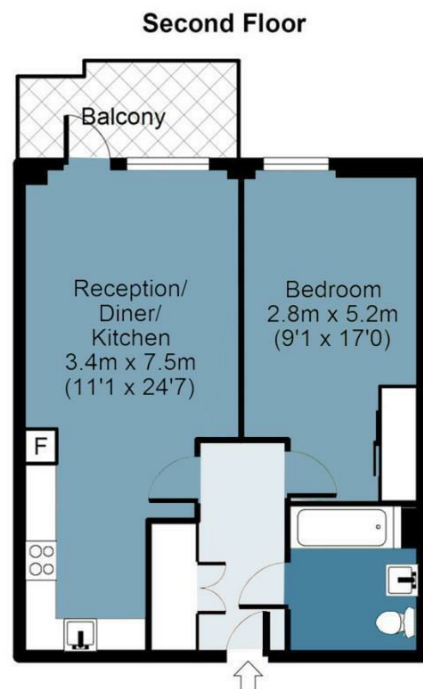

Measurements are approximate and for illustration purposes only. While we do not doubt the accuracy and completeness, we advise you conduct a careful independent assessment of the property to determine monetary value.  
© @modephoto.uk www.modephoto.co.uk

IMPORTANT NOTICE - These particulars have been prepared in good faith and they are not intended to constitute part of an offer or contract. We have not performed a structural survey on this property and the services, appliances and specific fittings have not been tested. All photographs, measurements, floor plans and distances referred to are given as a guide and should not be relied upon.

BUTLER & STAG

☎ 020 8102 1236

🏠 508 Roman Road, Bow, London, E3 5LU

✉ bow@butlerandstag.com

[www.butlerandstag.uk](http://www.butlerandstag.uk)