



Grantley Street, London, E1

BUTLER & STAG



Situated within the prestigious Carlton Square Conservation Area, this two-storey Victorian house offers a prime location with picturesque views of the leafy Carlton Green. Boasting three bedrooms, this property presents a unique opportunity for modernization, allowing its next owner to restore back to its former glory.



Freehold

- Unique Opportunity for Renovation and Development
- Views Of The Leafy Carlton Square Conservation Green
- Seperate Kitchen
- Victorian Two Storey House
- Three Bedrooms
- Rear Garden

The house features spacious rooms spread across two levels, providing ample space for comfortable living and entertaining. With its potential for renovation, it promises to be a canvas for creating the perfect home.

Outside, the property benefits from its tranquil surroundings and proximity to Carlton Green, offering a serene escape amidst East London. Residents can enjoy leisurely walks in the conservation area or relax in the private outdoor rear garden.

In summary, this Victorian gem presents a rare opportunity to acquire a home in a sought-after conservation area, ripe for renovation to suit contemporary tastes while enjoying views of Carlton Green.





Grantley Street

Approx. Gross Internal Area 91.8 sq. metres (987.9 sq. feet)

BUTLER & STAG

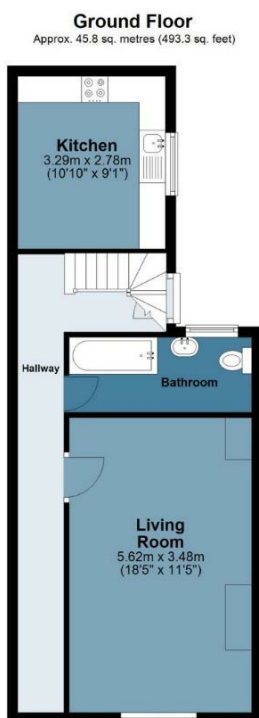

Measurements are approximate and for illustration purposes only. While we do not doubt the accuracy and completeness, we advise you conduct a careful independent assessment of the property to determine monetary value
© @modephoto.uk www.modephoto.co.uk

IMPORTANT NOTICE - These particulars have been prepared in good faith and they are not intended to constitute part of an offer or contract. We have not performed a structural survey on this property and the services, appliances and specific fittings have not been tested. All photographs, measurements, floor plans and distances referred to are given as a guide and should not be relied upon.

BUTLER & STAG

☎ 020 8102 1236

🏠 508 Roman Road, Bow, London, E3 5LU

✉ bow@butlerandstag.com

www.butlerandstag.uk