



High Street, London, E15

BUTLER & STAG



This modern and elegant one-bedroom apartment is situated in the highly sought-after Central House development in Stratford, E15. Offering a perfect blend of comfort, convenience, and contemporary design, this property is ideal for professionals, couples, or individuals seeking a vibrant urban lifestyle. The development also consists of a Gymnasium, Sauna and concierge services for added conveniences.



Leasehold

- Private Balcony
- Gymnasium And Sauna
- Extremely Well Connected
- Communal Roof Terrace
- Concierge On Site
- Walking Distance From Westfield Shopping Centre
- Pudding Mill Lane 4 Minute Walk Away
- Ninth Floor

The apartment boasts a bright and airy open-plan lounge with ample natural light, leading directly to a private balcony with stunning urban views. The modern kitchen is fully fitted with integrated appliances, sleek cabinetry and ample counter space making it the ideal space for cooking and entertaining. The apartment consists of a double-bedroom with generous storage space and it is completed by the stylish bathroom with modern fixtures and fittings, including a bathtub and shower.

The position of this development offers fantastic transport links, located just a short walk from Pudding Mill Lane DLR Station and Stratford Station, providing easy access to Canary Wharf, The City and Central London. Its also within close proximity to Westfield Stratford City, Queen Elizabeth Olympic Park, and a variety of restaurants, shops, and entertainment options. With Stratford's vibrant community and amenities at your doorstep, enjoy the best of urban living.





Central House

Approx. Gross Internal Area 38.8 Sq M (418 Sq Ft)

BUTLER & STAG

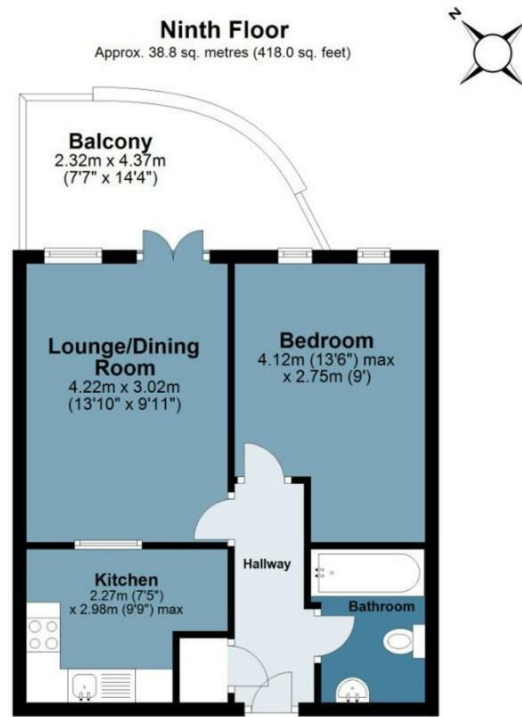

Measurements are approximate and for illustration purposes only. While we do not doubt the accuracy and completeness, we advise you conduct a careful independent assessment of the property to determine monetary value.
© @modephoto.uk www.modephoto.co.uk

IMPORTANT NOTICE - These particulars have been prepared in good faith and they are not intended to constitute part of an offer or contract. We have not performed a structural survey on this property and the services, appliances and specific fittings have not been tested. All photographs, measurements, floor plans and distances referred to are given as a guide and should not be relied upon.

BUTLER & STAG

☎ 020 8102 1236

🏠 508 Roman Road, Bow, London, E3 5LU

✉ bow@butlerandstag.com

www.butlerandstag.uk