



Sewardstone Road, London, E2

BUTLER & STAG



**Price Guide £825,000 - £875,000**  
**Nestled on the leafy street of Sewardstone Road in the Victoria Park Conservation area, this delightful three-bedroom (Freehold) house offers a perfect blend of modern comfort and classic charm. Boasting a prime location, this house provides easy access to a plethora of amenities, green spaces, and excellent transport links, making it an ideal choice for families or professionals seeking a dynamic urban lifestyle.**



## Freehold

- Victoria Park Conservation Area
- Two Storey Freehold House
- Rear Garden
- Three Bedrooms
- Stylish Bathroom
- Resident Parking Available
- Potential To Extend (subject to planning permission)
- Award Winning Victoria Park On Your Door Step

Upon entering the property, you are greeted by a warm and inviting hallway, thanks to the tasteful décor and abundance of natural light. The spacious living area is full width of the property and serves as the perfect gathering spot for family and friends, offering ample space for relaxation and entertainment.

The adjacent kitchen, features solid wood work surfaces, contemporary appliances, and plenty of storage space, ensuring both style and functionality. Whether preparing a quick breakfast or hosting a dinner party, this well-appointed kitchen caters to all culinary needs.

Upstairs, you'll find three generously sized bedrooms, each providing a peaceful retreat.

Completing the interior the bathroom is equipped with elegant fixtures, fully tiled walls, white suite that provides a sleek and modern finish.

Externally, the property boasts a private garden at the rear offering a serene outdoor space for al fresco dining or simply unwinding.

This charming three-bedroom house on Sewardstone Road offers a wonderful opportunity to experience contemporary urban living in one of East London's most sought-after locations. With its stylish interior, private garden, and convenient amenities, this property truly epitomizes modern comfort and convenience. Don't miss your chance to make this house your new home in Bethnal Green. Schedule a viewing today!





# Sewardstone Road

Approx. Gross Internal Area 78 sq. metres (839.7 sq. feet)

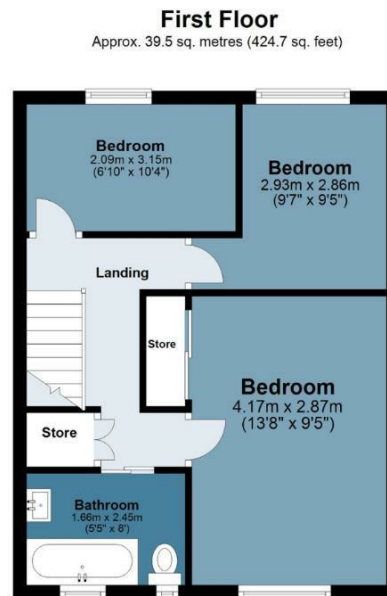
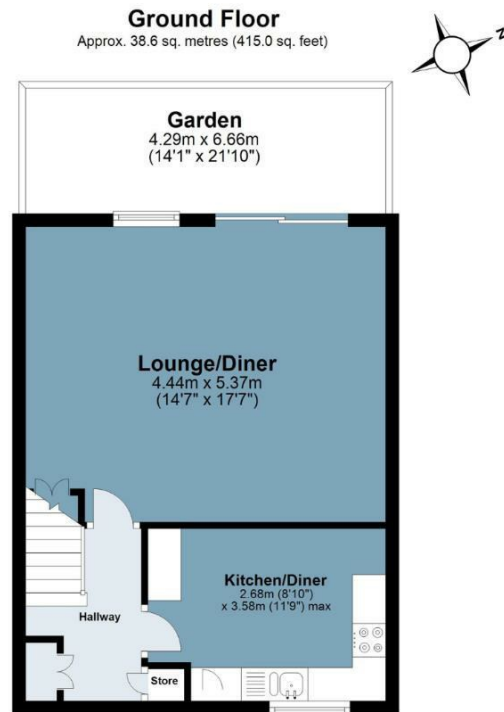

Measurements are approximate and for illustration purposes only. While we do not doubt the accuracy and completeness, we advise you conduct a careful independent assessment of the property to determine monetary value  
© @modephotouk www.modephoto.co.uk



☎ 020 8102 1236

🏠 508 Roman Road, Bow, London, E3 5LU

✉ bow@butlerandstag.com

[www.butlerandstag.uk](http://www.butlerandstag.uk)

IMPORTANT NOTICE - These particulars have been prepared in good faith and they are not intended to constitute part of an offer or contract. We have not performed a structural survey on this property and the services, appliances and specific fittings have not been tested. All photographs, measurements, floor plans and distances referred to are given as a guide and should not be relied upon.