



Cephass Street, London, E1

BUTLER  STAG



Charming two bedroom split-level apartment within a period conversion on a tree-lined road in Bethnal Green.



- Two Double Bedrooms
- Split-Level Period Conversion Apartment
- Tree-Lined Road
- Spacious Living Room
- Modern Kitchen/Diner
- Smart Shower Room
- Part Furnished
- Available 1st July 2024

Occupying the first and second floors, this attractive property comprises of two double bedrooms, a spacious living room, modern kitchen/diner and a smart shower room.

Offered part furnished and available from the start of July, this apartment is a short walking distance from Stepney Green underground station and plenty of local and convenient amenities. Bethnal Green underground station is also within easy reach.

Ideally suited to a professional couple or two professional sharers.

EPC Rating D
Council Tax Band C





Cephas Street

Approx. Gross Internal Area 74.3 sq. metres (799.4 sq. feet)

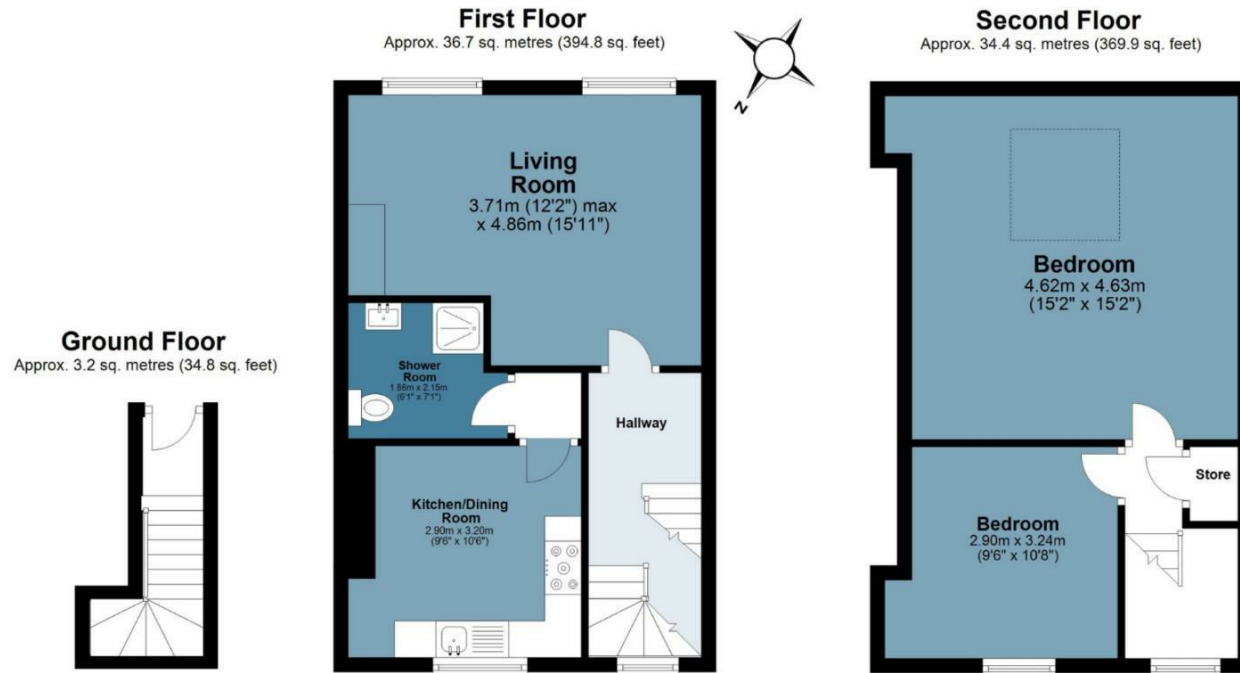

Measurements are approximate and for illustration purposes only. While we do not doubt the accuracy and completeness, we advise you conduct a careful independent assessment of the property to determine monetary value
© @modephotouk www.modephoto.co.uk



☎ 020 8102 1236

🏠 508 Roman Road, Bow, London, E3 5LU

✉ bow@butlerandstag.com

IMPORTANT NOTICE - These particulars have been prepared in good faith and they are not intended to constitute part of an offer or contract. We have not performed a structural survey on this property and the services, appliances and specific fittings have not been tested. All photographs, measurements, floor plans and distances referred to are given as a guide and should not be relied upon.

www.butlerandstag.uk