



Fairfield Road, London, E3

BUTLER & STAG



Exceptional one bedroom third floor apartment set within the iconic Bow Quarter development with its host of outstanding resident amenities.



- Exceptional One Bedroom Apartment
- Furnished
- Outstanding Resident Amenities
- Victoria Park and Roman Road Nearby
- Spacious and Excellent Condition
- Available 24th June
- Close to Bow Road and Bow Church Stations
- Beautifully Refurbished Bathroom

Spacious and superbly presented throughout, the property features a large living room / semi open-plan kitchen with integrated appliances and a breakfast bar. The bedroom is also over-sized with plenty of hanging space and ample room for a desk / WFH setup. The apartment further benefits from a beautifully refurbished bathroom, hallway storage and an allocated parking space.

Bow Quarter is conveniently positioned between Bow Road / Bow Church stations and Roman Road / Victoria Park. This wonderful development, with its beautifully manicured communal gardens and striking buildings offers residents 24-hour concierge service, an on-site convenience store and access to a leisure centre with a gym and swimming pool.

Offered furnished and available 24th June.





Park Central Building, Fairfield Road, E3

Approx. Gross Internal Area 554 Sq Ft - 51.47 Sq M

BUTLER & STAG

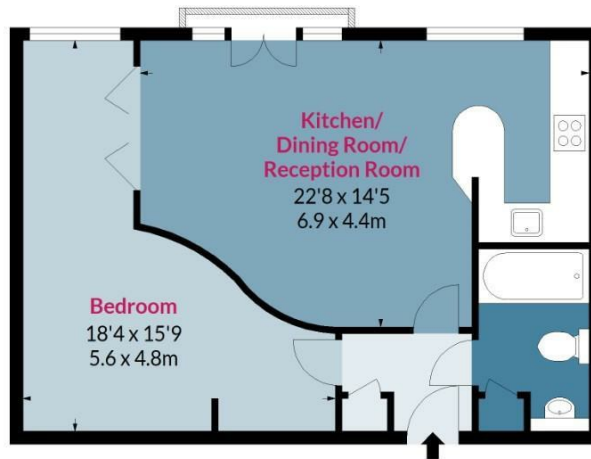

Third Floor

Floor Area 554 Sq Ft - 51.47 Sq M



Measured according to RICS IPMS2. Floor plan is for illustrative purposes only and is not to scale. Every attempt has been made to ensure the accuracy of the floor plan shown, however all measurements, fixtures, fittings and data shown are an approximate interpretation for illustrative purposes only. 1 sq m = 10.76 sq feet.

lpaplus.com

Date: 25/5/2023

IMPORTANT NOTICE - These particulars have been prepared in good faith and they are not intended to constitute part of an offer or contract. We have not performed a structural survey on this property and the services, appliances and specific fittings have not been tested. All photographs, measurements, floor plans and distances referred to are given as a guide and should not be relied upon.

BUTLER & STAG

☎ 020 8102 1236

🏠 508 Roman Road, Bow, London, E3 5LU

✉ bow@butlerandstag.com

www.butlerandstag.uk