

GROUNDS
334 sq.ft. (31.0 sq.m.) approx.

GROUND FLOOR
570 sq.ft. (53.0 sq.m.) approx.

1ST FLOOR
386 sq.ft. (35.8 sq.m.) approx.

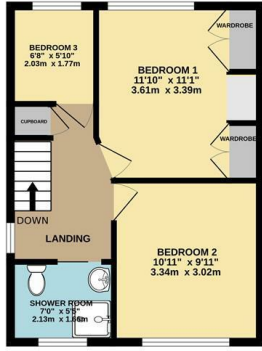
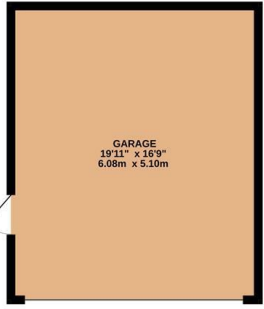

TOTAL FLOOR AREA : 1290 sq.ft. (119.8 sq.m.) approx.
Whilst every attempt has been made to ensure the accuracy of the floorplan contained here, measurements of doors, windows, rooms and any other items are approximate and no responsibility is taken for any error, omission or mis-statement. This plan is for illustrative purposes only and should be used as such by any prospective purchaser. The services, systems and appliances shown have not been tested and no guarantee as to their operability or efficiency can be given.
Made with Metropix ©2024



Bakewell
3 Royal Oak Place
Matlock Street
Bakewell DE45 1HD
T: 01629 700699
E: bakewell@elr.co.uk

Banner Cross
888 Ecclesall Road
Banner Cross
Sheffield S11 8TP
T: 01142 683388
E: bannercross@elr.co.uk

Dore
33 Townhead Road
Sheffield
S17 3GD
T: 0114 2362420
E: dore@elr.co.uk

Hathersage
Main Road, Hathersage
Hope Valley
Derbyshire S32 1BB
T: 01433 651888
E: peakdistrict@elr.co.uk

Rotherham
149 Bawtry Road
Wickersley
Rotherham S66 2BW
T: 01709 917676
E: wickersley@elr.co.uk

**EADON
LOCKWOOD
& RIDDLE**
ESTD 1840



**EADON
LOCKWOOD
& RIDDLE**
ESTD 1840

EADON

15, Arnside Road, Rotherham, S66 7ES

Offers In The Region Of £140,000

15 Arnside Road, Maltby, Rotherham,
S66 7ES

Description

Sit on Arnside Road in Maltby, this extended three-bedroom semi-detached house is a real find just waiting to be discovered. With a lovely extended Living Room and additional Dining Room, this home offers plenty of space for comfortable living. The kitchen is equipped with a range of wall and base units, providing ample storage and workspace for all your culinary needs. Additionally, there's a convenient downstairs WC, adding to the practicality of the home.

For those handy with tools or in the trades, the oversized garage and workshop are an absolute dream, perfect for projects and storage. You'll never have to worry about parking, either, thanks to the off-road parking for several cars and a large, secure carport. Plus, there's potential to extend to the side, giving you even more space to customise to your liking.

The extended living room at the back of the house is a wonderful spot for both relaxing and entertaining. It offers a seamless blend of indoor and outdoor living, making it easy to enjoy every season. This property is like a blank canvas, ready for you to add your personal touch and create a space that truly reflects your style and preferences.

Having been a cherished family home for over 50 years, this property radiates warmth and character. It's the perfect starter home for anyone looking to create new memories. Don't miss out on the chance to make this house your home and start your own chapter of happiness in this wonderful property.

- Extended Three Bedroom Semi Detached Family House
- Large Detached Garagewith Power and light
- Car Port and Off Road Parking for Several Cars
- Downstairs WC, Extended Living Room and Separate Dining Room
- Popular Residential Area
- Available with No Onward Chain
- FREEHOLD / TAX BAND A

