

**Coleridge Way, Borehamwood**  
**£425,000 (Leasehold - Share of Freehold)**



This GROUND FLOOR 2 Bed Apartment is located on the south side of Borehamwood in one of the areas most sought after roads. Just a short stroll from the mainline station, places of worship, bustling high street with a range of eateries and fantastic shopping facilities and in very close proximity to Yavneh College and an array of great infant and primary schools.

Boasting circa 800sqft of living accommodation the property has been recently renovated and is presented in fantastic condition. The floor space comprises of an entrance hallway, kitchen/living/dining room, master bedroom with en-suite shower room, a further double bedroom and family bathroom. Externally there is parking for 2 cars in the underground secure car park.

The property is share of freehold and therefore there is no ground rent.

**020 3764 2222**  
**[www.village-estates.co.uk](http://www.village-estates.co.uk)**



Village Estates  
The Corner Shop High Street, Elstree  
Herts WD6 3BY

Important Note: These particulars do not form part of any contract. All measurements are approximate and should not be relied upon. All prices quoted are strictly subject to contract.











Approx Gross Internal Area  
73 sq m / 791 sq ft

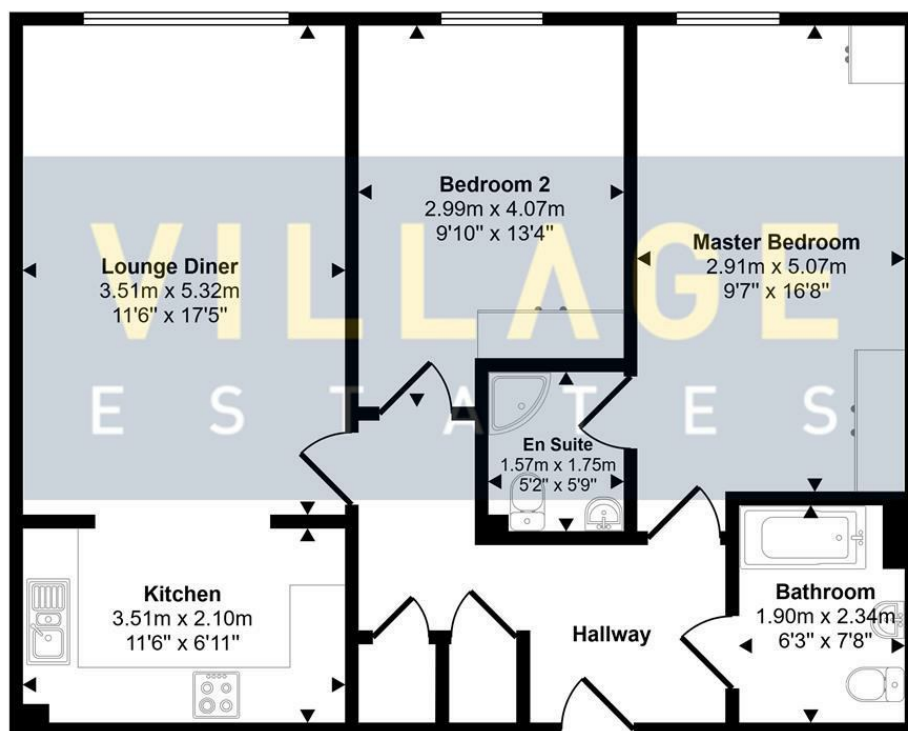

Floorplan

This floorplan is only for illustrative purposes and is not to scale. Measurements of rooms, doors, windows, and any items are approximate and no responsibility is taken for any error, omission or mis-statement. Icons of items such as bathroom suites are representations only and may not look like the real items. Made with Made Snappy 360.



Available on the  
**App Store**



ANDROID APP ON  
**Google play**

Energy Efficiency Rating		
	Current	Potential
Very energy efficient - lower running costs		
(92 plus) <b>A</b>		
(81-91) <b>B</b>		
(69-80) <b>C</b>		
(55-68) <b>D</b>		
(39-54) <b>E</b>		
(21-38) <b>F</b>		
(1-20) <b>G</b>		
Not energy efficient - higher running costs		
<b>England &amp; Wales</b>		EU Directive 2002/91/EC