

**Armstrong Close,
£1,250 ()**

VILLAGE
E S T A T E S



AVAILABLE NOW!! This 1 bedroom ground floor apartment is offered in good condition and Located in a quiet cul-de-sac in a sought after private development on the south side of Borehamwood. Within easy reach of Borehamwood High street and all local amenities.

The property comprises:- entrance hall, lounge/dining room, kitchen, recently re-fitted modern bathroom, double bedroom with built in wardrobe.

020 3764 2222
www.village-estates.co.uk



Village Estates
The Corner Shop High Street, Elstree
Herts WD6 3BY

Important Note: These particulars do not form part of any contract. All measurements are approximate and should not be relied upon. All prices quoted are strictly subject to contract.



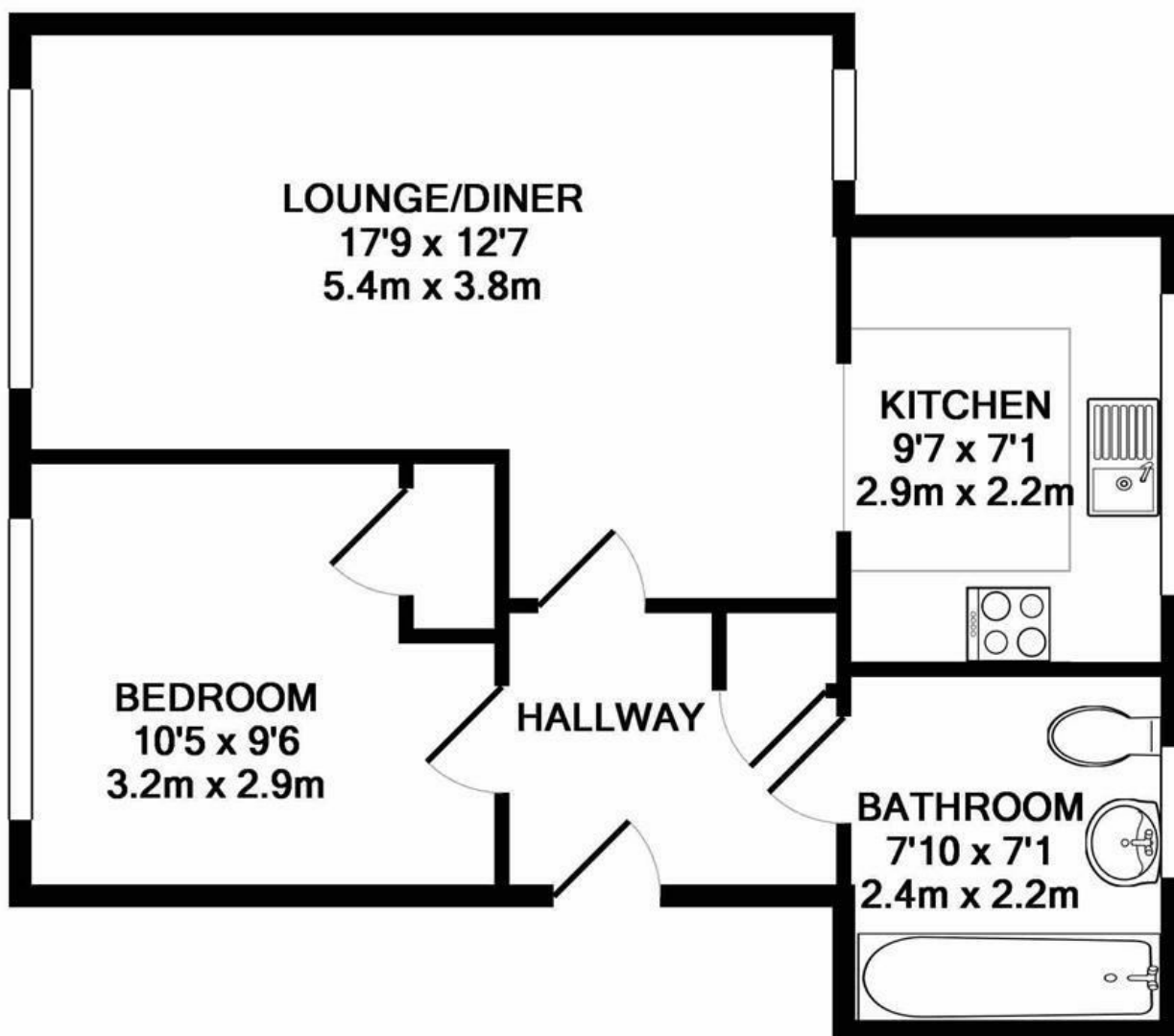

TOTAL APPROX. FLOOR AREA 459 SQ.FT. (42.6 SQ.M.)

Whilst every attempt has been made to ensure the accuracy of the floor plan contained here, measurements of doors, windows, rooms and any other items are approximate and no responsibility is taken for any error, omission, or mis-statement. This plan is for illustrative purposes only and should be used as such by any prospective purchaser. The services, systems and appliances shown have not been tested and no guarantee as to their operability or efficiency can be given

Made with Metropix ©2019



Energy Efficiency Rating		
	Current	Potential
Very energy efficient - lower running costs		
(92 plus) A		
(81-91) B		
(69-80) C		
(55-68) D		
(39-54) E		
(21-38) F		
(1-20) G		
Not energy efficient - higher running costs		
England & Wales	EU Directive 2002/91/EC 