

Monksmead, Borehamwood

£550,000 (Freehold)



Superbly positioned for YAVNEH COLLEGE on the south side of Borehamwood and less than a mile from ELSTREE & BOREHAMWOOD STATION and shopping area is this well positioned semi-detached home.

This good sized property offers 1132 sq ft of living accommodation with an entrance porch, hallway, good size lounge, kitchen, dining room and conservatory to the ground floor. The first floor boasts 2 double bedrooms, a good size 3rd bedroom as well as a family bathroom. Externally there is a mature rear garden with storage building and of street parking for at least 2 cars. The property benefits from extension potential subject to the necessary consents.

020 3764 2222
www.village-estates.co.uk



Village Estates
The Corner Shop High Street, Elstree
Herts WD6 3BY

Important Note: These particulars do not form part of any contract. All measurements are approximate and should not be relied upon. All prices quoted are strictly subject to contract.







Approx Gross Internal Area
105 sq m / 1132 sq ft

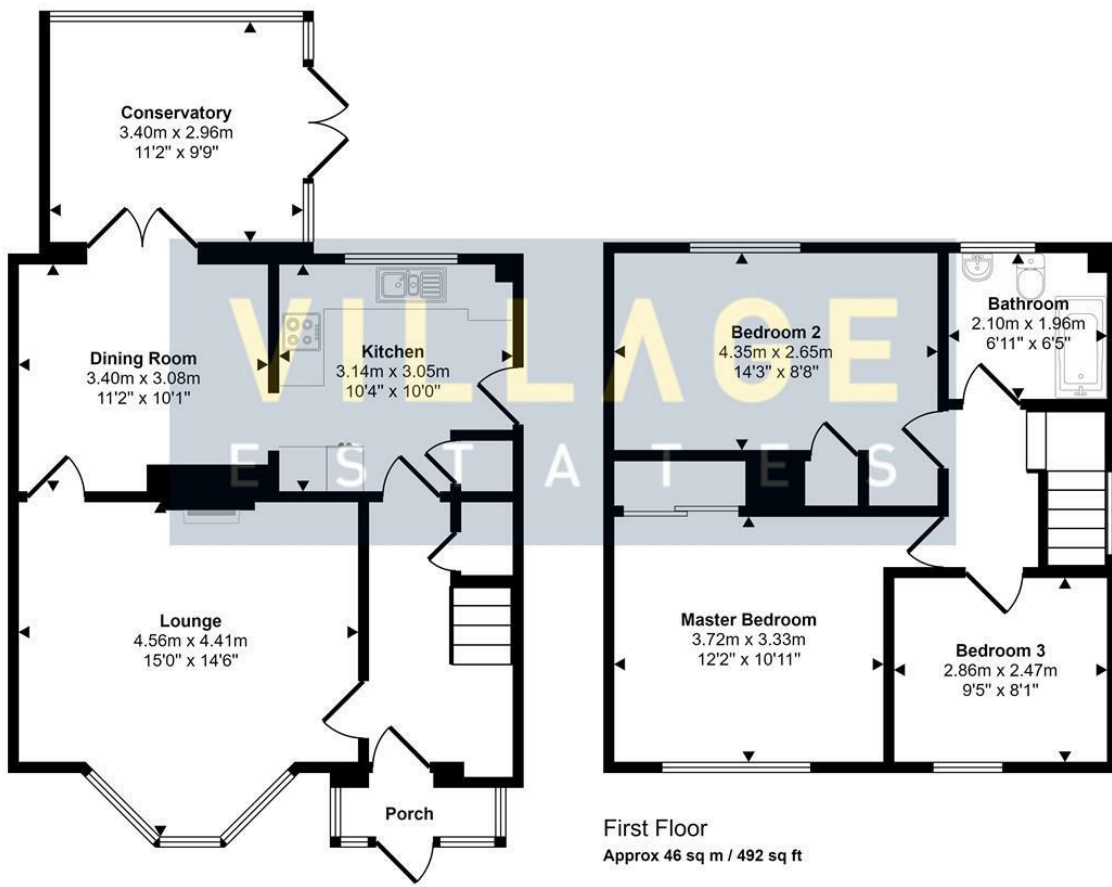

This floorplan is only for illustrative purposes and is not to scale. Measurements of rooms, doors, windows, and any items are approximate and no responsibility is taken for any error, omission or mis-statement. Icons of items such as bathroom suites are representations only and may not look like the real items. Made with Made Snappy 360.



Available on the
App Store



ANDROID APP ON
Google play

Energy Efficiency Rating		Current	Potential
Very energy efficient - lower running costs			
(92 plus)	A		
(61-91)	B		
(69-80)	C		
(55-68)	D		
(39-54)	E		
(21-38)	F		
(1-20)	G		
Not energy efficient - higher running costs			
England & Wales		EU Directive 2002/91/EC	