

Arundel Drive, Borehamwood

£1,650 Per Month ()



Available NOW!! This stunning modern two DOUBLE bedroom, two bathroom first floor flat is situated on the south side of Borehamwood. The property boasts a large en-suite bedroom with fitted wardrobes, a second double bedroom with fitted wardrobes, family bathroom, beautifully appointed kitchen complete with washer/dryer, fridge/freezer, electric oven & Hob, dishwasher and a very large open-plan living area.

The apartments location provides easy access to local amenities, schools, and transport links, making it ideal for those seeking both comfort and convenience.

This stunning apartment also comes with allocated parking for one car.

Combined salary for this property is £52,500

020 3764 2222
www.village-estates.co.uk



Village Estates
The Corner Shop High Street, Elstree
Herts WD6 3BY

Important Note: These particulars do not form part of any contract. All measurements are approximate and should not be relied upon. All prices quoted are strictly subject to contract.





676 sq.ft. (62.8 sq.m.) approx.

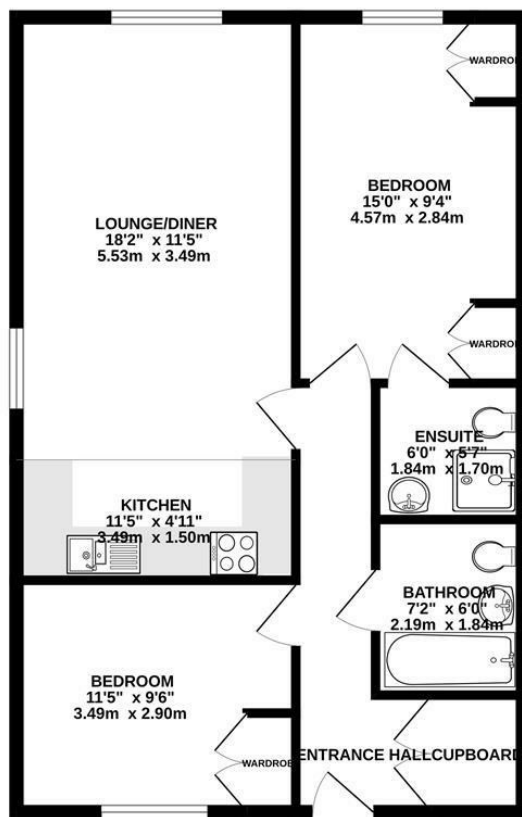

TOTAL FLOOR AREA : 676 sq.ft. (62.8 sq.m.) approx.

Whilst every attempt has been made to ensure the accuracy of the floorplan contained here, measurements of doors, windows, rooms and any other items are approximate and no responsibility is taken for any error, omission or mis-statement. This plan is for illustrative purposes only and should be used as such by any prospective purchaser. The services, systems and appliances shown have not been tested and no guarantee as to their operability or efficiency can be given.
Made with Metropix ©2024

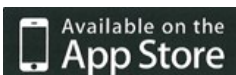

Energy Efficiency Rating		Current	Potential
Very energy efficient - lower running costs			
(92 plus) A			
(81-91) B		82	85
(69-80) C			
(55-68) D			
(39-54) E			
(21-38) F			
(1-20) G			
Not energy efficient - higher running costs			
England & Wales		EU Directive 2002/91/EC	