

**Grantham Green, Borehamwood**

**£547,500 (Freehold)**

**VILLAGE**  
E S T A T E S



Welcome to this charming end terrace house located in the sought-after Grantham Green, Borehamwood. This delightful property boasts four spacious double bedrooms and two bathrooms, providing ample space for a growing family or those who enjoy having guests over.

With a generous 1,330 sq ft of living space, this house offers plenty of room for comfortable living. The loft extension adds a unique touch to the property, providing additional space that can be utilised in various ways to suit your needs. There is added potential to extend to the rear subject to the usual consents.

Situated on the south side of Borehamwood, this home is conveniently located near excellent schools, making it an ideal choice for families with children. Additionally, the property is close to good road links, local shops, and just 1.3 miles away from the train station, offering easy access to transportation for commuters.

**020 3764 2222**  
[www.village-estates.co.uk](http://www.village-estates.co.uk)



Village Estates  
The Corner Shop High Street, Elstree  
Herts WD6 3BY

Important Note: These particulars do not form part of any contract. All measurements are approximate and should not be relied upon. All prices quoted are strictly subject to contract.







Approx Gross Internal Area  
124 sq m / 1330 sq ft

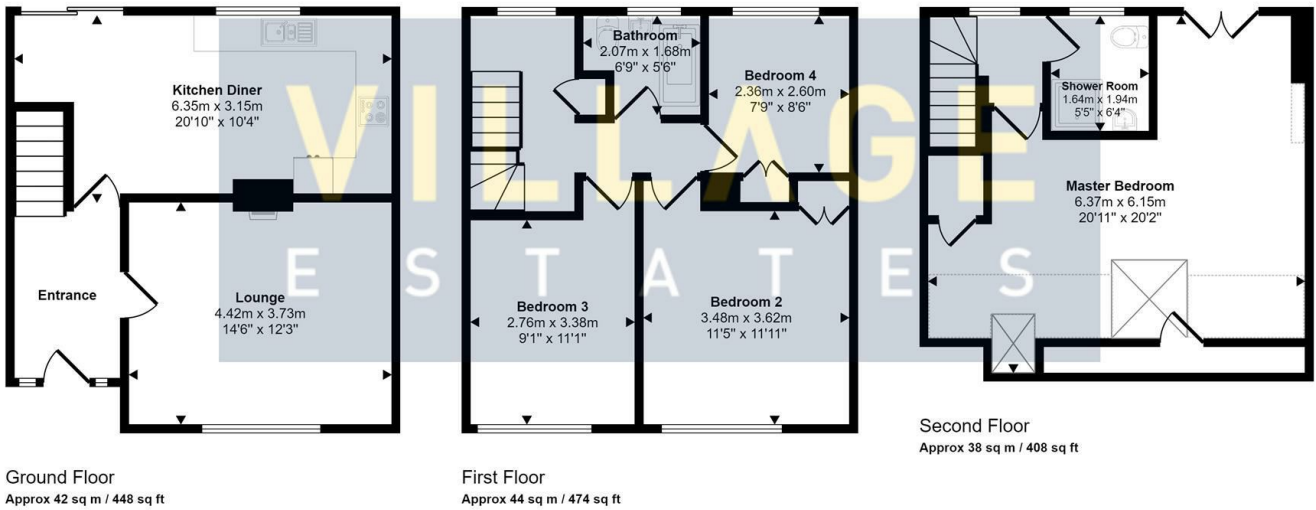

This floorplan is only for illustrative purposes and is not to scale. Measurements of rooms, doors, windows, and any items are approximate and no responsibility is taken for any error, omission or mis-statement. Icons of items such as bathroom suites are representations only and may not look like the real items. Made with Made Snappy 360.



Available on the  
**App Store**



ANDROID APP ON  
**Google play**

Energy Efficiency Rating		Current	Potential
Very energy efficient - lower running costs			
(92 plus) <b>A</b>			
(81-91) <b>B</b>			
(69-80) <b>C</b>			
(55-68) <b>D</b>			
(39-54) <b>E</b>			
(21-38) <b>F</b>			
(1-20) <b>G</b>			
Not energy efficient - higher running costs			
<b>England &amp; Wales</b>		EU Directive 2002/91/EC	