

**Cranes Way, Borehamwood**

**£585,000 (Freehold)**

**VILLAGE**  
E S T A T E S



This charming semi-detached family residence boasting three bedrooms and two reception rooms is situated on the desirable south side of Borehamwood, offering convenient access to local amenities and shops. Meticulously maintained, this property is just a mile away from Elstree & Borehamwood train station and the vibrant high street of Borehamwood.

Spanning 1033 sq ft, the accommodation comprises a welcoming porch, extended lounge, dining room, modern kitchen, and a convenient downstairs WC. Upstairs, three bedrooms and a family shower room provide comfortable living spaces.

Externally, the property features a generously sized driveway capable of accommodating up to four vehicles. Additionally, there is side access leading to the expansive 76ft rear garden, complete with a patio area, meticulously manicured lawn, decking area, summer house, and shed, offering ample space for outdoor enjoyment and entertaining.

**020 3764 2222**  
[www.village-estates.co.uk](http://www.village-estates.co.uk)



Village Estates  
The Corner Shop High Street, Elstree  
Herts WD6 3BY

Important Note: These particulars do not form part of any contract. All measurements are approximate and should not be relied upon. All prices quoted are strictly subject to contract.







Approx Gross Internal Area  
96 sq m / 1033 sq ft

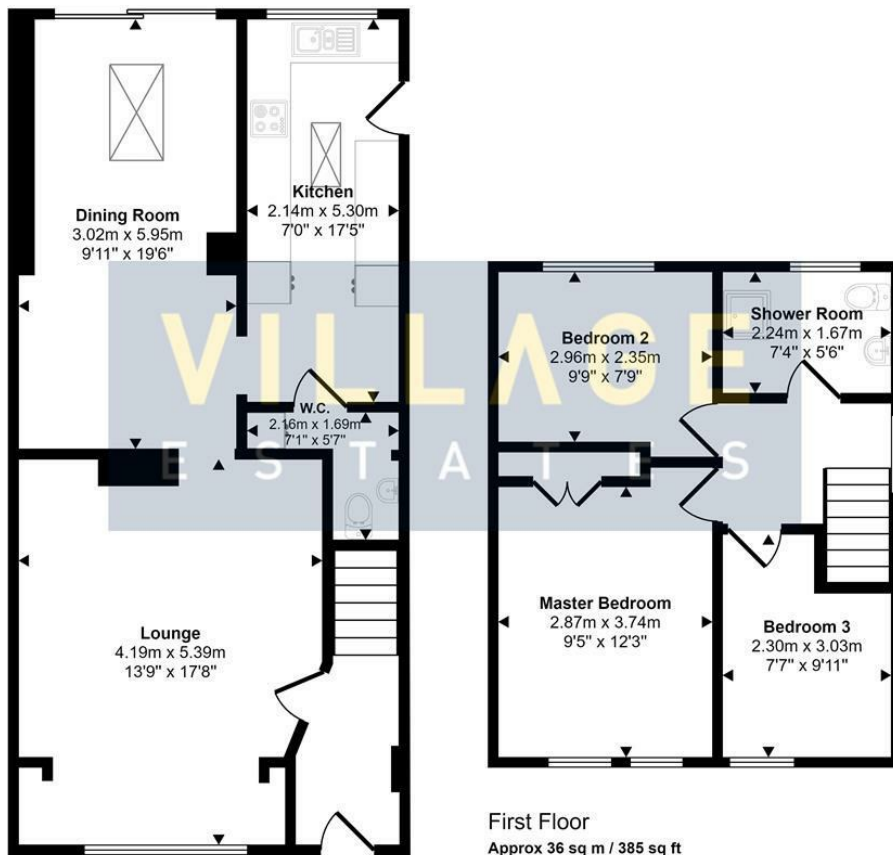

Ground Floor  
Approx 60 sq m / 648 sq ft

First Floor  
Approx 36 sq m / 385 sq ft

This floorplan is only for illustrative purposes and is not to scale. Measurements of rooms, doors, windows, and any items are approximate and no responsibility is taken for any error, omission or mis-statement. Icons of items such as bathroom suites are representations only and may not look like the real items. Made with Made Snappy 360.



Available on the  
**App Store**



ANDROID APP ON  
**Google play**

Energy Efficiency Rating		Current	Potential
Very energy efficient - lower running costs			
(92 plus) <b>A</b>			
(61-91) <b>B</b>			
(69-80) <b>C</b>			
(55-68) <b>D</b>			
(39-54) <b>E</b>			
(21-38) <b>F</b>			
(1-20) <b>G</b>			
Not energy efficient - higher running costs			
<b>England &amp; Wales</b>		EU Directive 2002/91/EC	