

Coates Road, Borehamwood

£2,200 PCM ()

VILLAGE
E S T A T E S



This 3 bedroom semi detached family home is located in the heart of Elstree Village, close to local shops and well placed for bus routes into Edgware/Stammore and Borehamwood. Equal distance to Borehamwood and Elstree mainline station and Stanmore tube station as well as being close to major road links including A1, A41 and M1. Internally the property includes:- A front porch, an inviting entrance hall, lounge/dining room, Kitchen, W/C master bedroom with fitted wardrobes, second double bedroom with fitted wardrobes and third single bedroom with fitted storage and family bathroom. Externally there is a good sized rear garden with patio and brick built sheds, whilst to the front there is a parking for several cars.

Available Mid May!!

No pets

020 3764 2222
www.village-estates.co.uk



Village Estates
The Corner Shop High Street, Elstree
Herts WD6 3BY

Important Note: These particulars do not form part of any contract. All measurements are approximate and should not be relied upon. All prices quoted are strictly subject to contract.





GROUND FLOOR

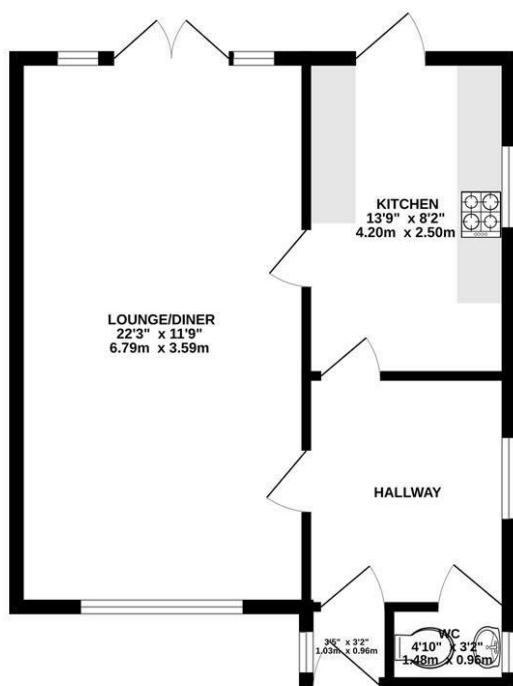

1ST FLOOR

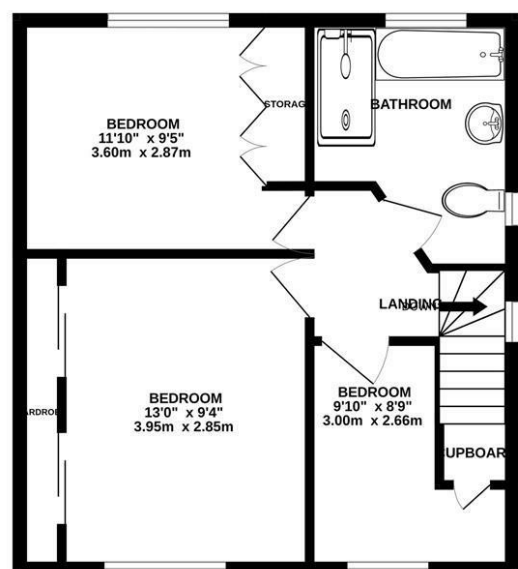

TOTAL FLOOR AREA : 980sq.ft. (91.0 sq.m.) approx.

Whilst every attempt has been made to ensure the accuracy of the floorplan contained here, measurements of doors, windows, rooms and any other items are approximate and no responsibility is taken for any error, omission or mis-statement. This plan is for illustrative purposes only and should be used as such by any prospective purchaser. The services, systems and appliances shown have not been tested and no guarantee as to their operability or efficiency can be given.
Made with Metropix ©2023



Energy Efficiency Rating		
	Current	Potential
Very energy efficient - lower running costs		
(92 plus) A		
(81-91) B		
(69-80) C		
(55-68) D		
(39-54) E		
(21-38) F		
(1-20) G		
Not energy efficient - higher running costs		
England & Wales		
EU Directive 2002/91/EC		