



549 Wandsworth Road

£600 Per Week

Set within a private residential development, this bright and well-proportioned apartment offers two double bedrooms, one ensuite shower room, a family bathroom and a private balcony, creating an inviting and practical living space.

The property features a separate, well-equipped kitchen with integrated appliances, a generous reception room, wood flooring, double glazing and calm, neutral interiors throughout.

Conveniently located moments from Wandsworth Road Overground Station—with direct links to Clapham Junction and Canary Wharf—the apartment is also within easy reach of the vibrant cafés, restaurants and bars of Clapham Old Town.

Council Tax Band: Lambeth D
Minimum contract: 12 months
Change of contract fee: £50 including VAT
Lift access | Cladding: EWS1 Certificate available
Holding Deposit - £600 (1 weeks rent, subject to agreed offer)

Electricity supply – Mains | Cold Water supply – Mains | Sewerage – Mains | Central Heating Gas – Communal | Internet: FttP

To check broadband and mobile phone coverage please visit Ofcom.
To check planning permission please visit Wandsworth Council Website, Planning & Building Control

549 Wandsworth Road



- Two double bedrooms
- Private balcony
- 2nd floor
- Wood Floors & Double Glazing
- Private Residential Development
- Excellent transport links
- Available now

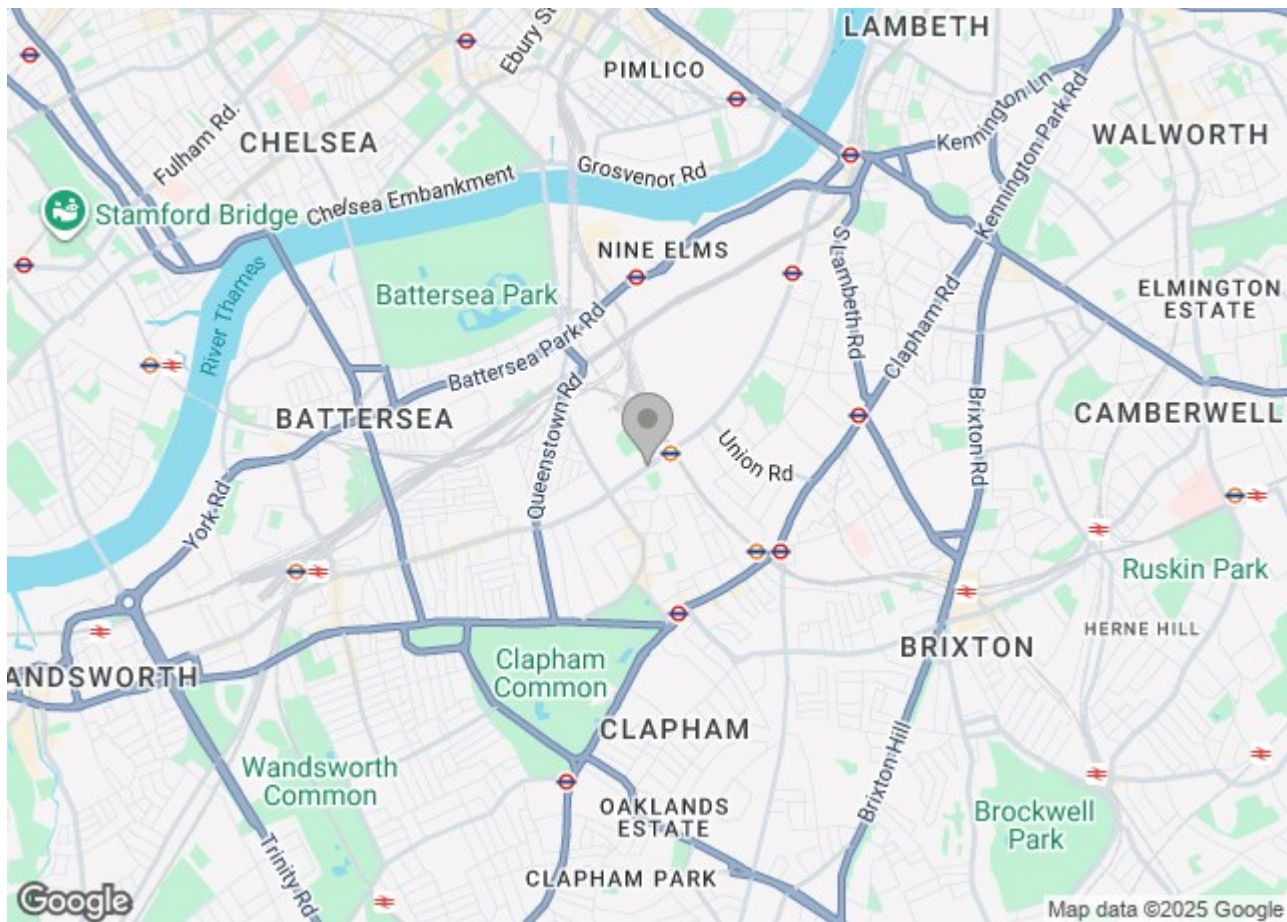

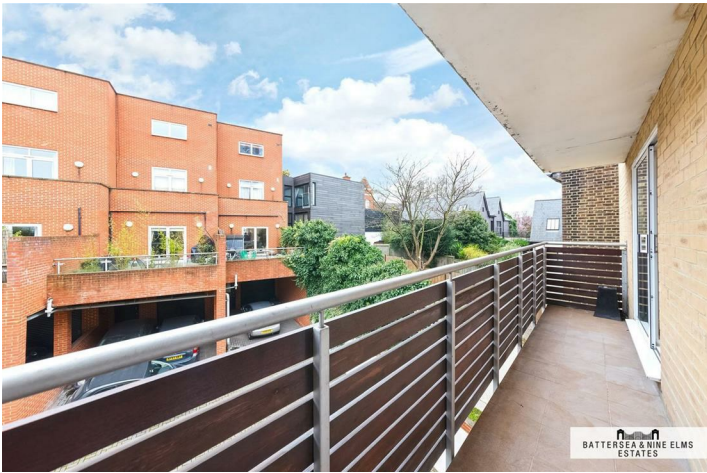

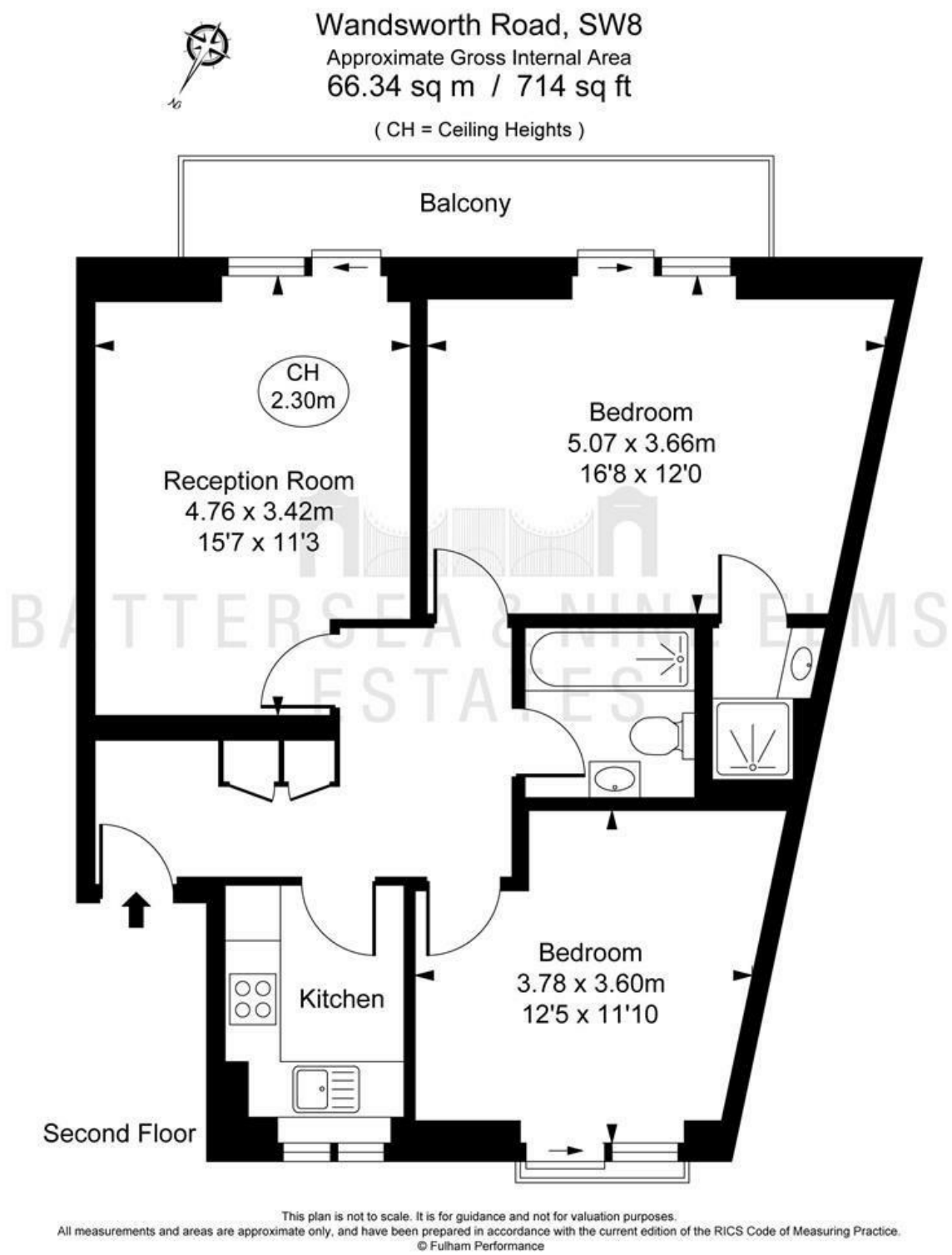

These particulars, whilst believed to be accurate are set out as a general outline only for guidance and do not constitute any part of an offer or contract. Intending purchasers should not rely on them as statements of representation of fact, but must satisfy themselves by inspection or otherwise as to their accuracy. No person in this firm's employment has the authority to make or give any representation or warranty in respect of the property.

