

23 Circus Road West London

£750 Per Week

This beautiful apartment has been finished to a high standard and the neutral decor is enhanced by the abundance of natural light which falls through the floor to ceiling windows which span the length of the property.

In an aim to offer the epitome of city living the development boasts a selection of vibrant shops, restaurants and leisure spaces all on the doorstep of its residents. Scott House is located in the West phase of the complex ideally situated for the River Thames, Chelsea, Battersea Park and local tube and rail stations.

Council Tax Band: Wandsworth - E
Minimum contract: 12 months
Change of contract fee: £50 including VAT
Lift access | Cladding: EWS1 Certificate available
Holding Deposit - £750 (1 weeks rent, subject to agreed offer)

Electricity supply – Mains | Cold Water supply – Mains | Sewerage – Mains | Hot water, heating & comfort cooling – Communal | Internet: FttP

23 Circus Road West London



- One double bedroom
- Gym and Pool
- Residents lounge & bar
- Finished to a high standard
- Iconic riverside development
- Photos of bedroom are CGI
- Winter garden
- 24 Hour concierge

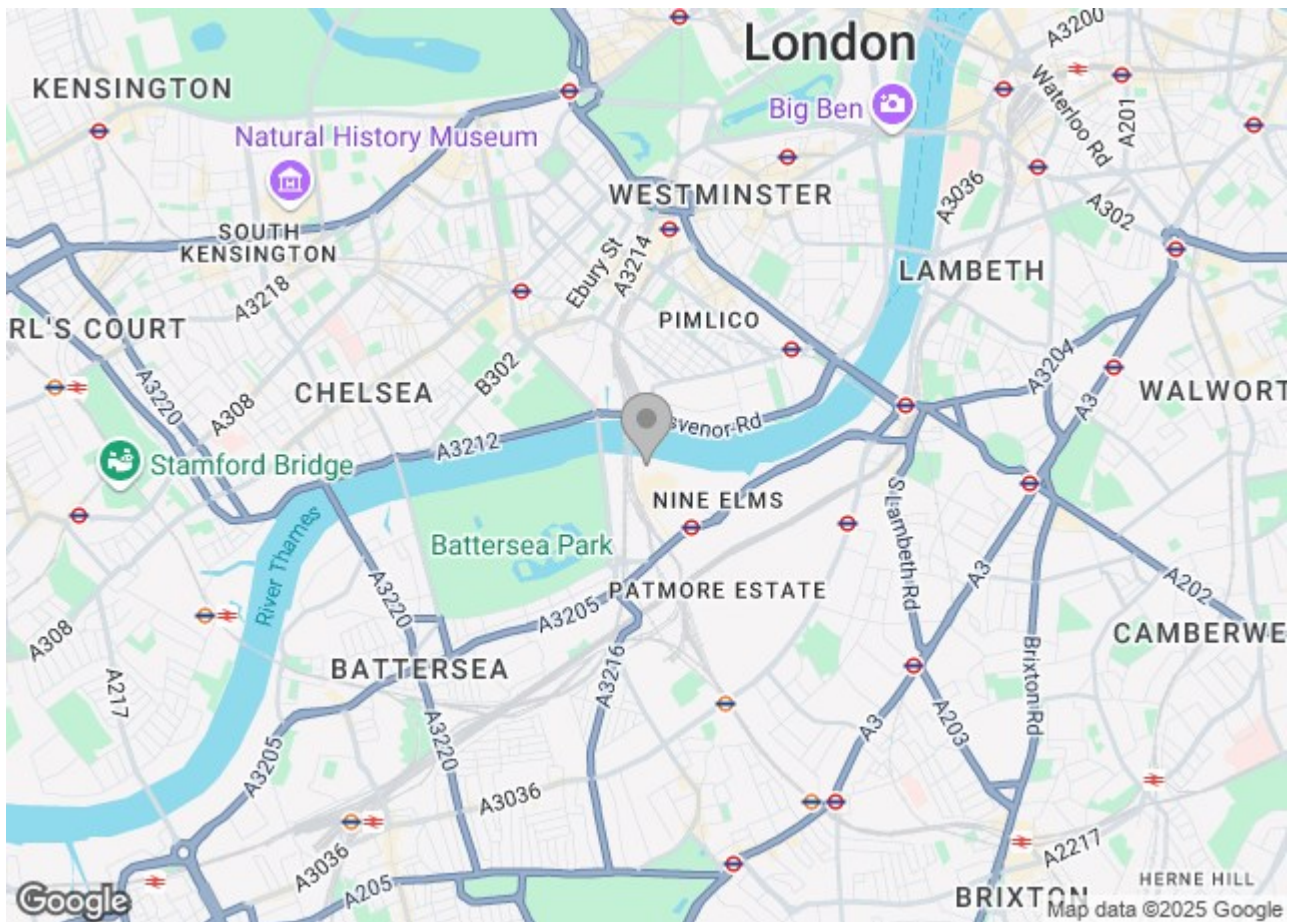

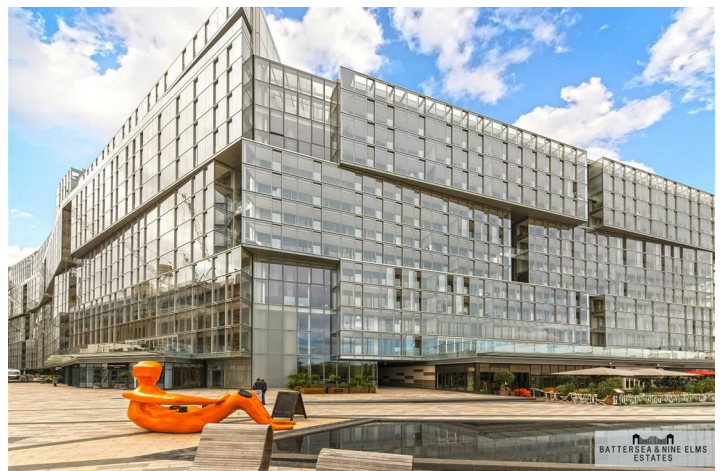
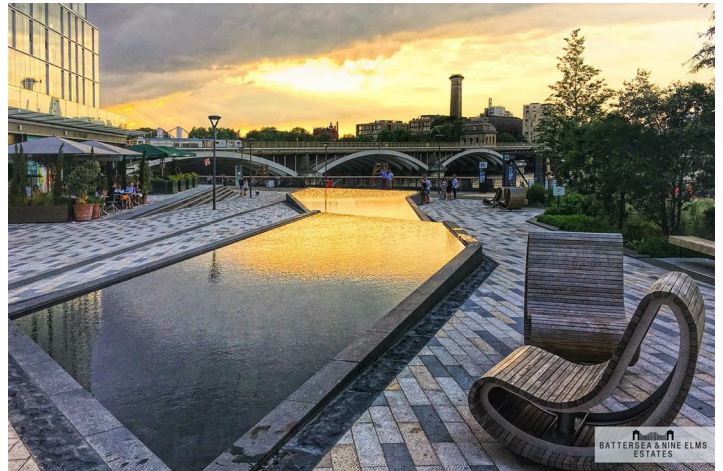
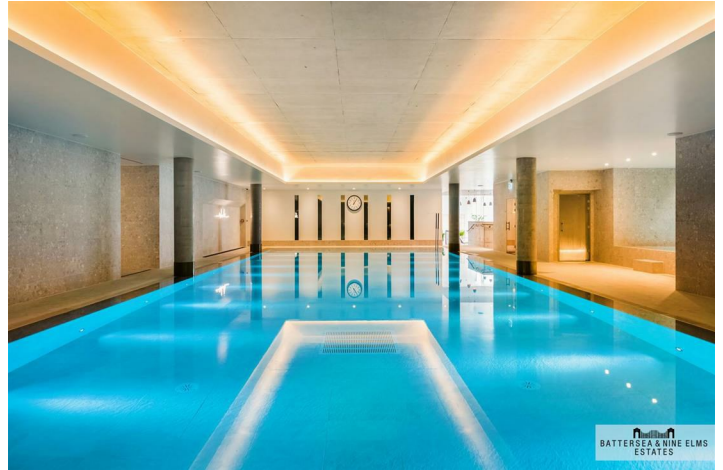

Floor Plan



Scott House,
Battersea Power Station,
Approximate Gross Internal Area
55.90 sq m / 602 sq ft
Winter arden
10.70 sq m / 115 sq ft

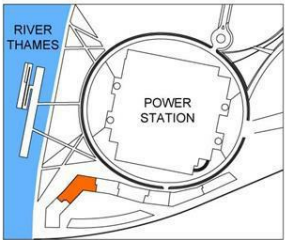

This plan is not to scale. It is for guidance and not for valuation purposes.
All measurements and areas are approximate only, and have been prepared in accordance with the current edition of the RICS Code of Measuring Practice.
© Fulham Performance

These particulars, whilst believed to be accurate are set out as a general outline only for guidance and do not constitute any part of an offer or contract. Intending purchasers should not rely on them as statements of representation of fact, but must satisfy themselves by inspection or otherwise as to their accuracy. No person in this firms employment has the authority to make or give any representation or warranty in respect of the property.

