

30 Ponton Road London

A wonderful two bedroom apartment situated in the popular The Residence development featuring an open plan kitchen and living space with a winter garden. Finished to the highest standard apartments include AEG fully integrated appliances including washer/dryer, oven and microwave as well as underfloor heating throughout.

Residents will also benefit from the wonderful onsite amenities including the gym, yoga room, private cinema and meeting rooms as well as its central location close to zone one transport links including Vauxhall and Nine Elms stations.

Council tax band : Wandsworth Council - F

£825 Per Week

30 Ponton Road London



- Two double bedrooms
- Two bathrooms (one en suite)
- Private balcony
- Gym
- Private cinema
- Excellent transport links

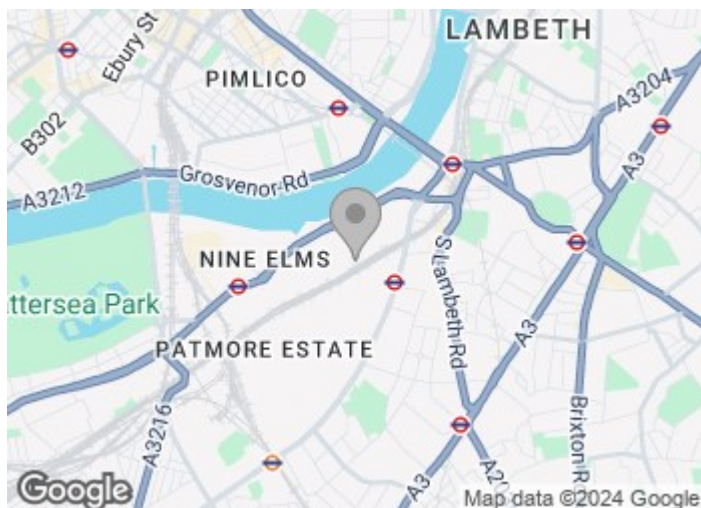

[Directions](#)

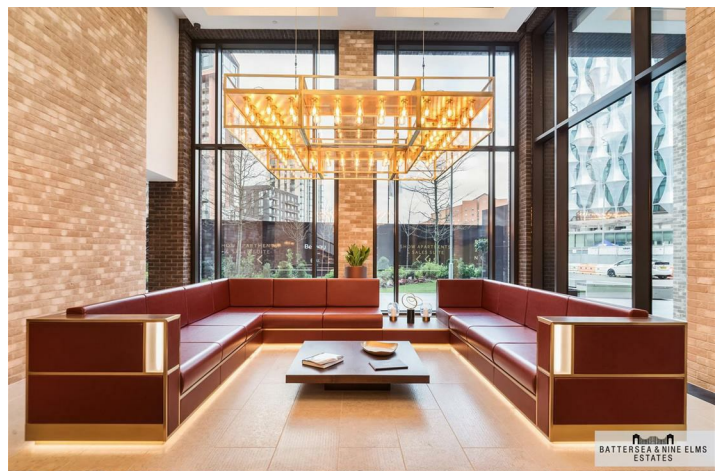

Madeira Tower,
The Residence,
Ponton Road, SW8
Approximate Gross Internal Area
70.90 sq m / 763 sq ft

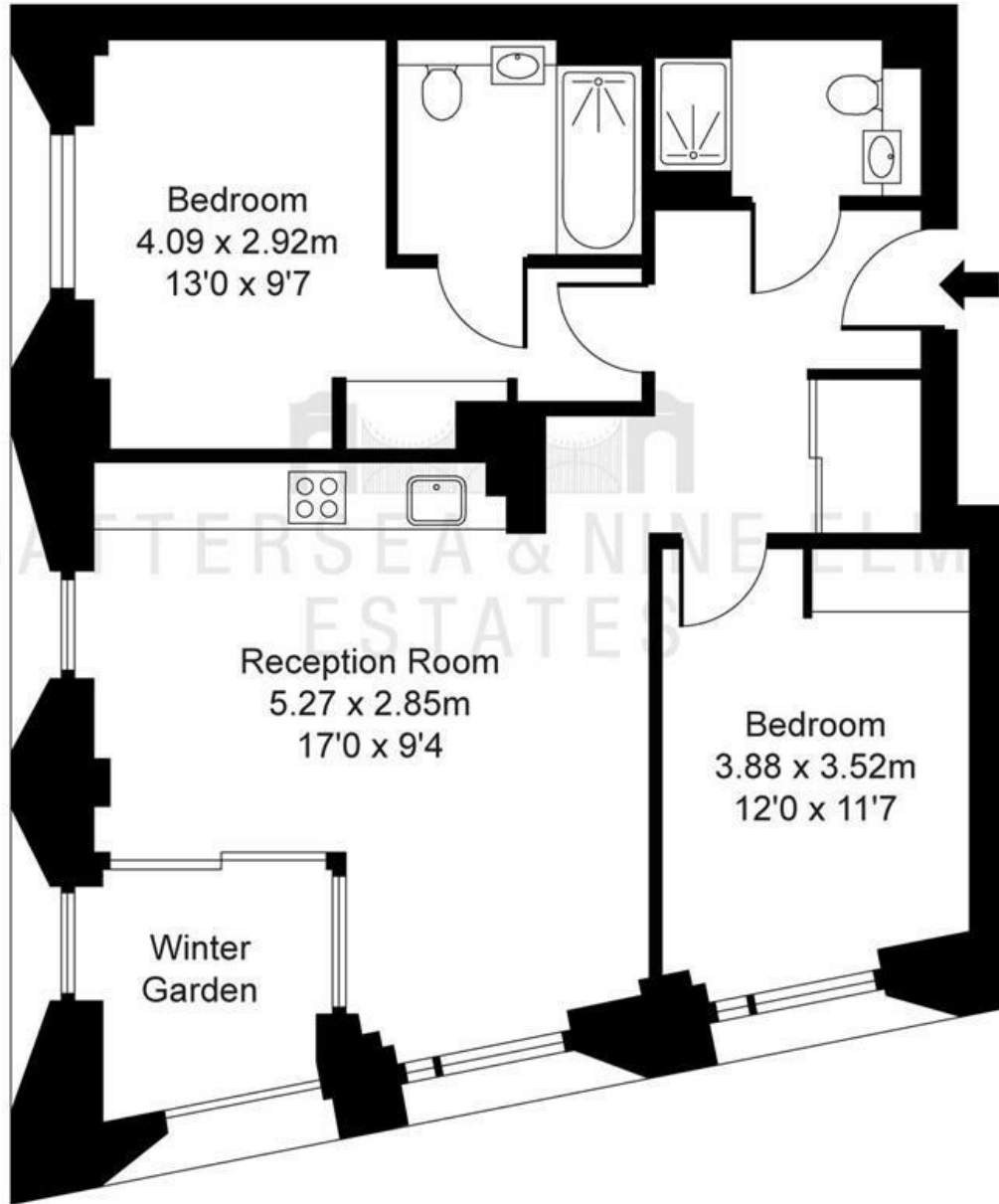

ILLUSTRATION FOR IDENTIFICATION PURPOSES ONLY
ALL MEASUREMENTS AND AREA FIGURES SUPPLIED BY OTHERS, ACCURACY IS NOT GUARANTEED.
THIS PLAN MUST NOT BE REPRODUCED BY ANY OTHER PERSON WITHOUT PERMISSION

These particulars, whilst believed to be accurate are set out as a general outline only for guidance and do not constitute any part of an offer or contract. Intending purchasers should not rely on them as statements of representation of fact, but must satisfy themselves by inspection or otherwise as to their accuracy. No person in this firm's employment has the authority to make or give any representation or warranty in respect of the property.

Energy Efficiency Rating		Environmental Impact (CO ₂) Rating		
	Current	Potential		
	86	86		92
<small>Very energy efficient - lower running costs</small> <small>(82 plus)</small> A <small>(61-81)</small> B <small>(69-80)</small> C <small>(55-68)</small> D <small>(39-54)</small> E <small>(21-38)</small> F <small>(1-20)</small> G <small>Not energy efficient - higher running costs</small>			<small>Very environmentally friendly - lower CO₂ emissions</small> <small>(92 plus)</small> A <small>(81-91)</small> B <small>(69-80)</small> C <small>(55-68)</small> D <small>(39-54)</small> E <small>(21-38)</small> F <small>(1-20)</small> G <small>Not environmentally friendly - higher CO₂ emissions</small>	
England & Wales	EU Directive 2002/91/EC		England & Wales	EU Directive 2002/91/EC