

THREE BEDROOMS

TWO BATHROOMS

BALCONY

DUAL ASPECT

EIGHTH FLOOR

A brand new 3 bedroom, 2 bathroom, 8th floor apartment with a balcony in Deptford Landings SE8, a new development in Deptford. The property features underfloor heating, wood flooring and dual aspect views. With secure cycle storage and landscaped communal courtyard gardens. Just 0.7 miles from Deptford Rail and Surrey Quays Stations, serviced by Thameslink, Southeastern and Overground lines.

£752,500 (Leasehold)



**KINGWOOD APARTMENTS, DEPTFORD
LANDINGS, DEPTFORD SE8**

£752,500 (Leasehold)



KINGWOOD APARTMENTS, DEPTFORD LANDINGS, DEPTFORD SE8

£752,500 (Leasehold)

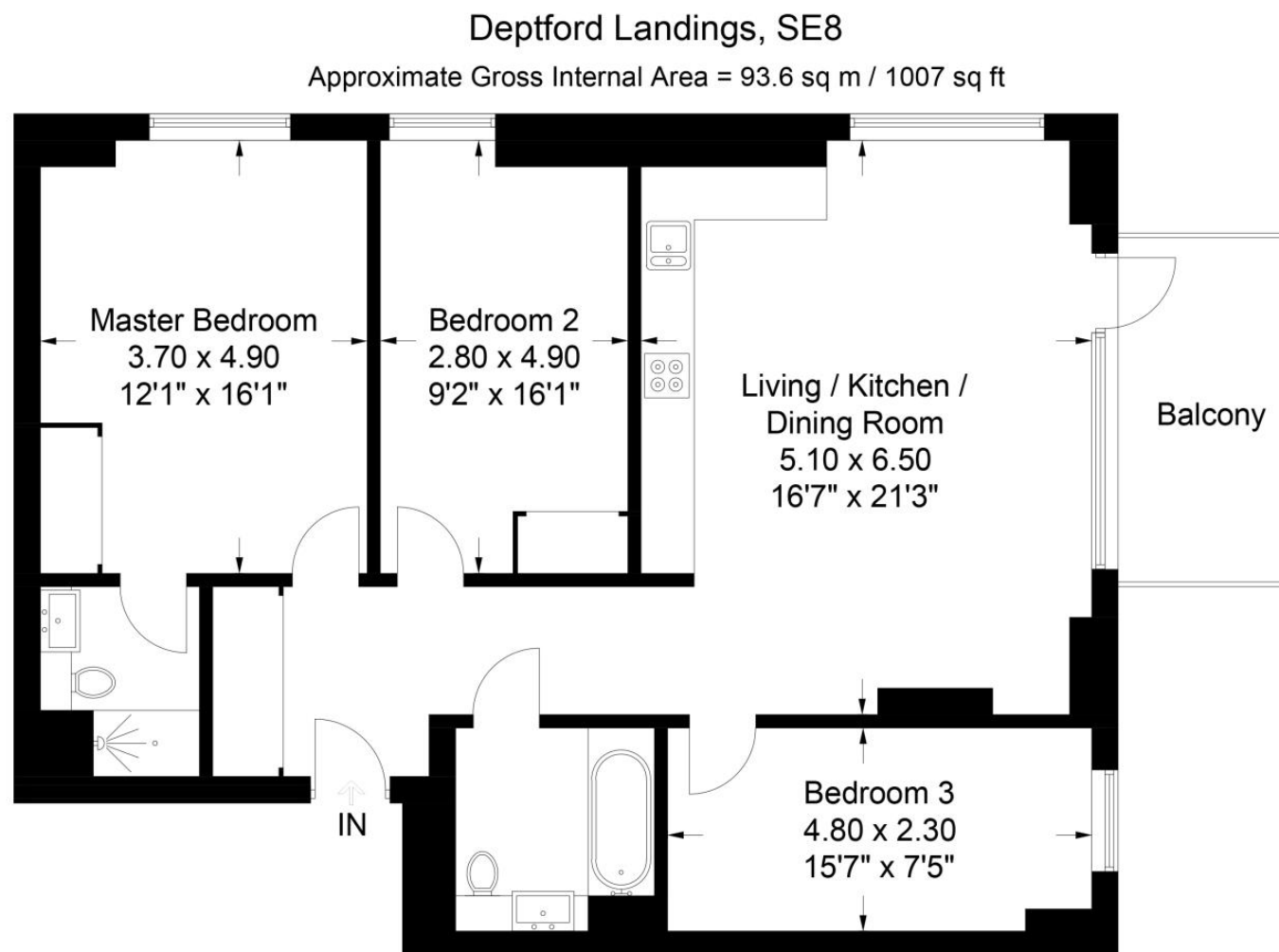

Chase Evans makes every attempt to ensure accuracy, however all measurements are approximate.
All aspects of this floor plan are for illustrative purposes only and not to scale. Errors and omissions excepted (E&OE).

KINGWOOD APARTMENTS, DEPTFORD LANDINGS, DEPTFORD SE8

£752,500 (Leasehold)

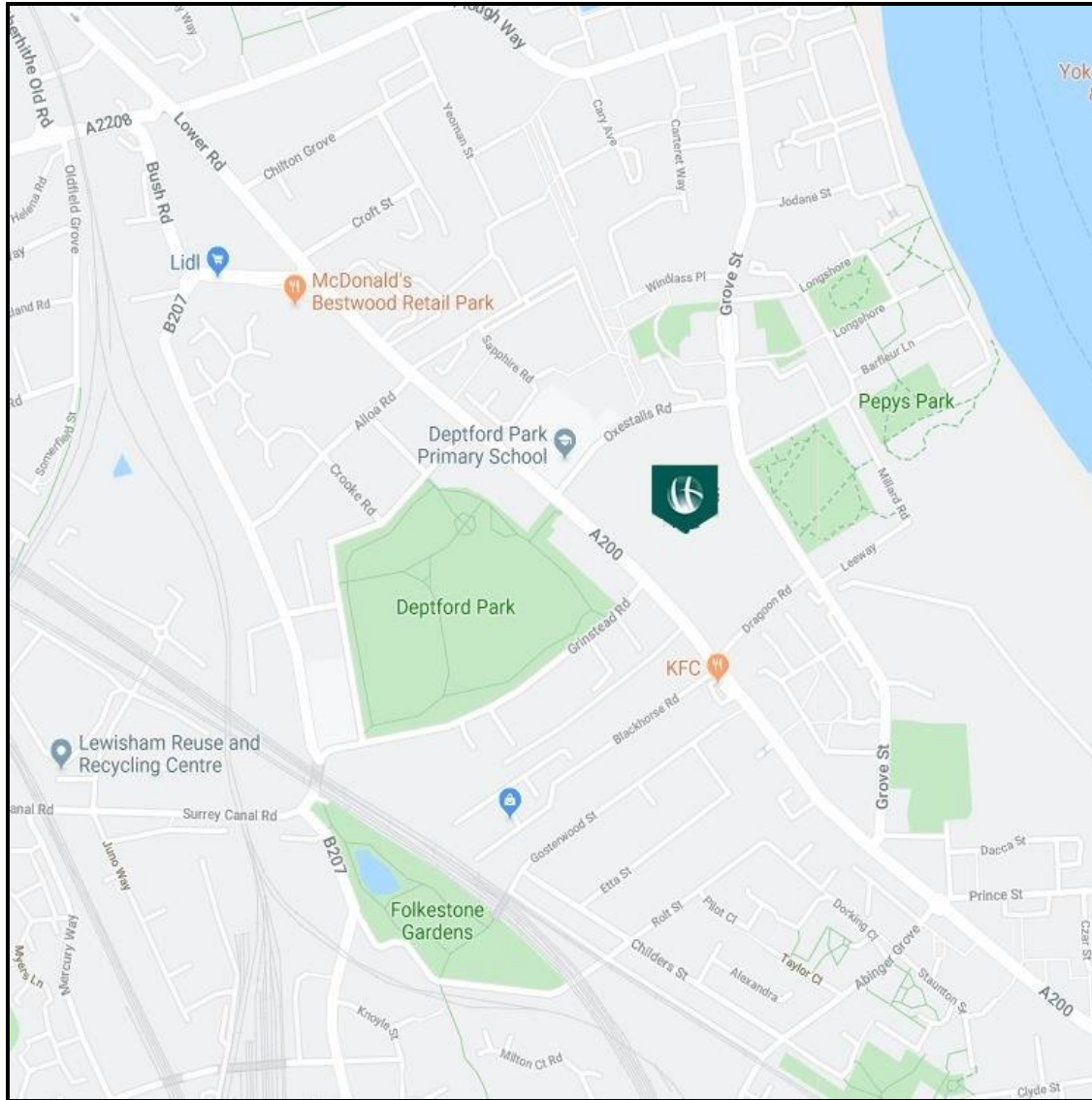

Energy Efficiency Rating		Environmental Impact Rating			
	Current	Potential		Current	Potential
Very energy efficient - lower running costs			Very environmentally friendly - lower CO ₂ emissions		
(92-100) A			(82-100) A	94	94
(81-91) B	86	86	(81-91) B		
(69-80) C			(69-80) C		
(55-68) D			(55-68) D		
(39-54) E			(39-54) E		
(21-38) F			(21-38) F		
(1-20) G			(1-20) G		
Not energy efficient - higher running costs			Not environmentally friendly - higher CO ₂ emissions		
England & Wales	EU Directive 2002/91/EC		England & Wales	EU Directive 2002/91/EC	

The energy efficiency rating is a measure of the overall efficiency of a home. The higher the rating the more energy efficient the home is and the lower the fuel bills will be.

The environmental impact rating is a measure of a home's impact on the environment in terms of carbon dioxide (CO₂) emissions. The higher the rating the less impact it has on the environment.

[View Property](#)

Contact Information:

City Office

122 Whitechapel High Street, London, E1 7PT

Tel: +44 (0)20 7247 3888

Email: city@chaseevans.co.uk