



Kingwood Apartments, Deptford Landings, Waterline Way, Deptford, SE8

Price **£450 per week** | Furnished



Kingwood Apartments, Deptford Landings, Waterline Way, Deptford, SE8



1 Bedroom



1 Bathroom



1 Reception



Balcony



Secure Cycle
Storage



Underground
Parking



Nearby Deptford
Park



Local Restaurants



0.8 MI Deptford

Spacious one bedroom property with a generous balcony and underground parking in an attractive, recently completed Deptford Landings' development. Bright and quiet, offering a stylish open plan/kitchen opening onto the balcony. The bedroom has a generously sized wardrobe space and there is a smart bathroom.

Features include engineered wood flooring, underfloor heating, recessed lighting, integrated kitchen appliances, large glazing in the living room, good storage space with a built-in bedroom wardrobe, and modern bathroom fittings and fixtures.

Facilities include secure cycle storage and landscaped communal gardens. The apartment is a stone's throw from Pepys Park, a short walk from the Thames and the large Deptford Park, and well connected with south London's bicycle network.

Situated just 0.7miles from Deptford Rail and Surrey Quays Stations, which are serviced by Thameslink and Southeastern lines and Overground lines, respectively. South Bermondsey is a little over a mile away for all Southern Line services. Canary Wharf is commutable in under 10mins from Surrey Quays Station.

Local Authority: Lewisham

Council Tax Band: C

EPC: B

Security deposit: equivalent to 5 weeks' rent

Floorplan

549 sq ft | 51.9 sq m

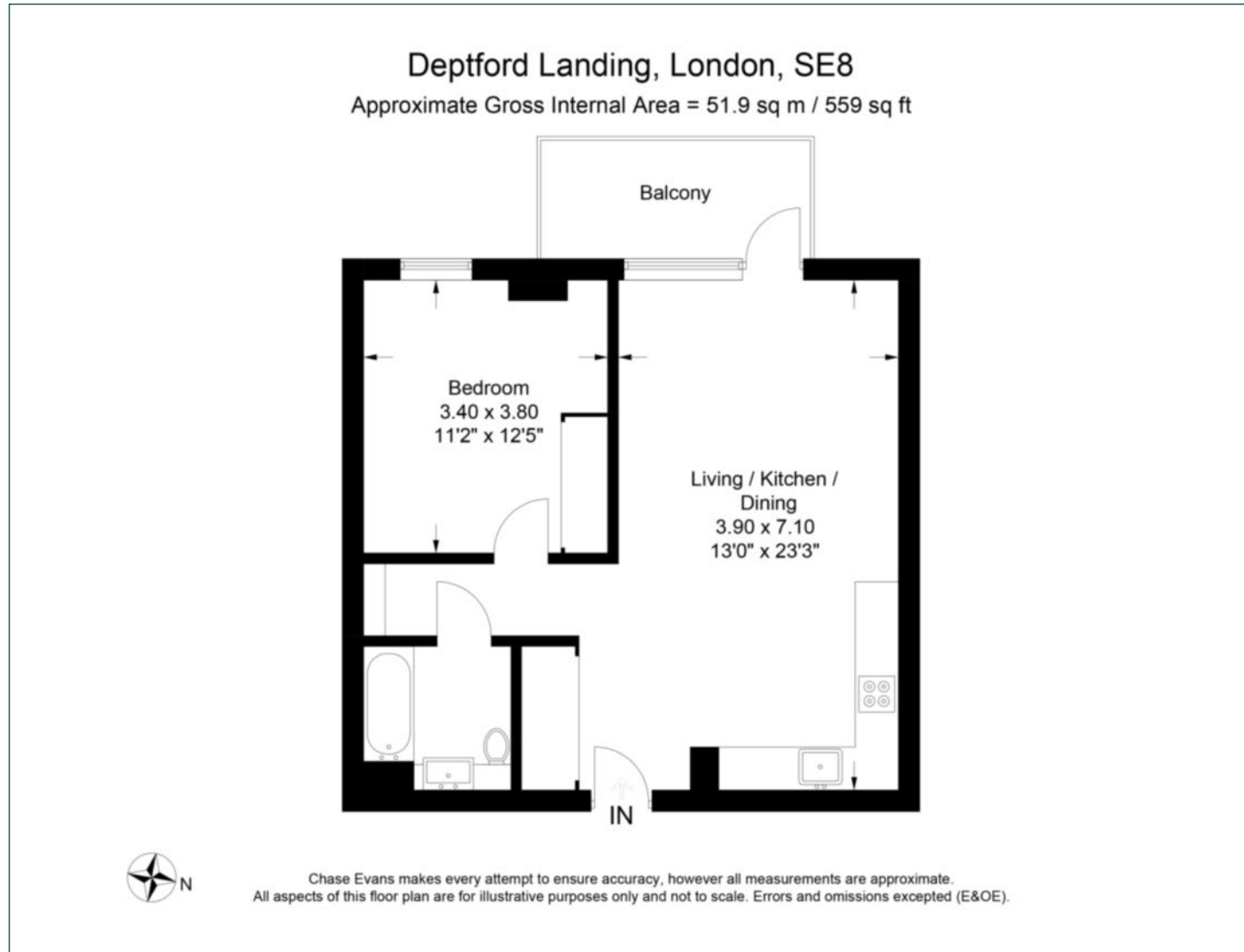

Greenwich

1 Crescent Arcade, 279 Creek Road, London, SE10 9EJ

Lettings

020 8853 8978 | greenwich.sales@chaseevans.co.uk

We're here to help.

IMPORTANT NOTICE - These particulars have been prepared in good faith and they are not intended to constitute part of an offer or contract. We have not performed a structural survey on this property and the services, appliances and specific fittings have not been tested. All photographs, measurements, floor plans and distances referred to are given as a guide and should not be relied upon.

[chaseevans.com](https://www.chaseevans.com)

 Chase Evans