

Merlin Court, Kidbrooke Village, Tizzard Grove, SE3

Price **£508 per week** | Furnished



Merlin Court, Kidbrooke Village, Tizzard Grove, SE3



2 Bedrooms



2 Bathrooms



1 Reception



Balcony



Local Amenities



24-Hour Concierge



0.3 MI Kidbrooke

A two bedroom, two bathroom apartment within Kidbrooke Village; a modern Berkeley development located in the Royal Borough of Greenwich. This designer furnished apartment includes an inviting living space, fully fitted kitchen with integrated appliances, modern bathroom décor and a private balcony.

Residents have access to a 24-hour concierge service and extensive on-site facilities. There are several amenities located nearby including cafés, shops and restaurants. The development is located a short distance from Kidbrooke railway station

providing a valuable transport link for commutes towards Central London and the City.

Local Authority:

Greenwich London

Council Tax Band:

D

EPC:

B

Security deposit:

equivalent to 5 weeks' rent



Floorplan

846 sq ft | 78.6 sq m

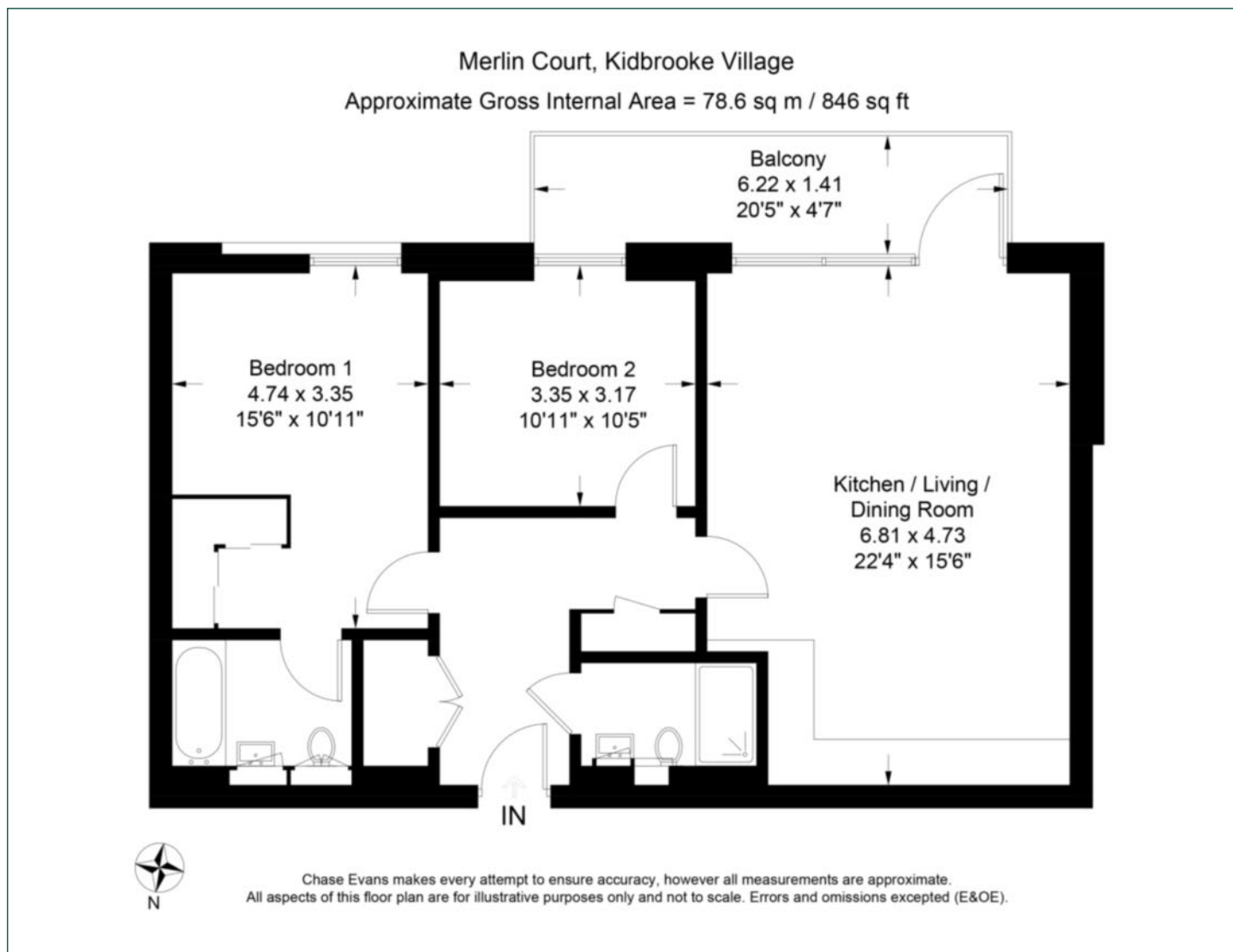

Greenwich

1 Crescent Arcade, 279 Creek Road, London, SE10 9EJ

Lettings

020 8853 8979 | greenwich.lettings@chaseevans.com

We're here to help.

IMPORTANT NOTICE - These particulars have been prepared in good faith and they are not intended to constitute part of an offer or contract. We have not performed a structural survey on this property and the services, appliances and specific fittings have not been tested. All photographs, measurements, floor plans and distances referred to are given as a guide and should not be relied upon.

chaseevans.com