



## Montreal House, Maple Quay, Surrey Quays Road, SE16

Price **£650 per week** | Furnished



# Montreal House, Maple Quay, Surrey Quays Road, SE16



2 Bedrooms



2 Bathrooms



1 Reception



Balcony



Gymnasium



Local Amenities



24-Hour Concierge



0.1 MI Canada Water

Modern two double bedrooms, two bathrooms apartment set within Montreal House, a sought-after development in Maple Quays SE16. The property comprises an open-plan living area with a fully integrated kitchen, access to a spacious private balcony, two bedrooms with ample storage, and two bathrooms (one en suite and one family size).

Residents benefit from concierge and fitness facilities. Ideally located within 0.1 miles to Canada Water tube station, served by Jubilee line and Overground. A short walk to dockside attractions and Surrey Quays Shopping Centre, providing local

supermarkets and an array of cafes, restaurants, and shops.



**Local Authority:**

Southwark Council

**Council Tax Band:**

E

**EPC:**

B

**Security deposit:**

equivalent to 5 weeks' rent

# Floorplan

811 sq ft | 75.30 sq m

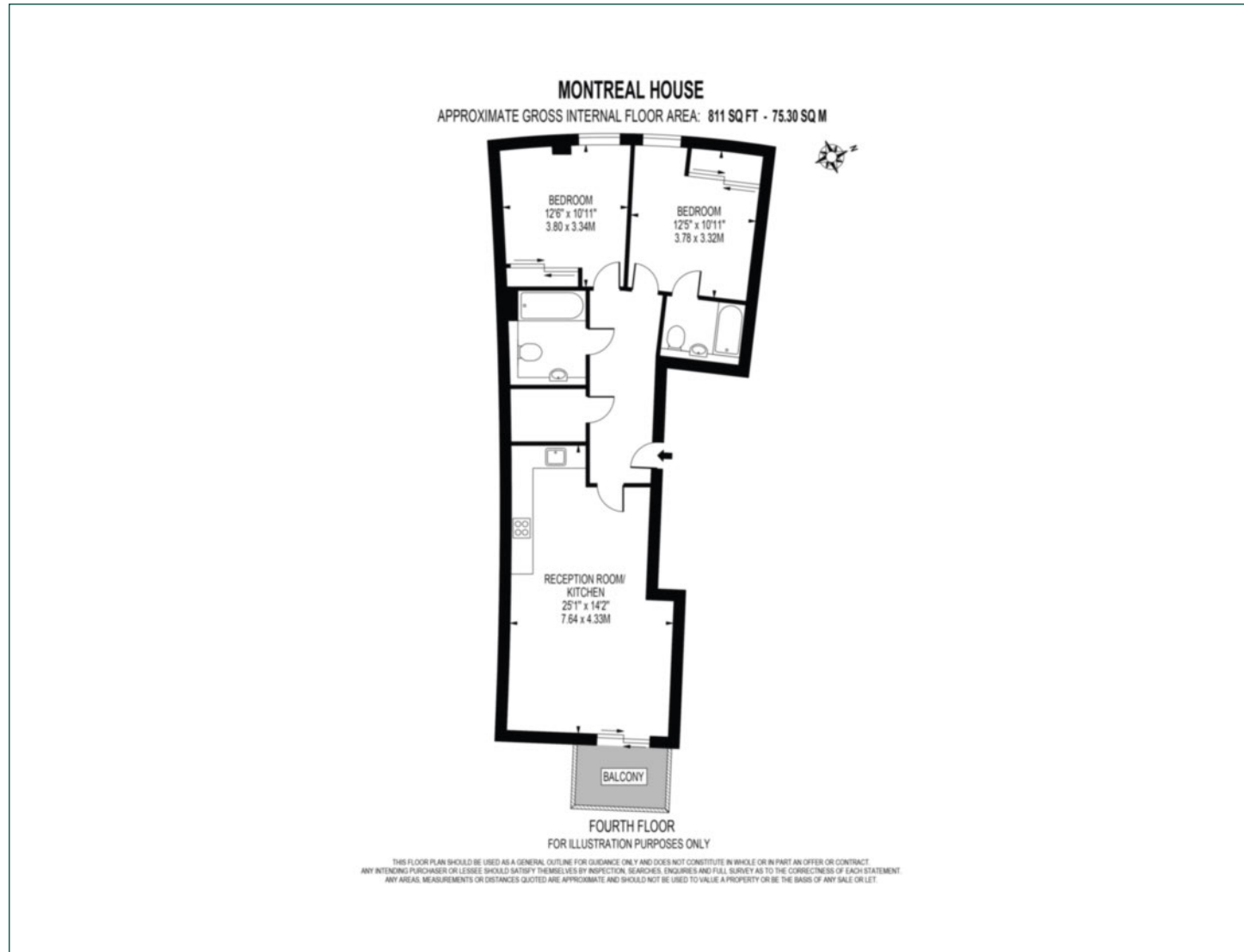

## Greenwich

1 Crescent Arcade, 279 Creek Road, London, SE10 9EJ

## Lettings

020 8853 8979 | [greenwich.lettings@chaseevans.com](mailto:greenwich.lettings@chaseevans.com)

## We're here to help.

IMPORTANT NOTICE - These particulars have been prepared in good faith and they are not intended to constitute part of an offer or contract. We have not performed a structural survey on this property and the services, appliances and specific fittings have not been tested. All photographs, measurements, floor plans and distances referred to are given as a guide and should not be relied upon.

[chaseevans.com](https://www.chaseevans.com)

 Chase Evans