



## Old Fire Station Court, Rotherhithe Street, Rotherhithe, SE16

Price **£438 per week** | Furnished



# Old Fire Station Court, Rotherhithe Street, Rotherhithe, SE16



1 Bedroom



1 Bathroom



1 Reception



Study Room



Riverside Development



Local Amenities



0.8 MI Rotherhithe

A lovely one bedroom and study room apartment set within this converted fire station building in Rotherhithe SE16. This furnished apartment includes an inviting open plan reception room, fitted kitchen with integrated appliances, featuring wood flooring, electric heating, good sized bedroom with fitted bedroom storage and a study room, bright tiled bathroom suite. Hallway storage.

Located on the bank of the river, the Old Fire Station can be found along Rotherhithe Street, offering stunning walks along the Thames path. It is conveniently situated just a short distance from

Canada Water for easy access to the Jubilee line, providing a quick one-stop journey to Canary Wharf. Additionally, the property is only a 25-minute riverside walk away from iconic landmarks such as Tower Bridge, the Tower of London, and historic Shad Thames. For those looking to explore further, Rotherhithe old village is also within walking distance, providing access to the overground for direct travel to Shoreditch or a quick way into Bank and Liverpool Street.

**Local Authority:** Southwark Council

**Council Tax Band:** D

**EPC:** D

**Security deposit:** equivalent to 5 weeks' rent

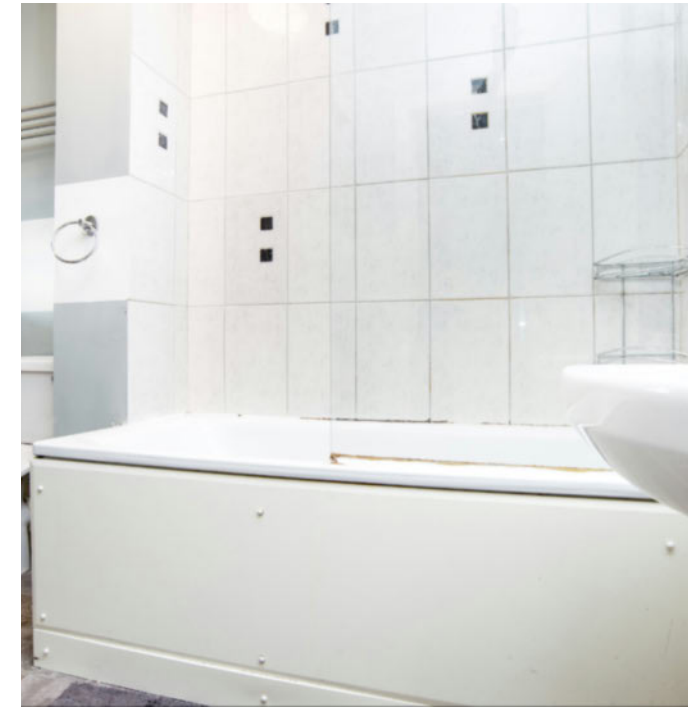

# Floorplan

573 sq ft | 53.23 sq m

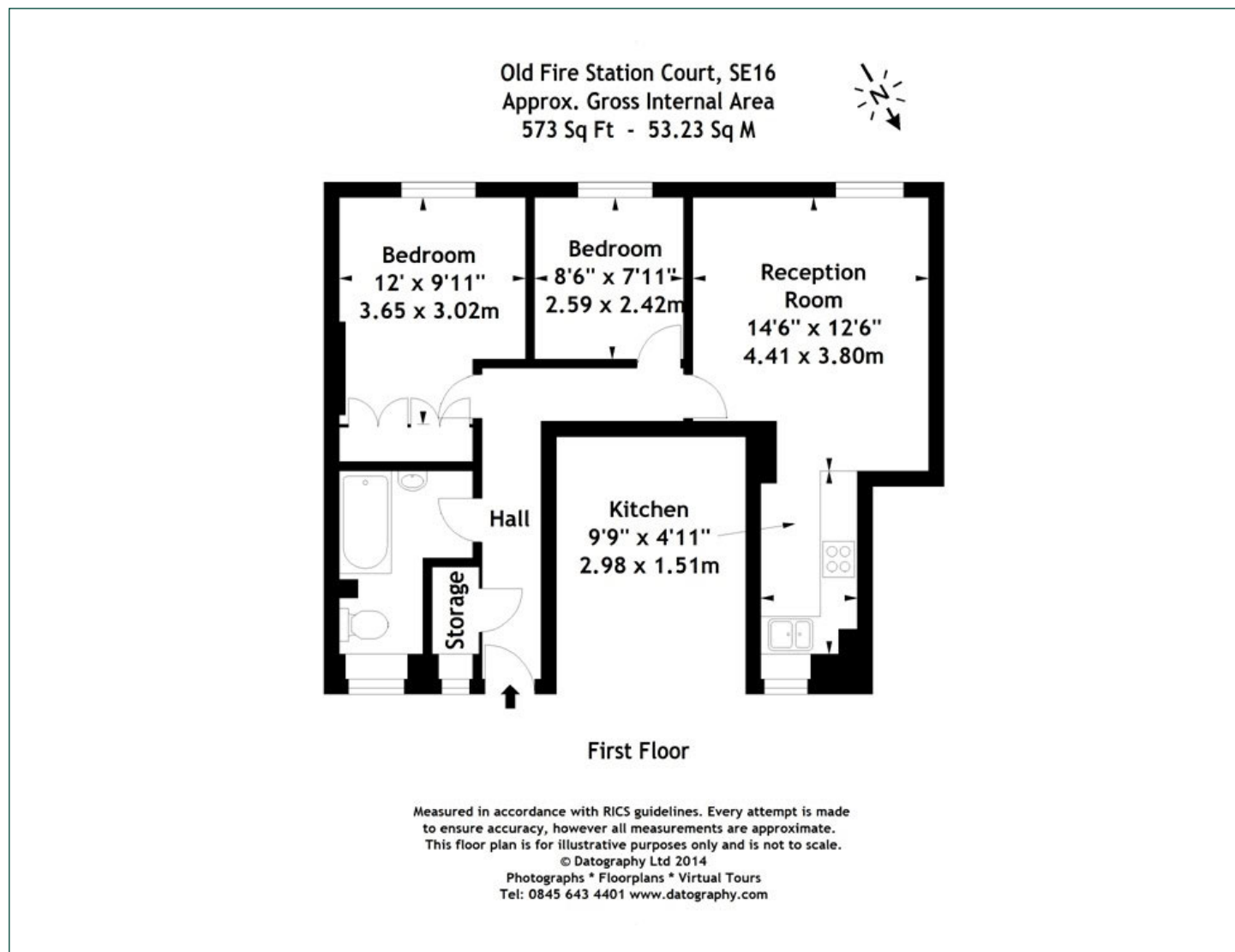

## Greenwich

1 Crescent Arcade, 279 Creek Road, London, SE10 9EJ

## Lettings

020 8853 8979 | [greenwich.lettings@chaseevans.com](mailto:greenwich.lettings@chaseevans.com)

## We're here to help.

IMPORTANT NOTICE - These particulars have been prepared in good faith and they are not intended to constitute part of an offer or contract. We have not performed a structural survey on this property and the services, appliances and specific fittings have not been tested. All photographs, measurements, floor plans and distances referred to are given as a guide and should not be relied upon.

[chaseevans.com](http://chaseevans.com)

 Chase Evans