



## Tyger House, Royal Arsenal Riverside, New Warren Lane, Woolwich, SE18

Asking price **£590,000** | Leasehold



# Tyger House, Royal Arsenal Riverside, New Warren Lane, Woolwich, SE18



2 Bedrooms



2 Bathrooms



1 Reception



Balcony



Gymnasium



Local Amenities



24-Hour Concierge



0.1 MI Woolwich

An immaculate two-bedroom, two-bathroom property with a balcony in the impressive Royal Arsenal Riverside, a modern development in Woolwich. The apartment includes a spacious open-plan kitchen/living/dining space, an en suite master bedroom, a further double bedroom and a family bathroom. Features include engineered wood flooring, dual aspect living room, integrated kitchen appliances, recessed down lighting throughout, a built-in bedroom wardrobe, luxury bathroom fittings and ware. The balcony is well proportioned with decking, glass balustrade and handrail, as well as energy-efficient external lighting.

Berkeley Homes is a developer renowned for outstanding luxury, and this is reflected throughout the apartment, through various high-end fixtures and fittings, and endless attention to detail ensuring the highest quality finish. Busy professionals also require first-class facilities, and this development certainly does not disappoint.

Residents benefit from access to a 24-hour concierge service, a large fully equipped gymnasium with state-of-the-art equipment, a heated indoor pool with sauna and steam room, plus there is a private screening cinema.

**Tenure:** Leasehold (992 years remaining) **Local Authority:** Greenwich London

**Ground Rent:** £475 p.a. **Council Tax Band:** D

**Service Charge:** £4,314 p.a. **EPC:** B

# Floorplan

756 sq ft | 70.2 sq m

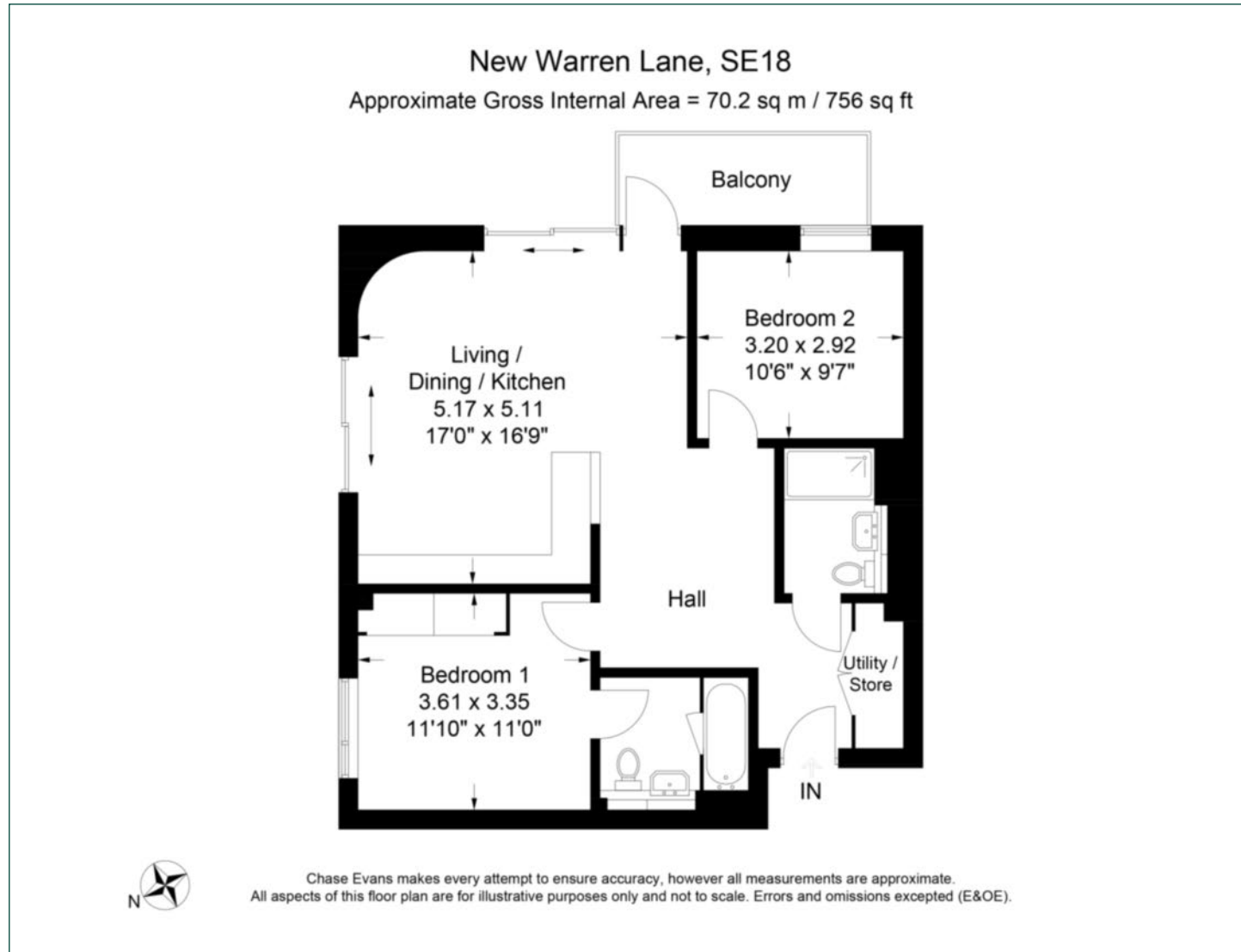

## Greenwich

1 Crescent Arcade, 279 Creek Road, London, SE10 9EJ

## Sales

020 8853 8978 | [greenwich.sales@chaseevans.com](mailto:greenwich.sales@chaseevans.com)

## We're here to help.

IMPORTANT NOTICE - These particulars have been prepared in good faith and they are not intended to constitute part of an offer or contract. We have not performed a structural survey on this property and the services, appliances and specific fittings have not been tested. All photographs, measurements, floor plans and distances referred to are given as a guide and should not be relied upon.

[chaseevans.com](https://www.chaseevans.com)