



## Cleveley Court, Marine Wharf, Ashton Reach, Surrey Quays, SE16

Price **£519 per week** | Furnished





# Cleveley Court, Marine Wharf, Ashton Reach, Surrey Quays, SE16



2 Bedrooms



1 Bathroom



1 Reception



Balcony



Gymnasium



Local Amenities



24-Hour Concierge



0.4 MI Surrey Quays

Stunning two bedroom luxury apartment with a balcony set within this Berkeley development, located in Surrey Quays SE16. The property is offered designer furnished, comprising open-plan kitchen with fully integrated appliances, spacious living area opening to a private balcony, two good sized bedrooms with master en suite and fitted storage and a modern bathroom suite.

Residents have exclusive access to a private fitness and leisure suite, a gymnasium and onsite 24-hour concierge service. Situated in the Marine Wharf development by Berkeley Homes, it is surrounded

by a wealth of amenities including an onsite Tesco Express and café as well as a Co-op, restaurant, delicatessen and hair salon. Marine Wharf is also located near to the water's edge.

Transport options nearby including the Jubilee Line at Canada Water, London Overground at Surrey Quays, Thames Clippers riverboats and numerous bus services. Residents benefit from easy access to Canary Wharf, London Bridge and beyond.

**Local Authority:**

Lambeth London

**Council Tax Band:**

E

**EPC:**

B

**Security deposit:**

equivalent to 5 weeks' rent



# Floorplan

676 sq ft | 62.8 sq m

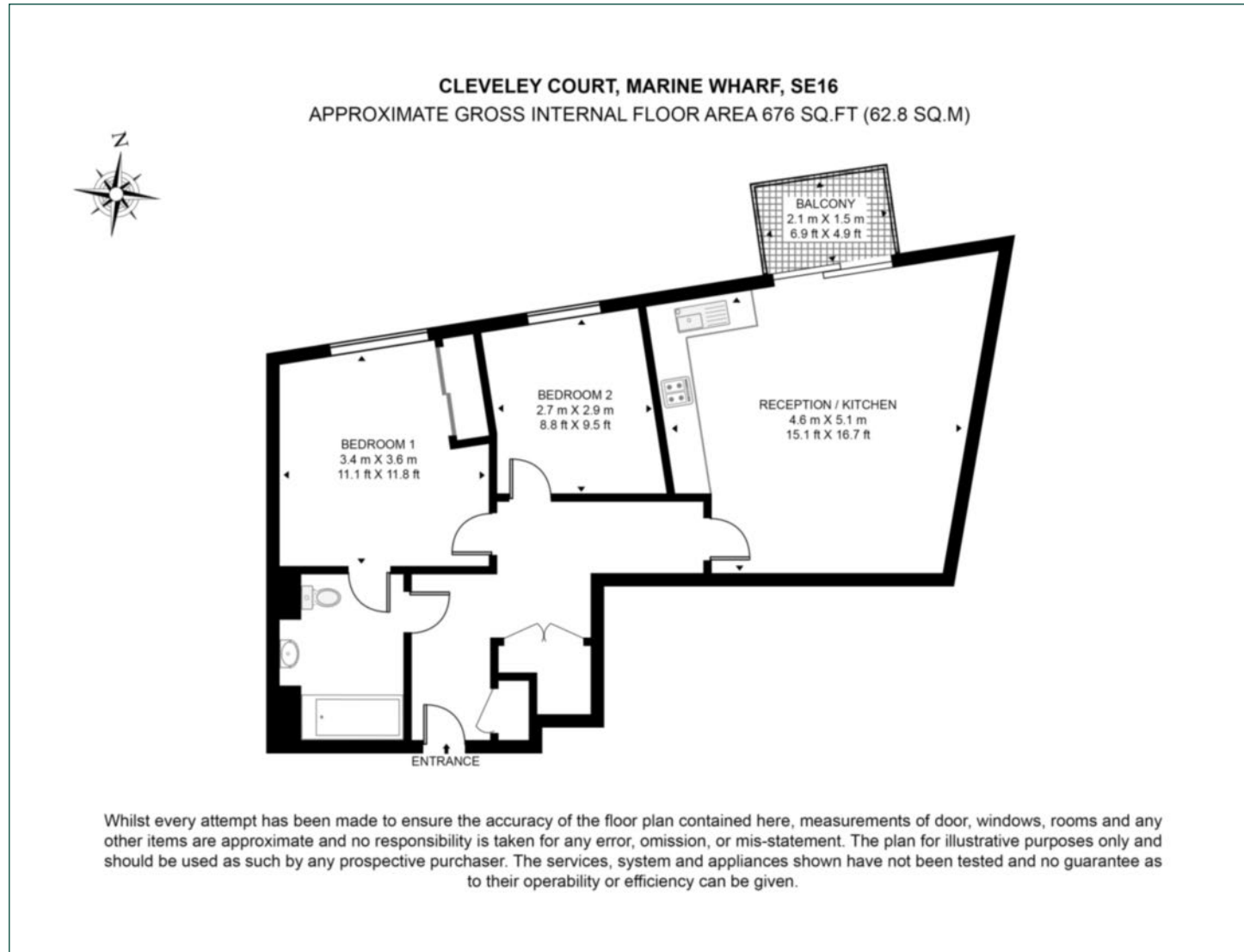

## Greenwich

1 Crescent Arcade, 279 Creek Road, London, SE10 9EJ

## Lettings

020 8853 8979 | [greenwich.lettings@chaseevans.co.uk](mailto:greenwich.lettings@chaseevans.co.uk)

## We're here to help.

IMPORTANT NOTICE - These particulars have been prepared in good faith and they are not intended to constitute part of an offer or contract. We have not performed a structural survey on this property and the services, appliances and specific fittings have not been tested. All photographs, measurements, floor plans and distances referred to are given as a guide and should not be relied upon.

[chaseevans.com](http://chaseevans.com)

 Chase Evans