



## Marsden House, Kidbrooke Village, Kidbrooke, SE3

Price **£425 per week** | Furnished



# Marsden House, Kidbrooke Village, Kidbrooke, SE3



1 Bedroom



1 Bathroom



1 Reception



Balcony



Gym



Local Amenities



Park



Concierge



0.1 MI Kidbrooke Station

Contemporary, bright, one-bedroom apartment with a balcony in Marsden House, part of the impressive Kidbrooke Village development in SE9.

This furnished apartment includes an entrance hall leading to a dual aspect and open plan kitchen/living room, an ample bedroom with a built-in wardrobe, and a modern bathroom. Features include wood flooring, stylish kitchen cabinetry, and contemporary built-in appliances, extensive corner glazing affording dual aspect views, and modern bathroom tiling and ware.

Residents have access to a 24-hour concierge service. Locally there is a good selection of shops and restaurants and also an abundance of beautifully landscaped public green spaces. The development is located a stone's throw from Kidbrooke railway station, which is serviced by Southeastern Rail lines providing fast transport to London Bridge, Waterloo East, Charing Cross, and Victoria Station. Commutes from here to Greenwich are just 20mins.

**Local Authority:** Greenwich

**Council Tax Band:** C

**EPC:** B

**Security deposit:** equivalent to 5 weeks' rent



# Floorplan

484 sq ft | 44.9 sq m

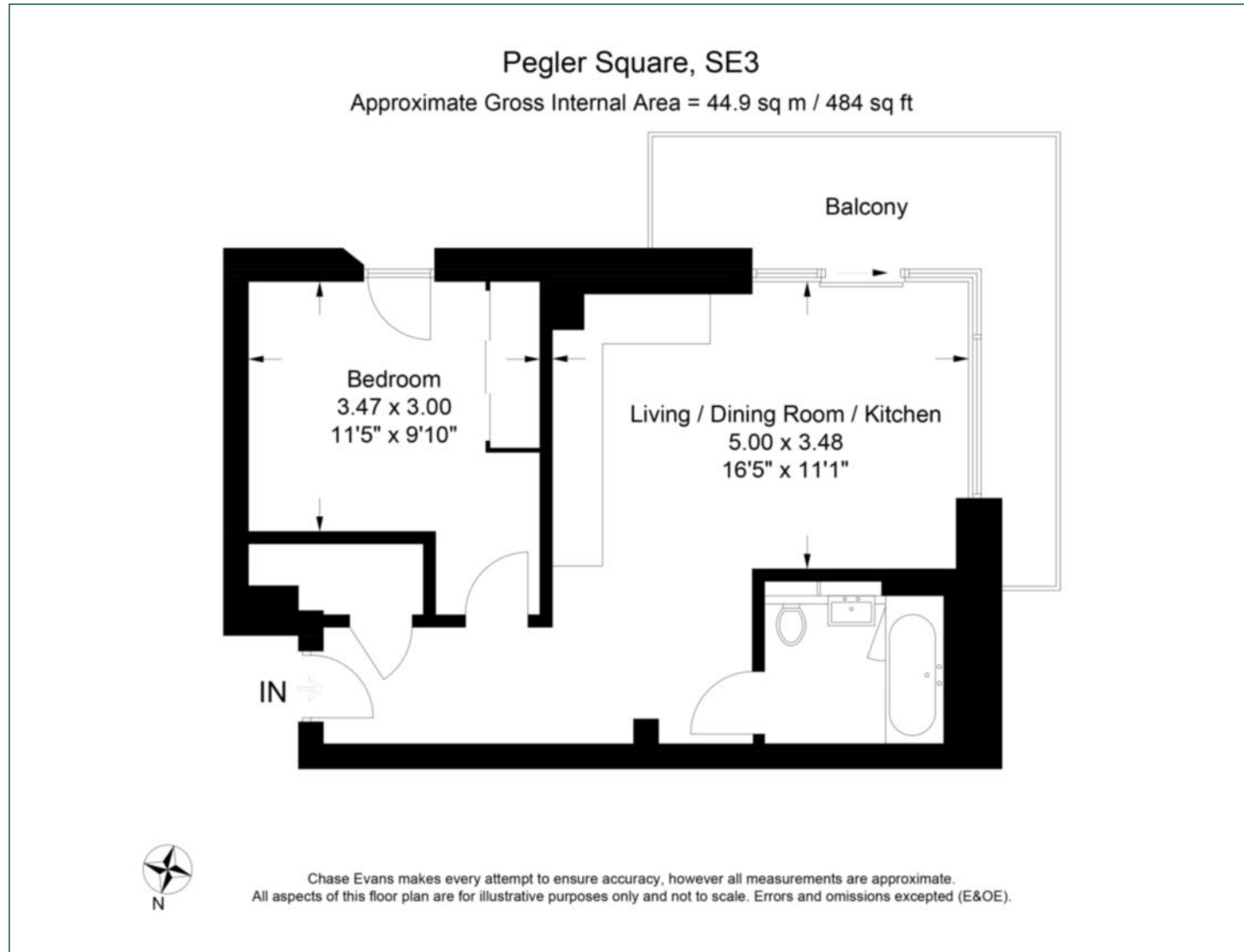

## Greenwich

1 Crescent Arcade, 279 Creek Road, London, SE10 9EJ

## Lettings

020 8853 8979 | [greenwich.lettings@chaseevans.co.uk](mailto:greenwich.lettings@chaseevans.co.uk)

## We're here to help.

IMPORTANT NOTICE - These particulars have been prepared in good faith and they are not intended to constitute part of an offer or contract. We have not performed a structural survey on this property and the services, appliances and specific fittings have not been tested. All photographs, measurements, floor plans and distances referred to are given as a guide and should not be relied upon.

[chaseevans.com](http://chaseevans.com)

 Chase Evans