



The Duke, Langley Square, Oldfield Place, Dartford, DA1

Asking price **£245,000** | Leasehold



The Duke, Langley Square, Oldfield Place, Dartford, DA1



1 Bedroom



1 Bathroom



1 Reception



Balcony



Entry Phone System



Communal Garden



Local Amenities



0.1 MI Dartford

A well-appointed one bedroom property in Langley Square, Dartford DA1. This property boasts 549 sq ft of living space. Accommodation includes spacious living room, open-plan fitted kitchen with integrated appliances, featuring wood flooring, extensive glazing, a double bedroom with built in wardrobe, a bathroom with modern tiling and ware, and a private balcony.

Residents also have access to communal gardens and an audio entry phone system, adding to the apartment's security and convenience. Langley Square development is located inside the M25 and

offers homes in a leafy garden suburb setting on the banks of River Darent.

There are several local amenities that residents will be able to enjoy nearby including several bars, restaurants and a large retail park. The development is also located within a short distance from Dartford railway station, providing residents with a useful transport link for commutes to London Victoria, Charing Cross and other key destinations across the capital.

Tenure: Leasehold (991 years remaining) **Local Authority:** Dartford District

Ground Rent: £300 p.a. **Council Tax Band:** C

Service Charge: £1,457.10 p.a. **EPC:** B

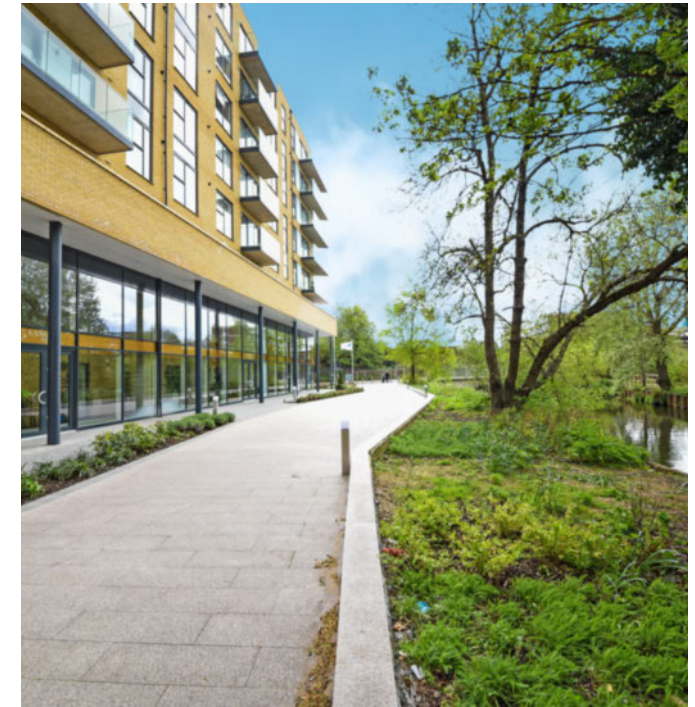

Floorplan

549 sq ft | 51.0 sq m

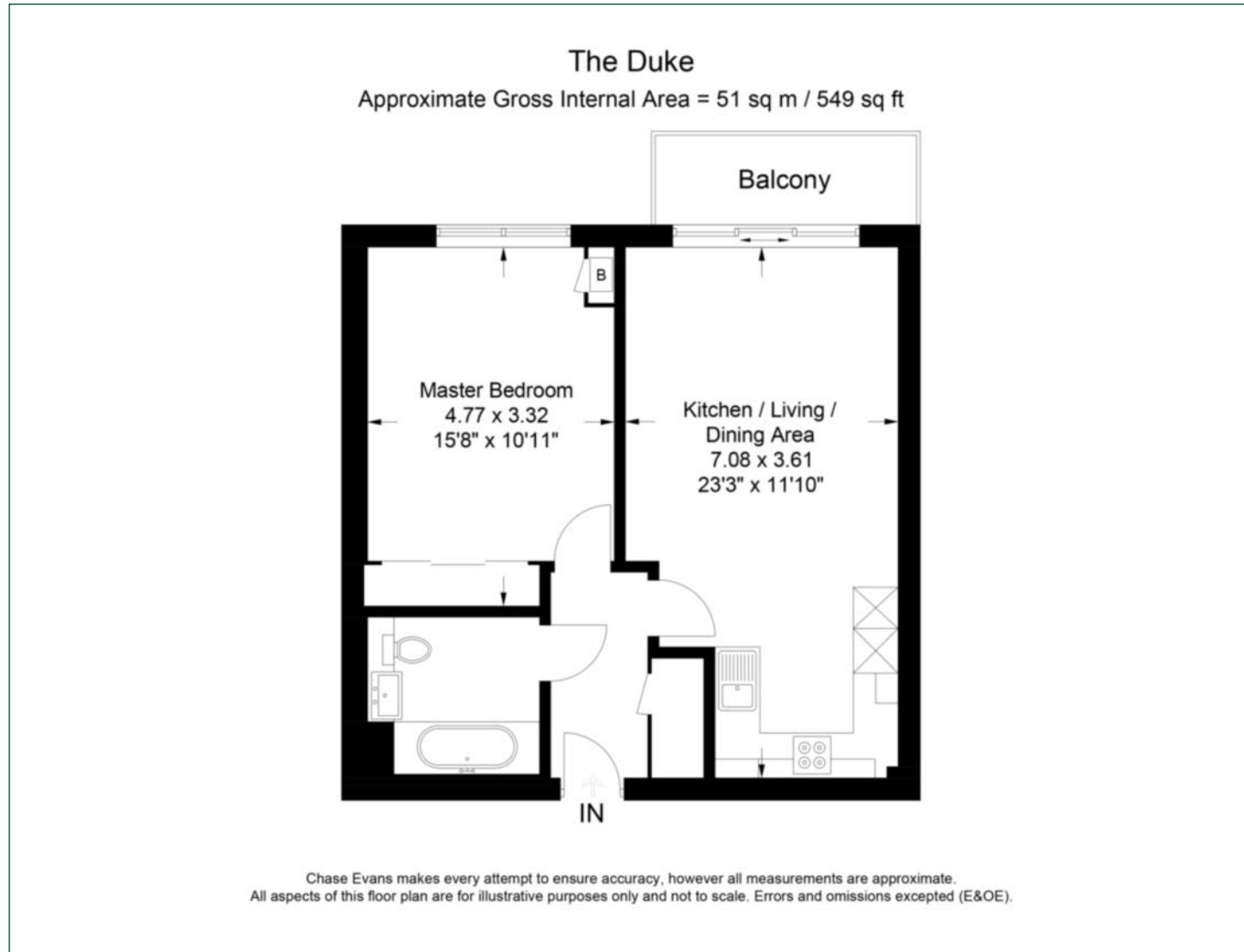

Greenwich

1 Crescent Arcade, 279 Creek Road, London, SE10 9EJ

Sales

020 8853 8978 | greenwich.sales@chaseevans.co.uk

We're here to help.

IMPORTANT NOTICE - These particulars have been prepared in good faith and they are not intended to constitute part of an offer or contract. We have not performed a structural survey on this property and the services, appliances and specific fittings have not been tested. All photographs, measurements, floor plans and distances referred to are given as a guide and should not be relied upon.

chaseevans.com