

## Landmann Point, Peartree Way, Greenwich, SE10

Price **£425 per week** | Furnished



# Landmann Point, Peartree Way, Greenwich, SE10



1 Bedroom



1 Bathroom



1 Reception



Balcony



Prime Location



Local Amenities



0.6 MI Westcombe Park

Superb one bedroom apartment located within this luxury development within the newest phase of Greenwich Millennium village. The apartment boasts ample space and benefits from access to a private balcony, spacious open plan integrated kitchen/living area, large bedroom with built in wardrobe and access to the balcony, modern bathroom, high quality finish throughout.

The apartment is located within walking distance of the O2 which hosts a wide selection of bars, restaurants and cinema, The Emirates cable car is also nearby.

North Greenwich tube station provides links to Canary Wharf and London Bridge. Charlton and Westcombe Park overground. Greenwich Millennium Village features an abundance of landscaped green areas and riverside walkways. The development has a health centre, primary school and local shopping facilities. Retail outlets as well as the local shopping facilities. There are excellent transport links with easy access onto the A102, A2 and A13.

**Local Authority:** Greenwich London

---

**Council Tax Band:** C

---

**EPC:** C

---

**Security deposit:** equivalent to 5 weeks' rent

---

# Floorplan

604 sq ft | 56.11 sq m

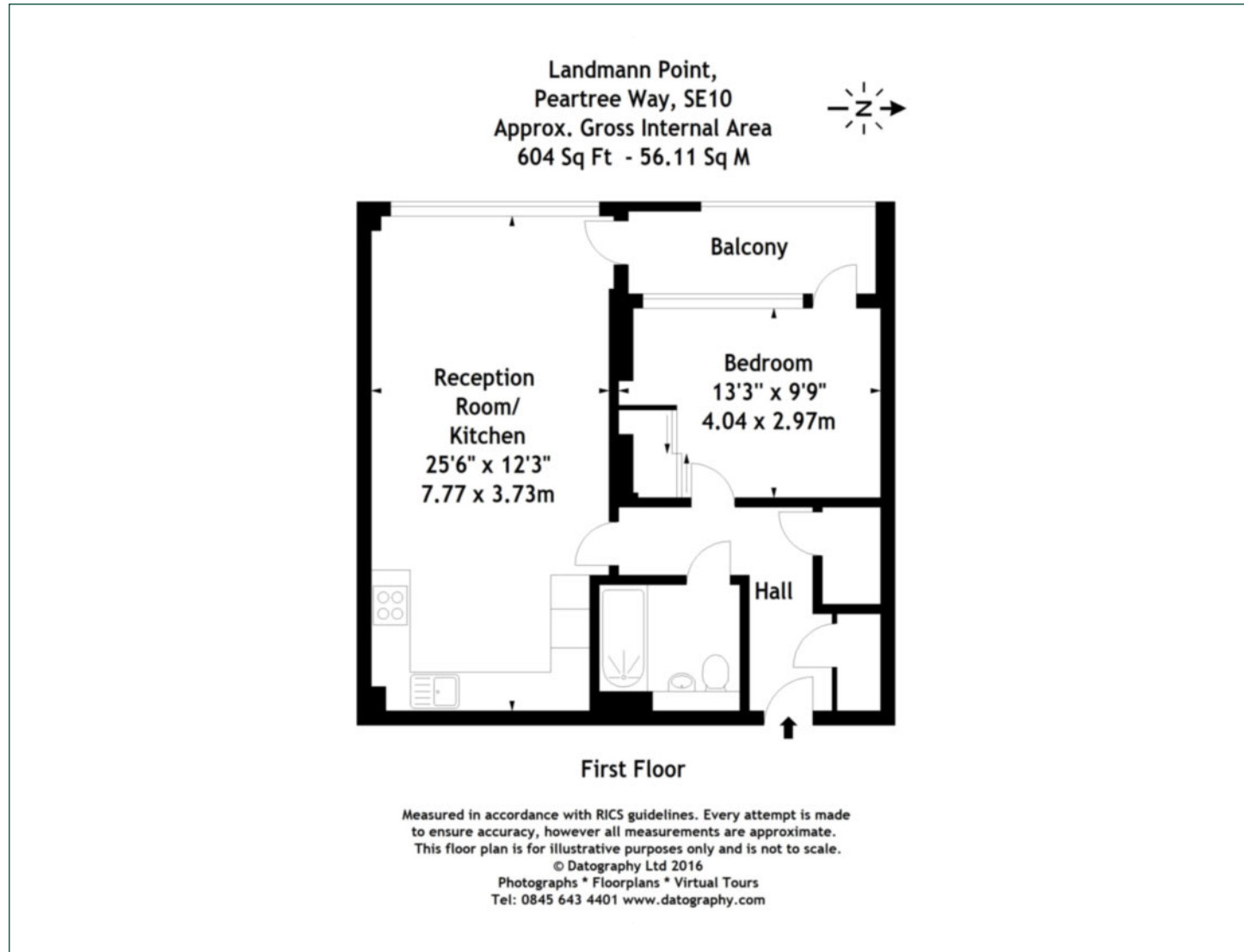

## Greenwich

1 Crescent Arcade, 279 Creek Road, London, SE10 9EJ

## Lettings

020 8853 8979 | greenwich.lettings@chaseevans.co.uk

## We're here to help.

IMPORTANT NOTICE - These particulars have been prepared in good faith and they are not intended to constitute part of an offer or contract. We have not performed a structural survey on this property and the services, appliances and specific fittings have not been tested. All photographs, measurements, floor plans and distances referred to are given as a guide and should not be relied upon.

[chaseevans.com](http://chaseevans.com)