



Poldo House, Enderby Wharf, Cable Walk, Greenwich, SE10

Price **£435 per week** | Furnished



Poldo House, Enderby Wharf, Cable Walk, Greenwich, SE10



1 Bedroom



1 Bathroom



1 Reception



Balcony



Gymnasium



Local Amenities



24-Hour Concierge



0.5 MI Maze Hill

A contemporary one bedroom apartment with a balcony set on the second floor of this fantastic riverside development in SE10 Greenwich. The apartment is offered designer furnished and benefits from a spacious open plan living room, fully integrated kitchen, luxury bathroom and a private balcony.

The development offers a 24-hour concierge service and exclusive residents' gymnasium. Situated between a choice of three stations, which include North Greenwich (Jubilee), Maze Hill & Westcombe Park (Overground), with a large selection of (A)

roads close by, making Central London and beyond easily accessible.



Local Authority:

Greenwich London

Council Tax Band:

B

EPC:

B

Security deposit:

equivalent to 5 weeks' rent

Floorplan

588 sq ft | 51.37 sq m

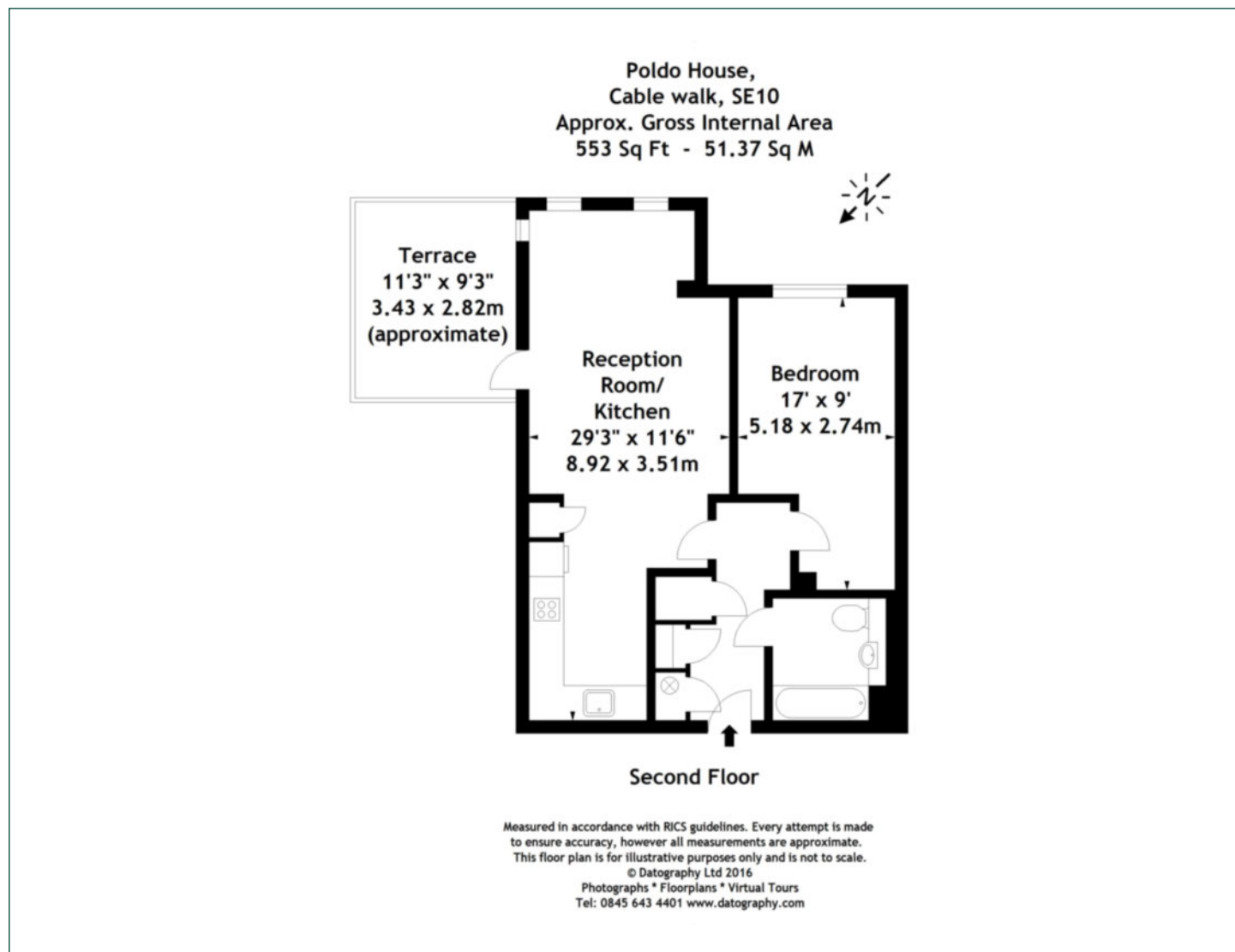

Greenwich

1 Crescent Arcade, 279 Creek Road, London, SE10 9EJ

Lettings

020 8853 8979 | greenwich.lettings@chaseevans.com

We're here to help.

IMPORTANT NOTICE - These particulars have been prepared in good faith and they are not intended to constitute part of an offer or contract. We have not performed a structural survey on this property and the services, appliances and specific fittings have not been tested. All photographs, measurements, floor plans and distances referred to are given as a guide and should not be relied upon.

chaseevans.com