



Imperial Building, Duke Of Wellington Avenue, Woolwich, SE18

Asking price **£525,000** | Leasehold



Imperial Building, Duke Of Wellington Avenue, Woolwich, SE18



2 Bedrooms



2 Bathrooms



1 Reception



Terrace



Gymnasium



Local Amenities



24-Hour Concierge



0.3 MI Woolwich

Modern two bedroom, two bathroom apartment on the ground floor of the Royal Arsenal Riverside development by Berkeley Homes. This apartment includes an spacious open plan living and dining area, fitted kitchen with integrated appliances, wood flooring, full length windows, fitted bedroom storage, master en-suite, stylish shower room suite and a private patio.

Residents will have access to a 24-hour concierge service, gymnasium, on-site shops and dining facilities. There are several amenities located nearby including cafés, restaurants and shops. The

development is located near to Woolwich Arsenal station, providing DLR and rail services, Elizabeth Line for commutes to destinations across the Capital.

Tenure: Leasehold (990 years remaining) **Local Authority:** Greenwich

Ground Rent: £400 p.a. **Council Tax Band:** C

Service Charge: £3,604.72 p.a. **EPC:** B

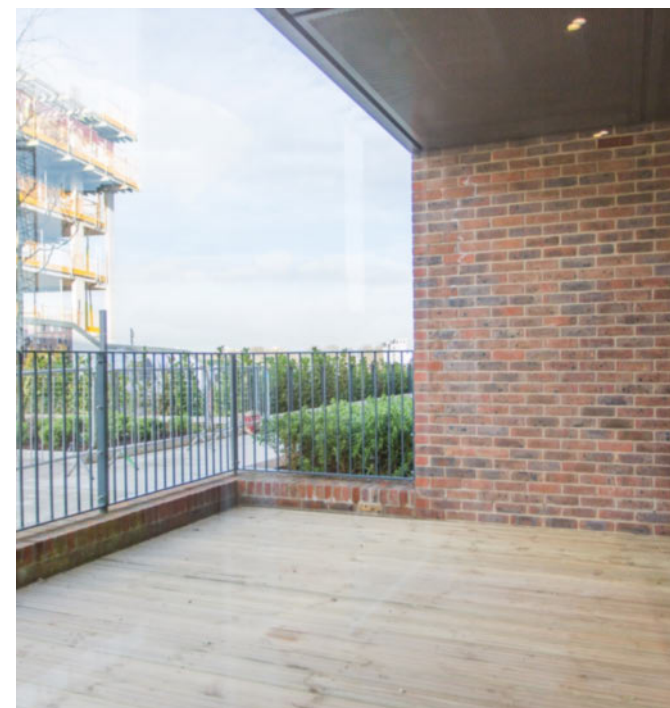

Floorplan

790 sq ft | 73.39 sq m

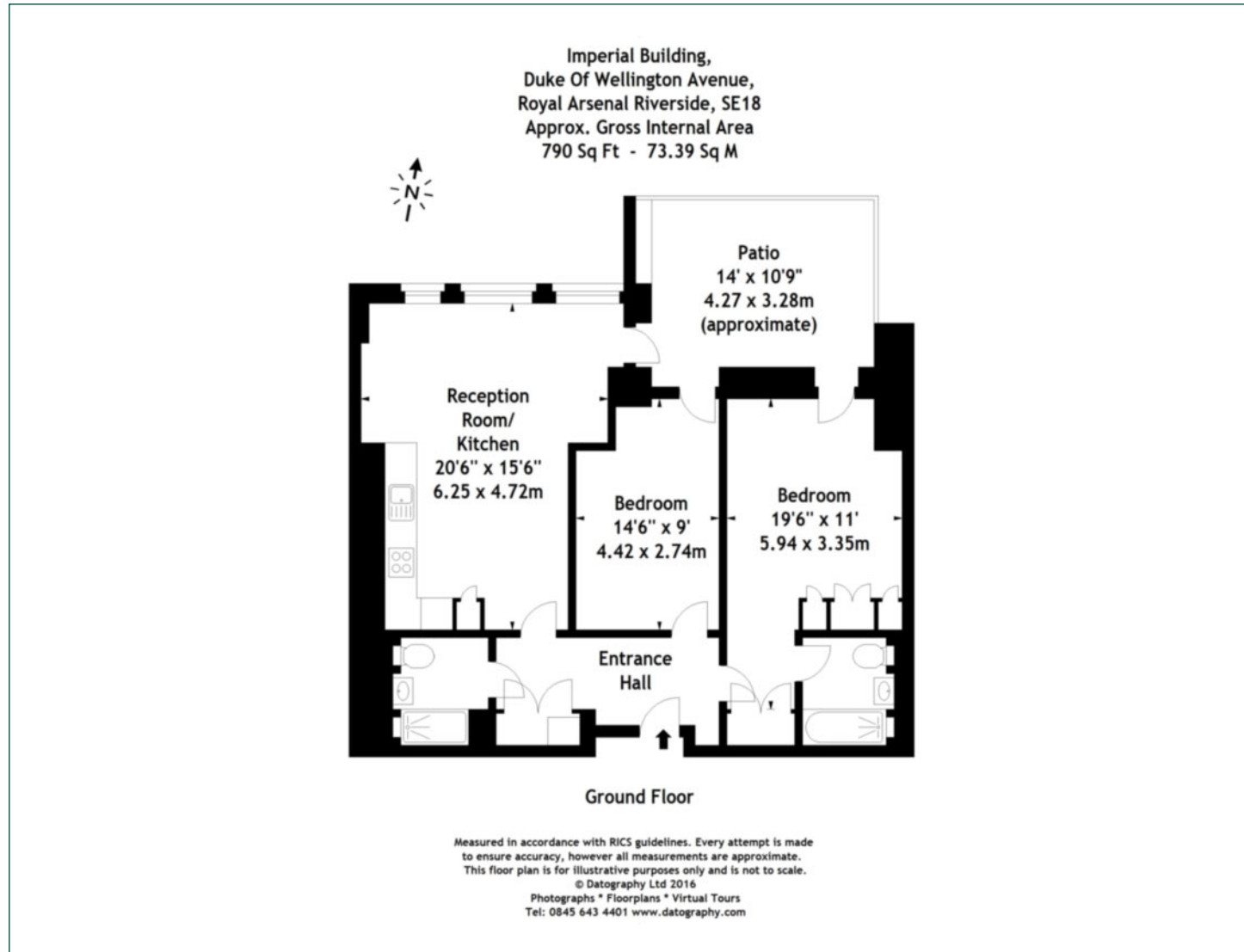

Greenwich

1 Crescent Arcade, 279 Creek Road, London, SE10 9EJ

Sales

020 8853 8978 | greenwich.sales@chaseevans.com

We're here to help.

IMPORTANT NOTICE - These particulars have been prepared in good faith and they are not intended to constitute part of an offer or contract. We have not performed a structural survey on this property and the services, appliances and specific fittings have not been tested. All photographs, measurements, floor plans and distances referred to are given as a guide and should not be relied upon.

chaseevans.com