

Barracks Court, Royal Arsenal Riverside, Woolwich, SE18

OIEO **£465,000** | Leasehold



Barracks Court, Royal Arsenal Riverside, Woolwich, SE18



1 Bedroom



1 Bathroom



1 Reception



Balcony



Residents' Gym



Pool & Spa



A Stroll to the Thames



24-Hour Concierge



0.1 MI Woolwich

Luxury one bedroom apartment set within Barracks Court, the latest phase of the scenic Royal Arsenal Riverside development, SE18. The property comprises a spacious open plan living and dining space, fitted kitchen with integrated appliances, master bedroom with fitted wardrobes and modern bathroom suite.

Residents will benefit from a 24-hour concierge service, on-site resident's gym, cinema, swimming pool and spa facilities. The development is within walking distance to Woolwich town centre and Woolwich Arsenal railway station, which provides

regular services into London Bridge in 20 minutes and London Charing Cross in 30 minutes. Once complete, you will have easy access to the new Elizabeth Line, which will take you to Canary Wharf in 10 minutes, Liverpool Street in 15 minutes, and 45 minutes to Heathrow Airport.



Tenure: Leasehold (994 years remaining) **Local Authority:** Greenwich

Ground Rent: £375 p.a. **Council Tax Band:** C

Service Charge: £3,800 p.a. **EPC:** B

Floorplan

548 sq ft | 50.9 sq m

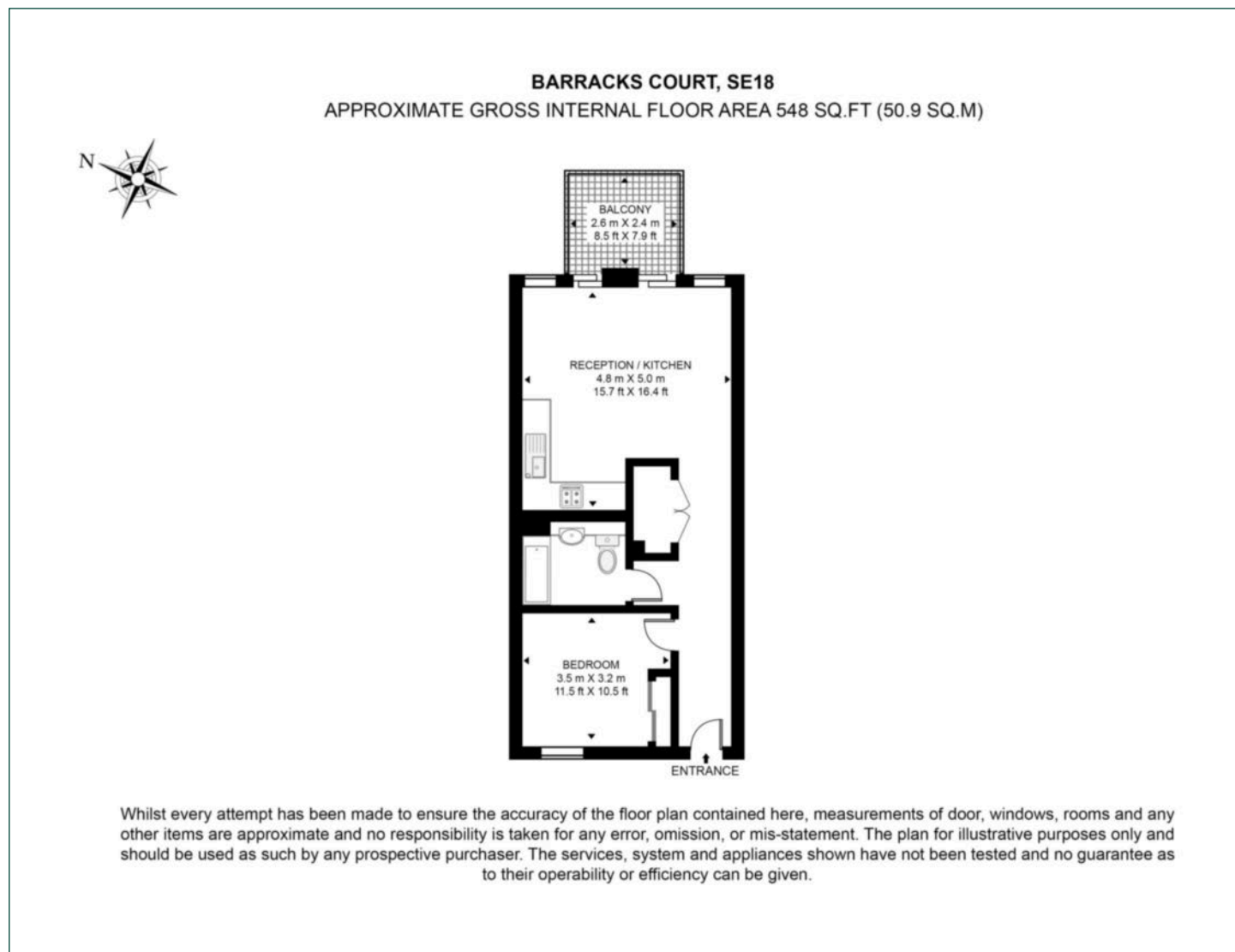

Greenwich

1 Crescent Arcade, 279 Creek Road, London, SE10 9EJ

Sales

020 8853 8978 | greenwich.sales@chaseevans.com

We're here to help.

IMPORTANT NOTICE - These particulars have been prepared in good faith and they are not intended to constitute part of an offer or contract. We have not performed a structural survey on this property and the services, appliances and specific fittings have not been tested. All photographs, measurements, floor plans and distances referred to are given as a guide and should not be relied upon.

chaseevans.com

 Chase Evans