



## Norton House, Royal Arsenal Riverside, Duke Of Wellington Avenue, SE18

Asking price **£1,350,000** | Leasehold





# Norton House, Royal Arsenal Riverside, Duke Of Wellington Avenue, SE18



3 Bedrooms



2 Bathrooms



1 Reception



2 Balconies



Gymnasium



Underground Parking



Local Amenities



24-Hour Concierge



0.4 MI Woolwich Arsenal

A unique, spacious and bright three bedroom & study, duplex penthouse riverside property with two large balconies overlooking the Thames in this sought-after development .

Comprises an open plan kitchen/ living/ dining room, office and guest cloakroom and utility room on the lower level. Upstairs are the ensuite master bedroom featuring a large wardrobe, two further double bedrooms served by the second bathroom fitted with a shower.

Access to a large private balcony and all principal rooms have far reaching direct amazing views of the

River Thames/towards Canary Wharf, the City. Wood flooring, floor to ceiling glazing, modern kitchen cabinetry, excellent wardrobe and storage space, fully tiled bathrooms. Underground parking included.

Royal Arsenal Riverside is a fantastic new development which offers access to first class facilities including 24-hour concierge, gym, swimming pool, bicycle storage. The apartment is located close to the buzzing Woolwich area filled with green spaces and variety of dining and shopping outlets. Woolwich Arsenal Riverside DLR and National Rail Station are a short walk away.

**Tenure:** Leasehold (989 years remaining)

**Local Authority:** Greenwich London

**Ground Rent:** £300 p.a.

**Council Tax Band:** E

**Service Charge:** £2,201.54 p.a.

**EPC:** B



# Floorplan

1,491 sq ft | 138.5 sq m

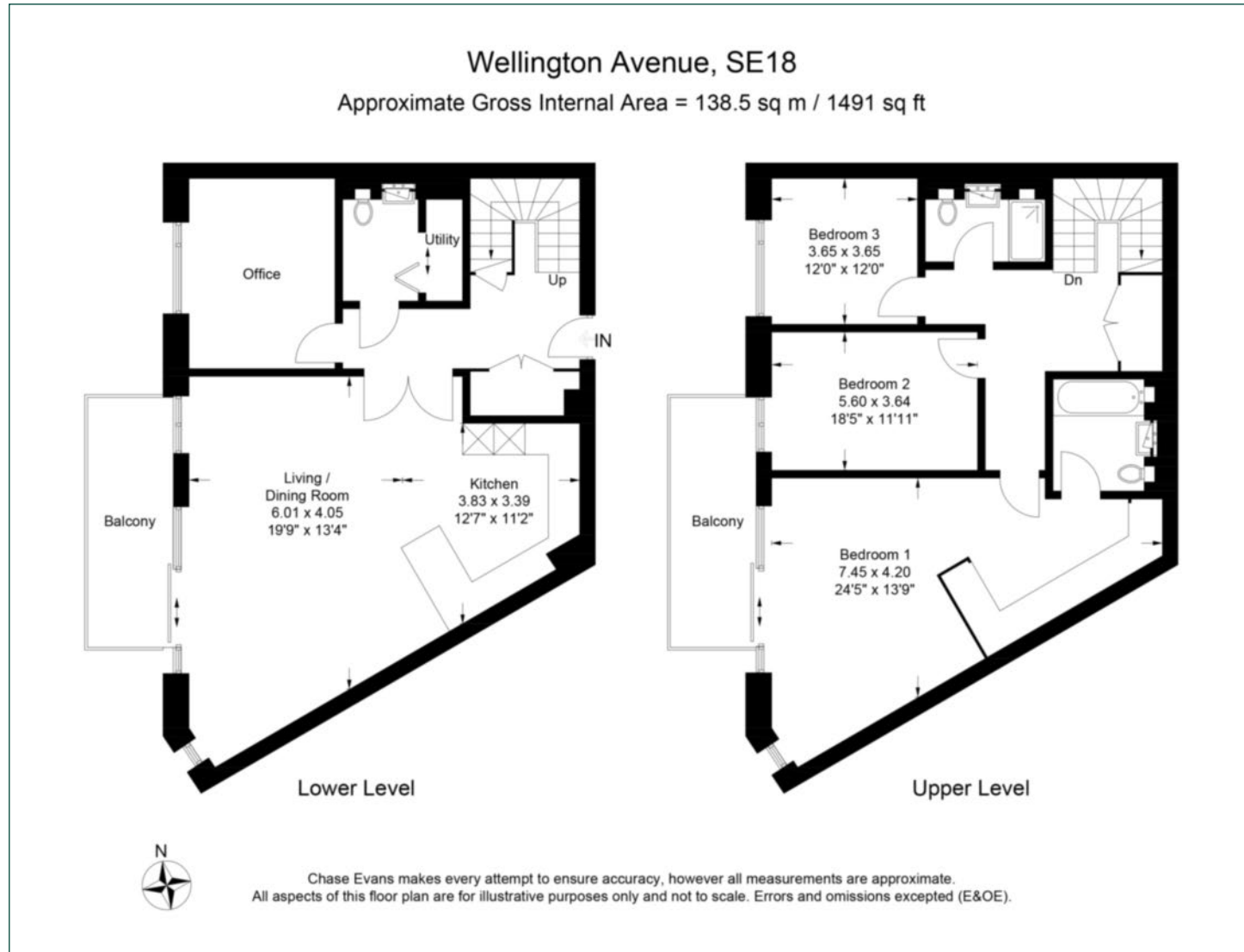

## Greenwich

1 Crescent Arcade, 279 Creek Road, London, SE10 9EJ

## Sales

020 8853 8979 | [greenwich.sales@chaseevans.co.uk](mailto:greenwich.sales@chaseevans.co.uk)

## We're here to help.

IMPORTANT NOTICE - These particulars have been prepared in good faith and they are not intended to constitute part of an offer or contract. We have not performed a structural survey on this property and the services, appliances and specific fittings have not been tested. All photographs, measurements, floor plans and distances referred to are given as a guide and should not be relied upon.

[chaseevans.com](http://chaseevans.com)

 Chase Evans