



## Barquentine Heights, Peartree Way, Greenwich, SE10

Asking price **£380,000** | Leasehold



# Barquentine Heights, Peartree Way, Greenwich, SE10



1 Bedroom



1 Bathroom



1 Reception



Balcony



Local Amenities



Concierge Service



1.0 MI North  
Greenwich

Contemporary, well planned, and bright one bedroom property with a balcony in this Greenwich Millennium Village, a residential-led, mixed use riverside development on Greenwich Peninsula. The generous open-plan kitchen/ living area features high quality integrated appliances, contemporary worktops and cabinetry, laminate flooring and ceramic tiling. Large floor to ceiling glazing lets in floods of natural daylight and leads onto the private balcony. There is an ample bedroom with a fitted wardrobe and a modern and light bathroom.

The development provides 24-hour concierge services and bicycle storage space. The property is nearby North Greenwich station for London Underground (Jubilee line for Canary Wharf, London Bridge, Waterloo and Bond Street) and DLR services to Canary Wharf and Stratford. North Greenwich Pier for Thames Clippers services to Canary Wharf and Westminster. Also nearby is the North Greenwich Cable Car for Emirates Air Line connections to the Royal Docks.

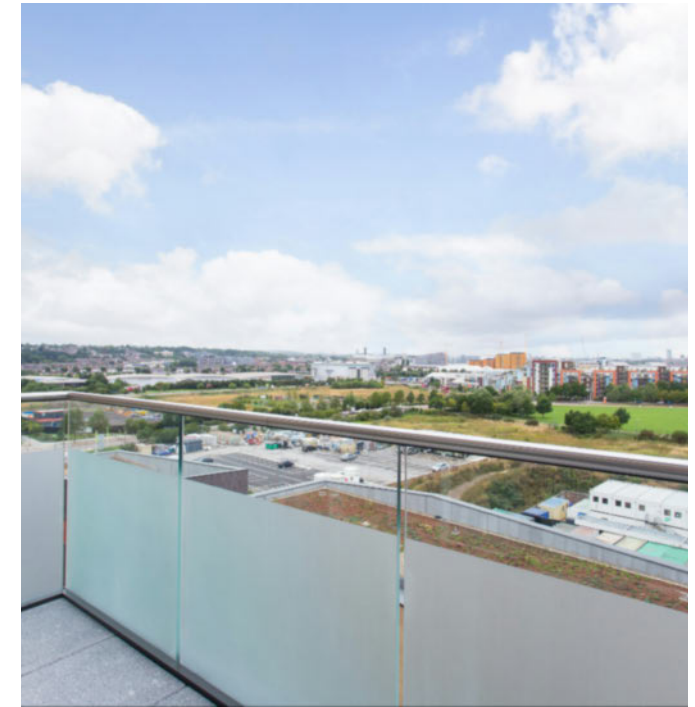

**Tenure:** Leasehold (988 years remaining)

**Local Authority:** Southwark Council

**Ground Rent:** £300 p.a.

**Council Tax Band:** C

**Service Charge:** £2,200 p.a.

**EPC:** B

# Floorplan

570 sq ft | 53.0 sq m

## Canary Skyline, Greenwich Millennium Village 2, SE10

Approximate Gross Internal Area = 53.0 sq m / 570 sq ft

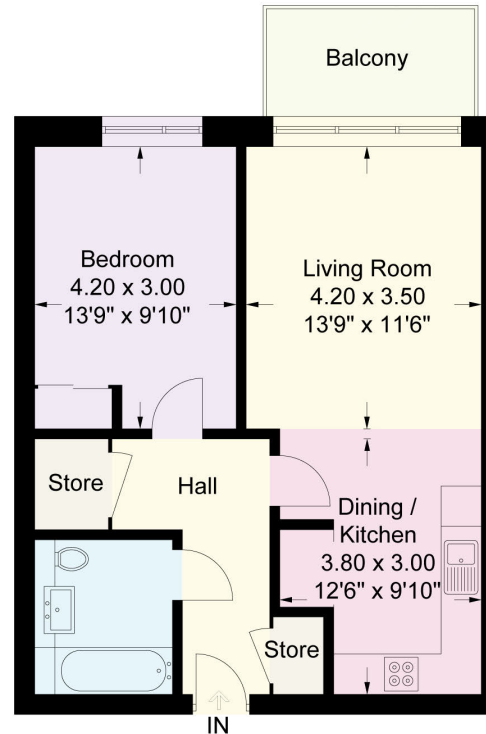

Chase Evans make every attempt to ensure accuracy, however all measurements are approximate. All aspects of this floor plan are for illustrative purposes only and not to scale. Errors and omissions excepted (E&OE).

### Greenwich

1 Crescent Arcade, 279 Creek Road, London, SE10 9EJ

### Sales

020 8853 8979 | [greenwich.sales@chaseevans.co.uk](mailto:greenwich.sales@chaseevans.co.uk)

## We're here to help.

IMPORTANT NOTICE - These particulars have been prepared in good faith and they are not intended to constitute part of an offer or contract. We have not performed a structural survey on this property and the services, appliances and specific fittings have not been tested. All photographs, measurements, floor plans and distances referred to are given as a guide and should not be relied upon.

[chaseevans.com](http://chaseevans.com)

 Chase Evans