



Cobham House, Kidbrooke Village, Pegler Square, Kidbrooke, SE3

Asking price **£550,000** | Leasehold



Cobham House, Kidbrooke Village, Pegler Square, Kidbrooke, SE3



2 Bedrooms



2 Bathrooms



1 Reception



Balcony



Gymnasium



Local Amenities



24-Hour Concierge



0.1 MI Kidbrooke

Bright and modern two bedroom apartment, two bathroom property with a balcony set within Cobham House part of the impressive Kidbrooke Village development, SE3. The apartment includes a spacious open plan living room, fully integrated kitchen, two good-sized bedrooms with fitted wardrobes, an en-suite plus a family bathroom.

The apartment is situated next to Kidbrooke train station, which runs to Lewisham in 6 minutes, London Bridge station in 15 minutes, Waterloo East in 20 minutes, Charing Cross in 25 minutes and 28 minutes to London Victoria, all of which are

positioned on the main London Underground lines. The development benefits from a vast amount of parkland and it is situated in the immediate vicinity of some of the most vibrant areas of London, Blackheath Village and Greenwich, both featuring an array of boutiques, restaurants and bars.

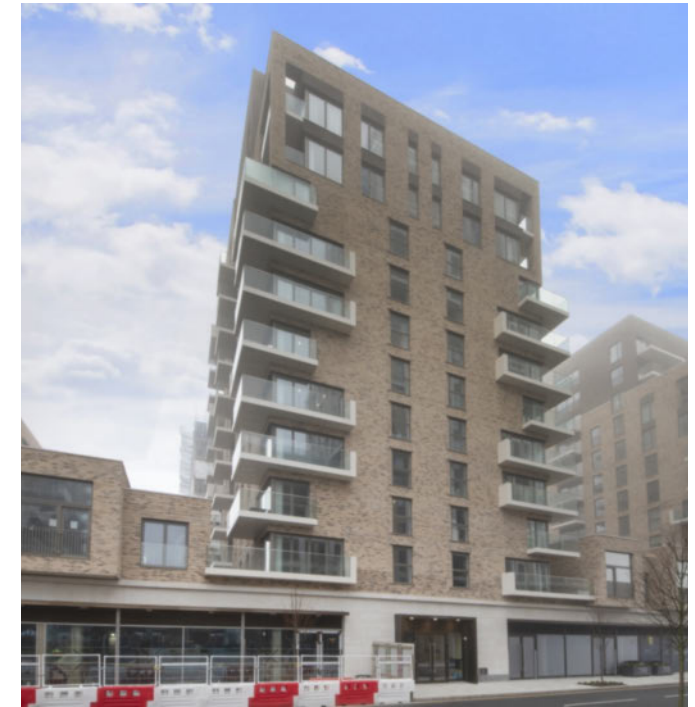

Tenure: Leasehold (996 years remaining) **Local Authority:** Greenwich London

Ground Rent: £400 p.a. **Council Tax Band:** D

Service Charge: £3,456.84 p.a. **EPC:** B

Floorplan

764 sq ft | 71 sq m

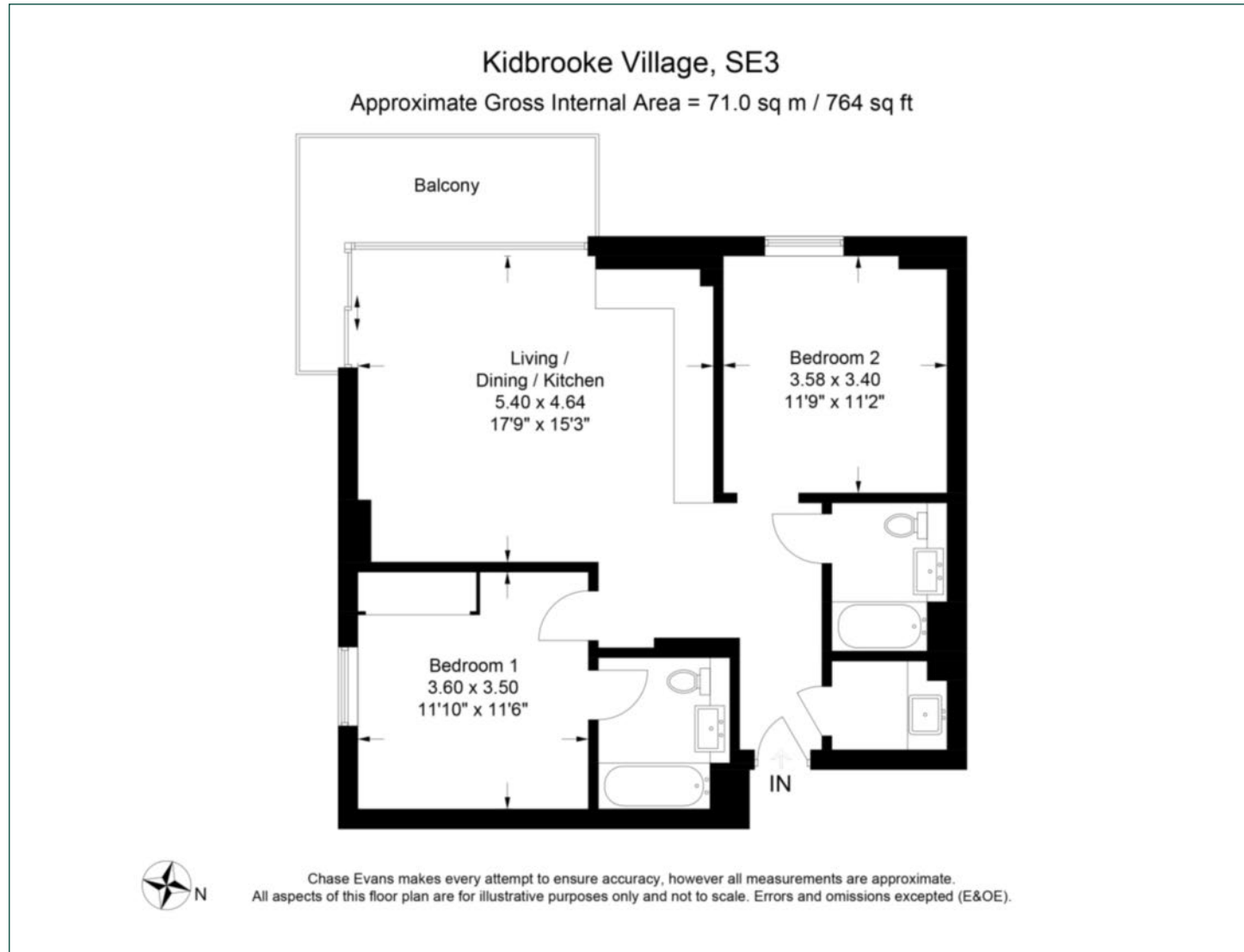

Greenwich

1 Crescent Arcade, 279 Creek Road, London, SE10 9EJ

Sales

020 8853 8979 | greenwich.sales@chaseevans.co.uk

We're here to help.

IMPORTANT NOTICE - These particulars have been prepared in good faith and they are not intended to constitute part of an offer or contract. We have not performed a structural survey on this property and the services, appliances and specific fittings have not been tested. All photographs, measurements, floor plans and distances referred to are given as a guide and should not be relied upon.

chaseevans.com

 Chase Evans