



Barquentine Heights, Greenwich Millennium Village, Greenwich, SE10

Guide price **£380,000** | Leasehold



Barquentine Heights, Greenwich Millennium Village, Greenwich, SE10



1 Bedroom



1 Bathroom



1 Reception



Balcony



Nearby O2 Arena



Local Amenities



0.9 MI North
Greenwich

Stunning 7th floor one bed apartment set in Barquentine Heights, Greenwich Millennium Village SE10. Comprising a bright living area with full height windows leading to a 62 sq. ft. balcony, open-plan kitchen with integrated appliances and a contemporary family bathroom with vanity unit & recessed storage. Generous double bedroom enjoys large west facing glazing and a fitted wardrobe.

This luxury development, within the newest phase of Greenwich Millennium village, benefits from a 24-hour concierge service. There are several

amenities located nearby including the Greenwich Shopping Park and the O2 Arena. The O2 Arena offers an outstanding array of attractions and hosts a wide variety of different events, from sports to music, throughout the year.

The apartment is located within 15 mins (0.7 miles) of Westcombe Park and 20 mins (0.9 miles) of North Greenwich tube. The stations are serviced by Thameslink, Southeastern and Jubilee Lines, making commutes from here to Canary Wharf within just 2 mins.

Tenure: Leasehold (988 years remaining) **Local Authority:** Greenwich

Ground Rent: £300 p.a. **Council Tax Band:** C

Service Charge: Approx. £2,200 p.a. **EPC:** B

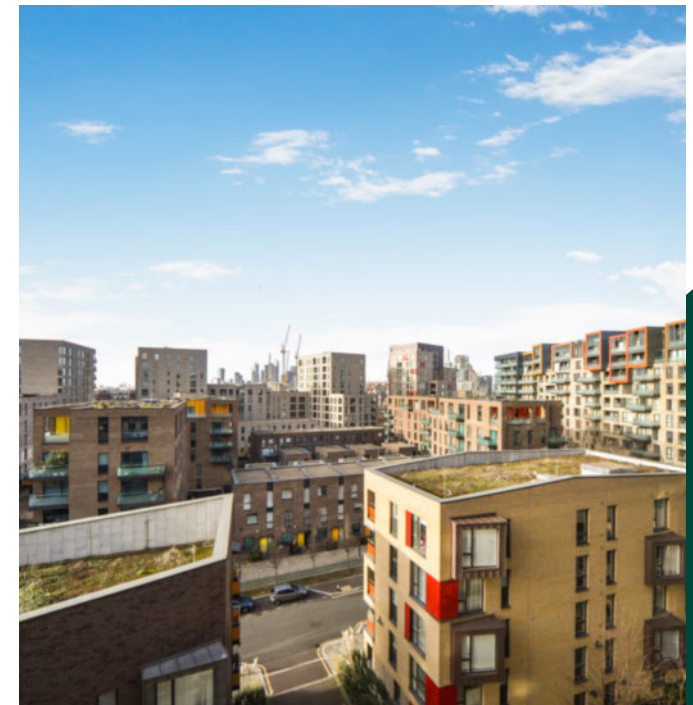

Floorplan

577 sq ft | 53.6 sq m

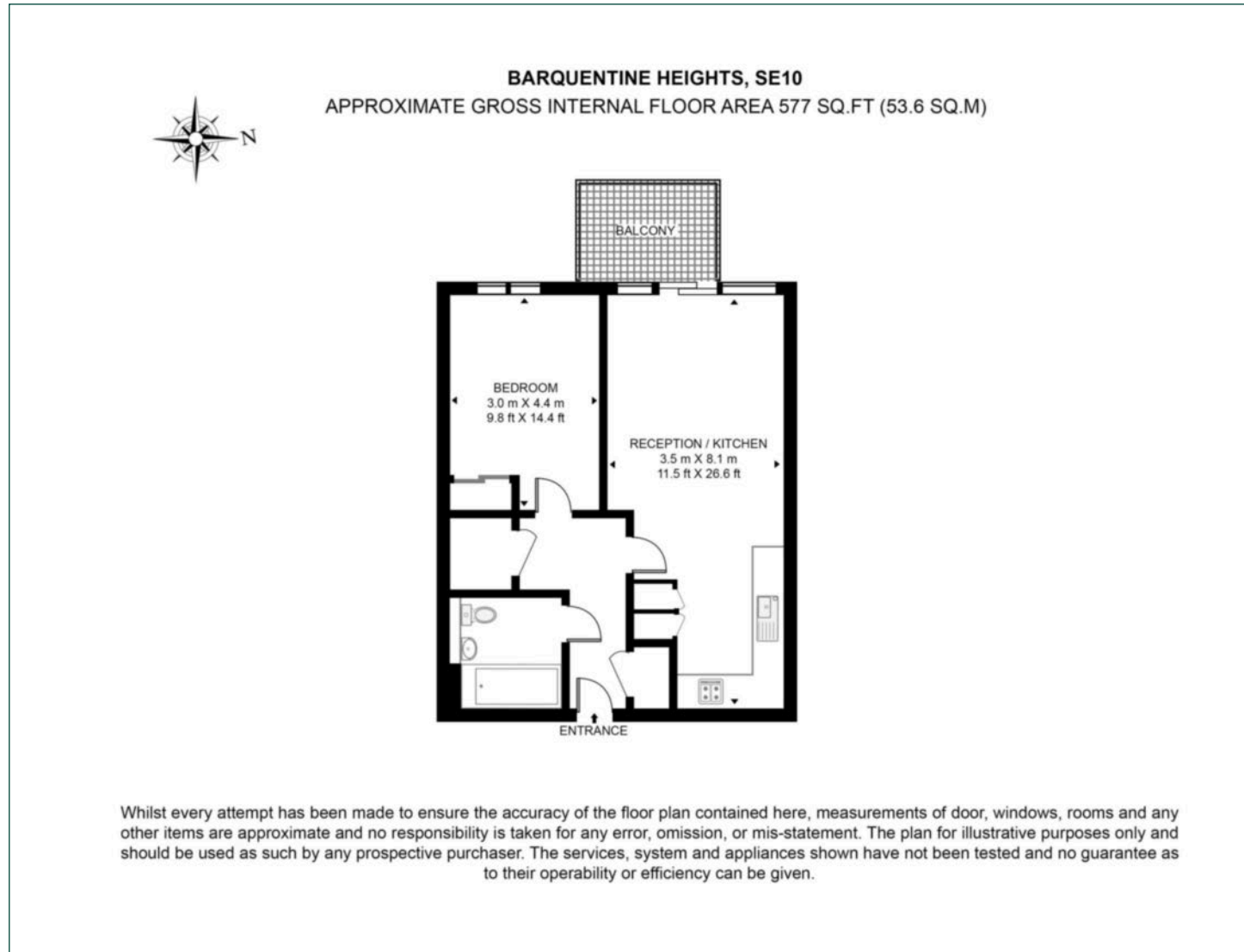

Greenwich

1 Crescent Arcade, 279 Creek Road, London, SE10 9EJ

Sales

020 8853 8978 | greenwich.sales@chaseevans.com

We're here to help.

IMPORTANT NOTICE - These particulars have been prepared in good faith and they are not intended to constitute part of an offer or contract. We have not performed a structural survey on this property and the services, appliances and specific fittings have not been tested. All photographs, measurements, floor plans and distances referred to are given as a guide and should not be relied upon.

chaseevans.com