



## Waterside , Thorne, Doncaster

OIRO £249,000



Freehold | EPC Rating: TBC

- Development Opportunity/Public House
- Steeping In History
- No Chain!
- Plot Size 691.8 SQM
- Semi Rural Location With Direct Access To J6 and M18
- Close To Local Amenities



Email  
[thorne@northwooduk.com](mailto:thorne@northwooduk.com)

Phone  
01405 814999

## Description

Northwood Thorne are extremely proud to present this amazing development opportunity situated in semi-rural location. The John Bull Inn is in need of a full renovation, the plot size offer plenty of space to potentially develop further pending planning permission. The site is steeping in history.... Waterside or Thorne Quay as it was known, was a thriving port up to the mid-19th century with ship building yards, warehouses and sail making businesses. Thorne can be found approximately nine miles on the outskirts of Doncaster town centre and is serviced by excellent range of local amenities including shops, schooling, public houses, regular bus services, two train station points and within close proximity. Waterside is close to J6 M18 linking into the M62, M1 and A1 motorway network bringing the regional centres of Sheffield, Leeds and Hull within easy reach. The public house ceased trading in 2018 and has been vacant since. The site is thought to be suitable for many alternative uses.

Call our Thorne office now to arrange a viewing!

Disclaimer - John Bull, Waterside - These details are intended to give a fair description only and their accuracy cannot be guaranteed nor are any floor plans (if included) exactly to scale. These details do not constitute part of any offer or contract and are not to be relied upon as statements of representation or fact. Intended purchasers are advised to recheck all measurements before committing to any expense and to verify the legal title of the property from their legal representative. Any contents shown in the images contained within these particulars will not be included in the sale unless otherwise stated or following individual negotiations with the vendor. Northwood have not tested any apparatus, equipment, fixtures or services so cannot confirm that they are in working order and the property is sold on this basis.

## Photographs

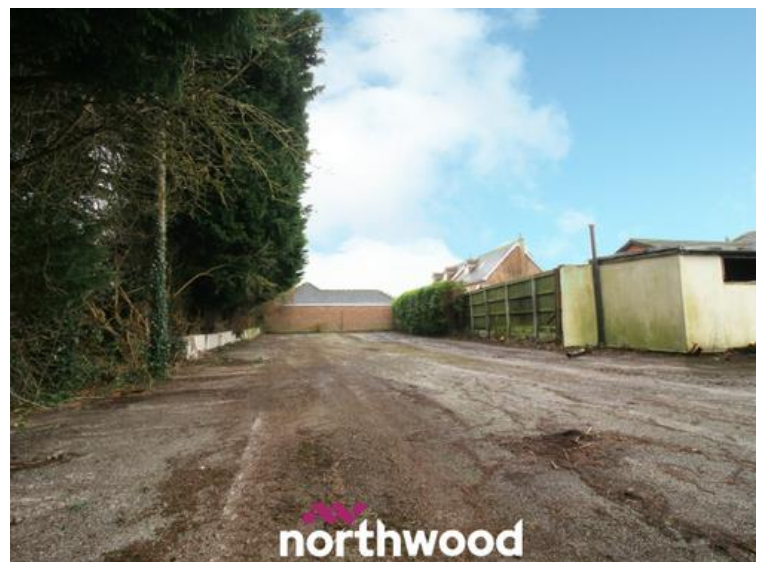

# Floorplan

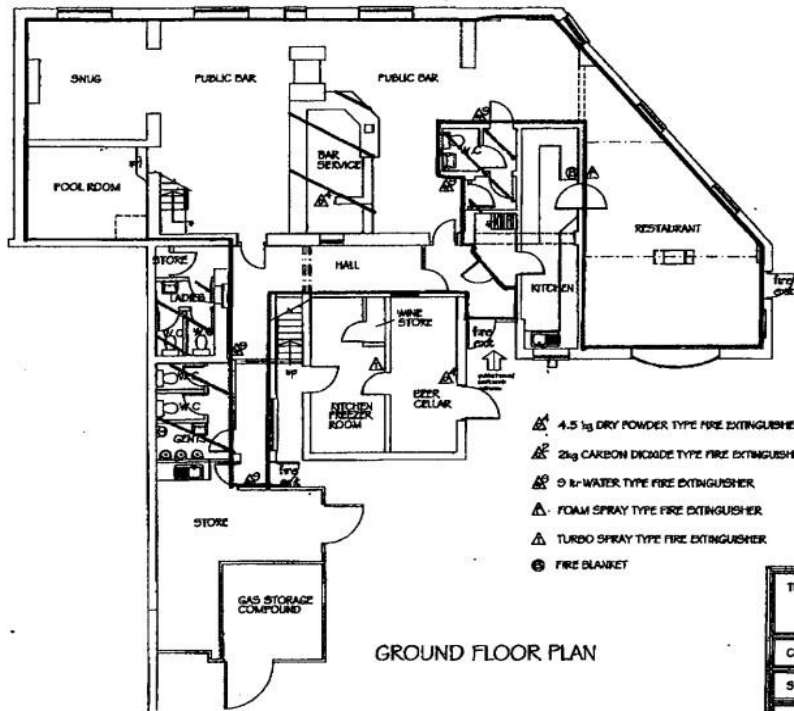

9. SEP. 2009 14:17  
GOSSEHALKS

NO. 816  
P. 8

# Map



