



Haynes Close, Thorne,
Doncaster



Offers in excess of £115,000

- Two Double Bedrooms
- Modern Kitchen
- Attention Investors
- Attention First Time Buyers
- Off Road Parking
- NO CHAIN
- Freehold
- EPC rating TBC



Situated in the popular market town of Thorne and within walking distance to all local amenities and transport links this property is perfect for first time buyers and investors alike.

The semi-detached property comprises a spacious lounge/diner, a modern kitchen with integrated oven, two double bedrooms and a family bathroom. Outside there is off road parking for multiple vehicles and an enclosed rear garden with brick outbuilding and grassed and paved areas perfect for entertaining.

Call our office now to arrange a viewing!



Entrance/Hall

Lounge/Diner - 5.91m x 3.41m(max)

Kitchen - 3.83m(max) x 2.35m(max)

Stairs & Landing

Bathroom - 1.83m x 1.64m

Bedroom One - 3.41m(max) x 3.10m

Bedroom Two - 4.30m x 2.72m

Disclaimer - Haynes Close- These details are intended to give a fair description only and their accuracy cannot be guaranteed nor are any floor plans (if included) exactly to scale. These details do not constitute part of any offer or contract and are not to be relied upon as statements of representation or fact. Intended purchasers are advised to recheck all measurements before committing to any expense and to verify the legal title of the property from their legal representative. Any contents shown in the images contained within these particulars will not be included in the sale unless otherwise stated or following individual negotiations with the vendor. Northwood have not tested any apparatus, equipment, fixtures or services so cannot confirm that they are in working order and the property is sold on this basis.





Ground Floor

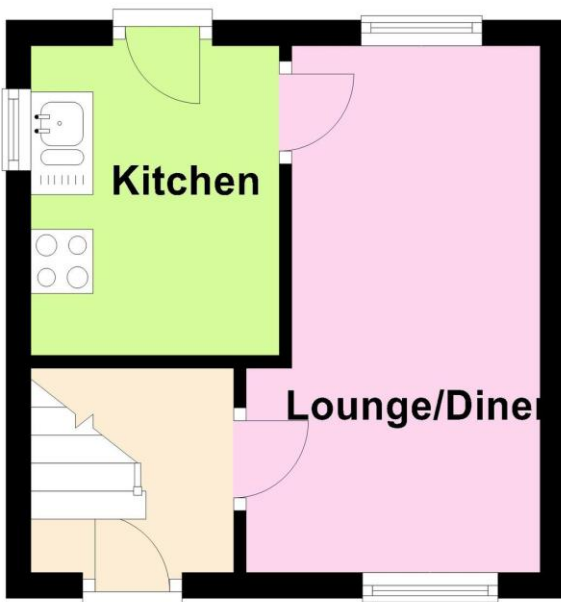

First Floor

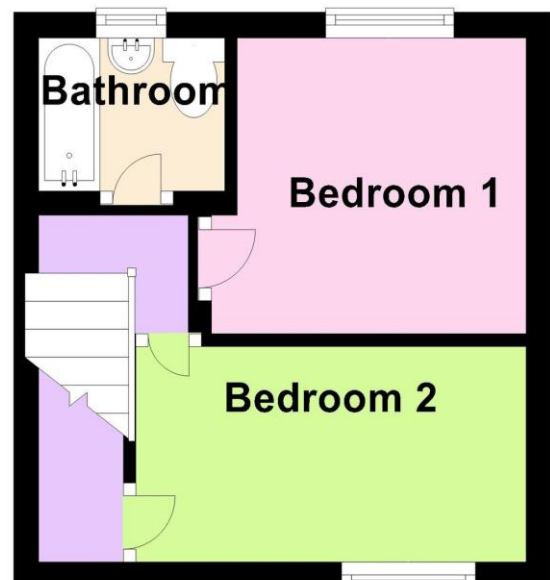



Northwood Thorne

01405 814999

thorne@northwooduk.com