



Littlewood Road, Thorne, Doncaster

Offers in excess of £145,000



Freehold | EPC Rating: B

- Mid-Terrace
- Living/Dining Room
- Outbuildings
- Four Bedrooms
- Large Rear Garden
- Solar Panels



Email
thorne@northwooduk.com

Phone
01405 814999

Description

Northwood Thorne are proud to present to the market this mid-terrace, four bedroom property in the market town of Thorne. This home is perfect for a growing family or for an investor to add to their portfolio. The downstairs of this property boasts good sized entrance hall, a large living room with windows to the front and back of the property with room for a dining area and a modern kitchen. The upstairs consists of two double bedrooms, a further two single bedrooms and a family bathroom. The outside has a fully enclosed, large rear garden with grassed area, patio area and three brick outbuildings, one of which has a W/C. The front is beautifully maintained with a grassed area and pathway. This property is a stone's throw away from the local amenities and schools, a short walk into the town centre and within close driving distance to the motorway links. Don't miss your chance on viewing this home, call our offices now to book your appointment!

Disclaimer These details are intended to give a fair description only and their accuracy cannot be guaranteed nor are any floor plans (if included) exactly to scale. These details do not constitute part of any offer or contract and are not to be relied upon as statements of representation or fact. Intended purchasers are advised to recheck all measurements before committing to any expense and to verify the legal title of the property from their legal representative. Any contents shown in the images contained within these particulars will not be included in the sale unless otherwise stated or following individual negotiations with the vendor. Northwood have not tested any apparatus, equipment, fixtures or services so cannot confirm that they are in working order and the property is sold on this basis.

Floorplan

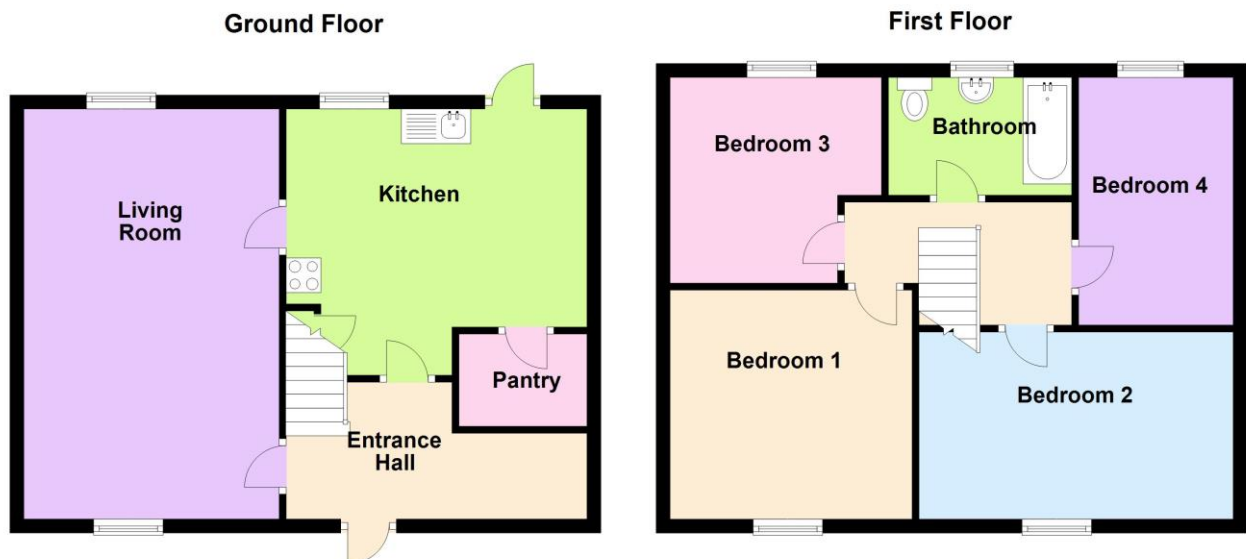

Rooms

Entrance

Front facing door with side panels, wall mounted boiler, radiator, phone point.

Kitchen

Back facing door, back facing window, pantry, under stair storage, wall and base units, extractor fan, ceramic hob, electric oven, sink with mixer, tiled splashbacks, radiator, laminate flooring.
9.5ft x 11.5ft (2.9m x 3.5m)

Living Room

Front facing window, back facing window, electric fire with surround, radiator x 2, laminate flooring, TV point.
11.4ft x 20.3ft (3.49m x 6.2m)

Stairs & Landing

Storage cupboard, carpet, hand rail, loft hatch, radiator.

Bedroom One

Front facing window, laminate flooring, radiator.
11.5ft x 11.5ft (3.5m x 3.5m)

Bedroom Two

Front facing window, laminate flooring, radiator.
9.9ft x 13.2ft (3.03m x 4.03m)

Bedroom Three

Back facing window, laminate flooring, radiator.
8.9ft x 9.2ft (2.7m x 2.8m)

Bedroom Four

Back facing window, laminate flooring, radiator.
7.6ft x 10.2ft (2.31m x 3.1m)

Bathroom

Back facing window, toilet, sink, bath with shower over, vinyl flooring, towel radiator, cladded walls.
5.6ft x 7.3ft (1.71m x 2.24m)

Rear Garden

Brick built outbuildings x 3, one with W/C. Fully enclosed, grassed area, patio area, mature shrubs.

Front Garden

Grassed area, pathway.

Photographs



Map



Notes