



**WETHERELL**  
MAYFAIR'S FINEST PROPERTIES



## South Audley Street, W1K

**£1,250 Per week**

A spacious double bedroom apartment situated on the ground floor of a popular portered building in the heart of Mayfair.

This stylish apartment has been meticulously refurbished throughout to provide a modern and contemporary living space within a classic portered Mayfair building within a classic ported Mayfair Building.

Recently refurbished with an open reception, two spacious bedrooms, two bathrooms and a modernised kitchen.

Situated in Chesterfield Gardens, a tree-lined quiet cul-de-sac, this purpose-built block is well located just off Curzon Street, moments from the open spaces of Hyde Park and the boutique shops of Mount Street.



### FEATURES

- Two Double Bedrooms • Two Bathrooms • Open Reception Room • 24 Hour Porter • Newly Refurbished • Lift •



South Audley Street,  
London, W1K

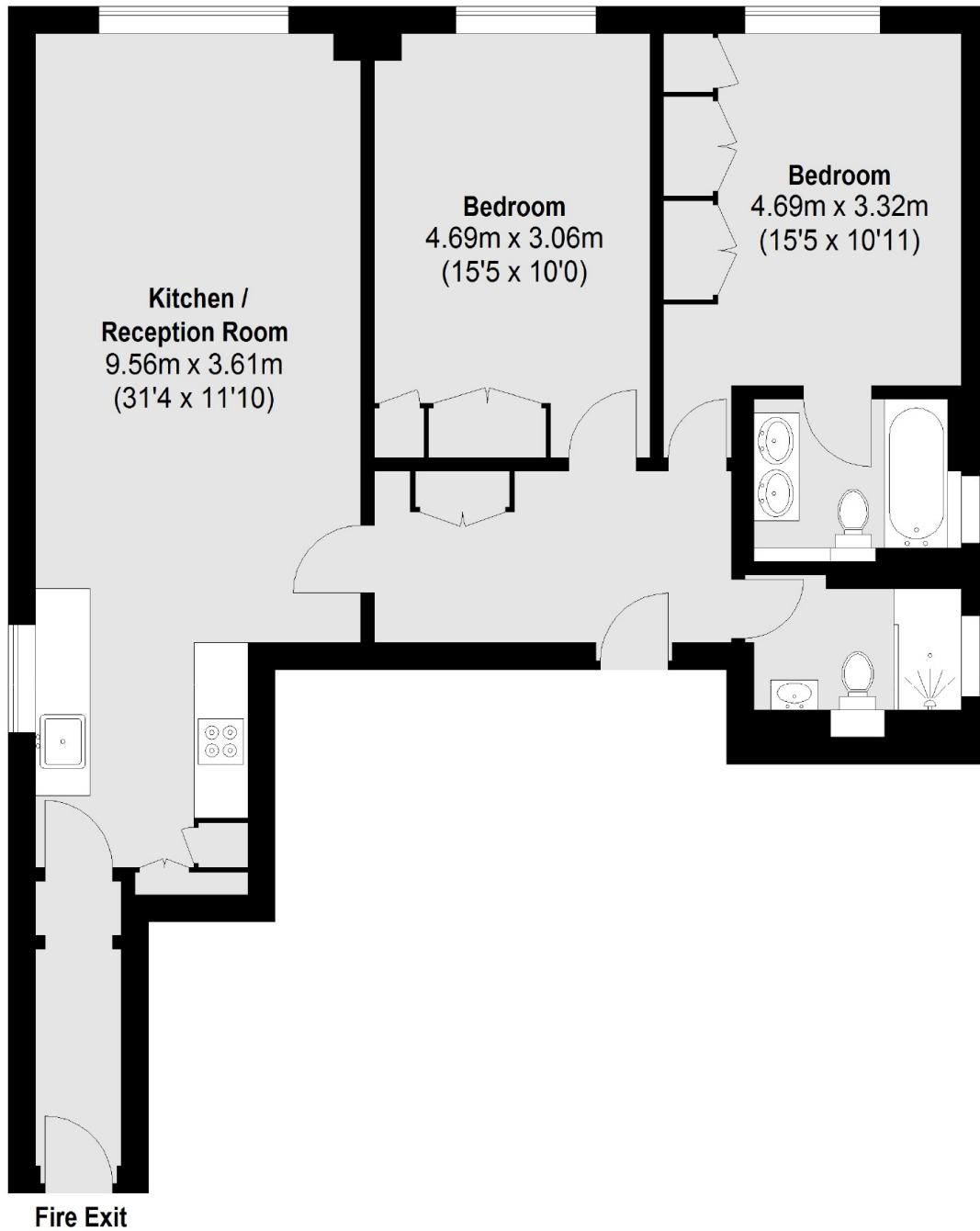

### Ground Floor

Total area (approx.): 81.37 sq. m (876 sq. ft)



**WETHERELL**  
MAYFAIR'S FINEST PROPERTIES

102 Mount Street,  
London, W1K 2TH

T: 020 7529 5588  
E: [rentals@wetherell.co.uk](mailto:rentals@wetherell.co.uk)

We aim to make our particulars both accurate and reliable. However they are not guaranteed; nor do they form part of an offer or contract. If you require clarification on any points then please contact us, especially if you're traveling some distance to view. Please note that appliances and heating systems have not been tested and therefore no warranties can be given as to their working order.



[wetherell.co.uk](http://wetherell.co.uk)