



Hertford Street, W1J

£1,100 Per week

A two double bedroom, two bathroom apartment on the first floor with a large reception room overlooking the courtyard.

Within the vibrant area of Shepherd's Market this building is to the east side of Hertford Street, close to Green Park underground station.

Features

- Two Double Bedrooms
- Two Bathrooms
- Lift Access
- 24 hr Porter
- Wood Flooring
- Green Park

Hertford Street, London, W1J

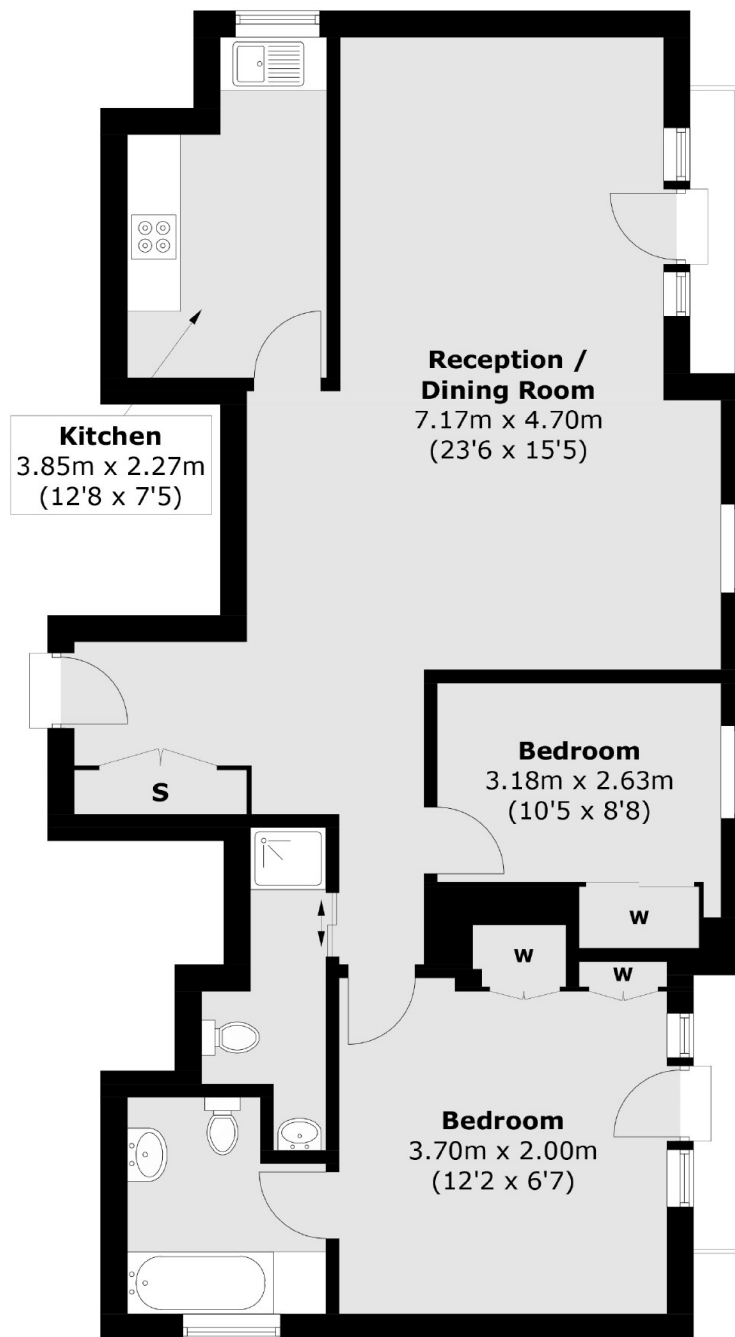

First Floor

Total area (approx.): 84.2 sq. m (906.6 sq. ft)
External area : 3.1 sq. m (33.3 sq. ft)

Dexters

Mayfair
102 Mount Street
London
W1K 2TH
Lettings
020 7529 5588

Energy Rating: E. We aim to make our particulars both accurate and reliable. However they are not guaranteed; nor do they form part of an offer or contract. If you require clarification on any points then please contact us, especially if you're traveling some distance to view. Please note that appliances and heating systems have not been tested and therefore no warranties can be given as to their good working order.

 **RICS** | Regulated
Estate Agent
and Letting Agent

dexters.co.uk