



Upper Brook Street, W1K

£690 Per week

A newly refurbished one double bedroom apartment located on the sixth floor of this period block with portorage and lift.

The building is on the south side of Upper Brook Street between Park Street and Park Lane, close to Hyde Park.

Features

- Spacious Double Bedroom
- Brand New Renovation
- Air Conditioning
- Portered Building
- Sixth Floor
- Lift

Upper Brook Street, London, W1K

Sixth Floor

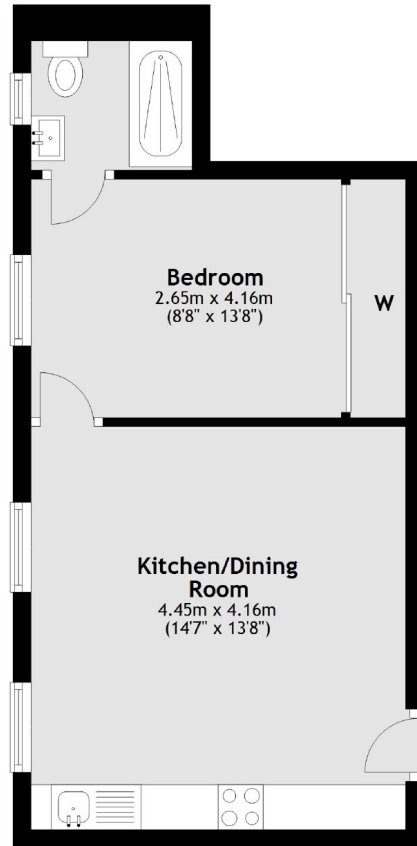

Total area: approx. 33.1 sq. metres (355.9 sq. feet)