

Hertford Street, W1J

£1,000 Per week

A well presented two double bedroom, two bathroom, furnished apartment set in this purpose built sought after block benefiting from lift access and 24-hour uniformed porter on site.

Located in the heart of Mayfair this property is situated close to the green spaces of Hyde Park, Green Park and the world famous eating and shopping facilities of Mayfair.

Features

- Two Double Bedrooms
- Two Bathrooms
- Lift Access
- 24-Hour Porter
- Furnished
- Excellent Location

Hertford Street, London, W1J

Hertford Street, W1J

Approximate Gross Internal Area = 80 sq m / 861 sq ft

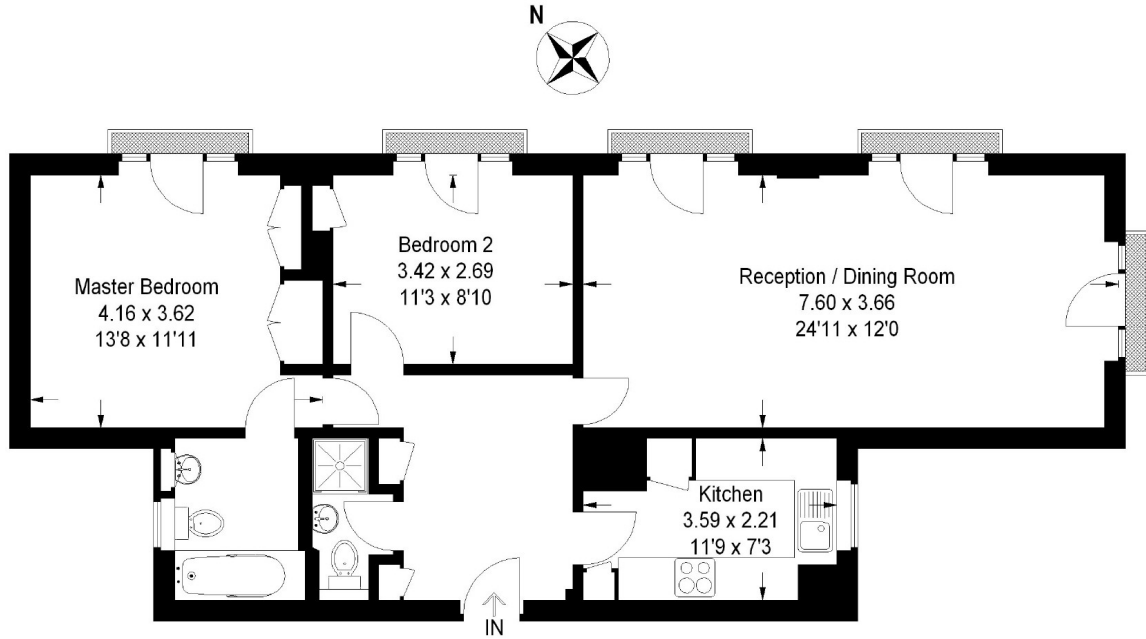

Second Floor

Illustration for identification purposes only, measurements are approximate, not to scale.
FloorplansUsketch.com © 2014 (ID103309)