



## Grosvenor Street, W1K

£625 Per week

A one bedroom apartment set within this purpose built red brick mansion block with lift and porter. The property has a separate kitchen, built-in storage and wooden flooring in the bedroom.

The property is ideally situated close to Bond Street station and close to Oxford Street and Grosvenor Square.

### Features

- Spacious Double Bedroom
- Porter
- Lift Access
- Built-In Storage
- Open Plan Kitchen
- Excellent Location

# Grosvenor Street, London, W1K

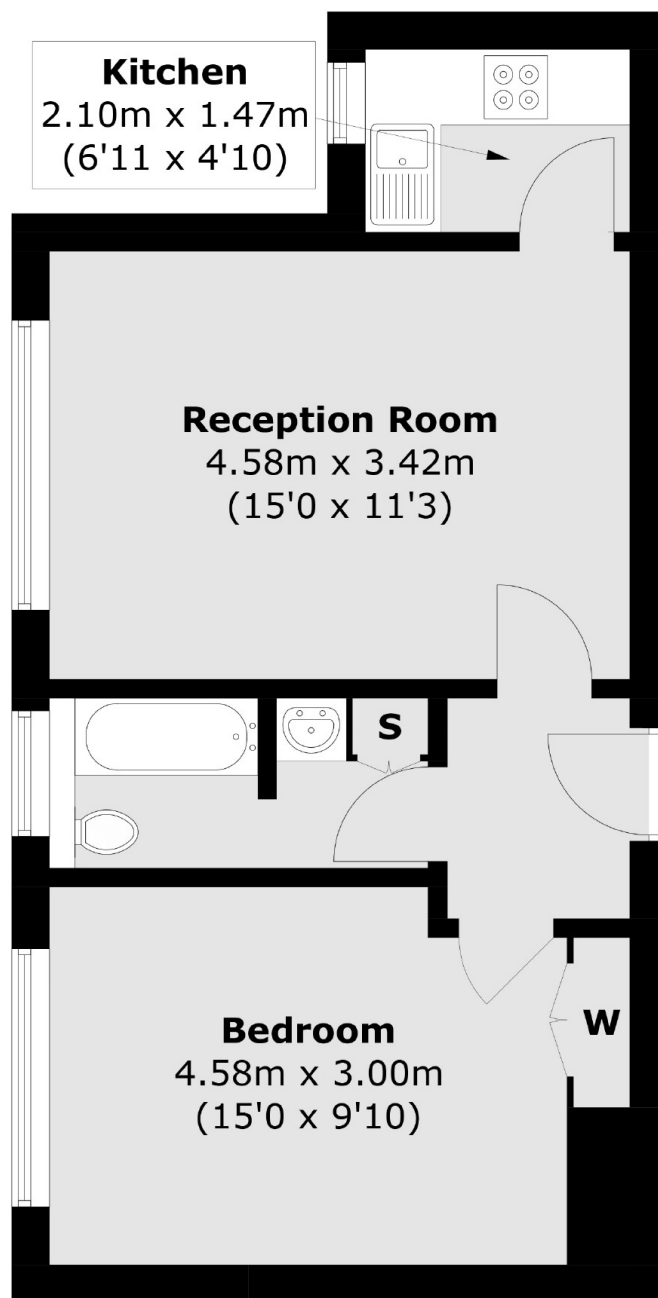

## Third Floor

Total area (approx.): 40.5 sq. m (435.9 sq. ft)