



Grosvenor Street, W1K

£650 Per week

Set on the sixth floor, this one bedroom apartment has been recently refurbished. The property benefits from secure entry systems, lift access and a day porter.

Ideally situated close to Bond Street Station and within moments of Oxford Street, Grosvenor Square and Hyde Park.

Features

- One Double Bedroom
- Sixth Floor (Lift Access)
- Recently Refurbished
- Day Porter
- Built-In Storage
- Excellent Location

Grosvenor Street, London, W1K

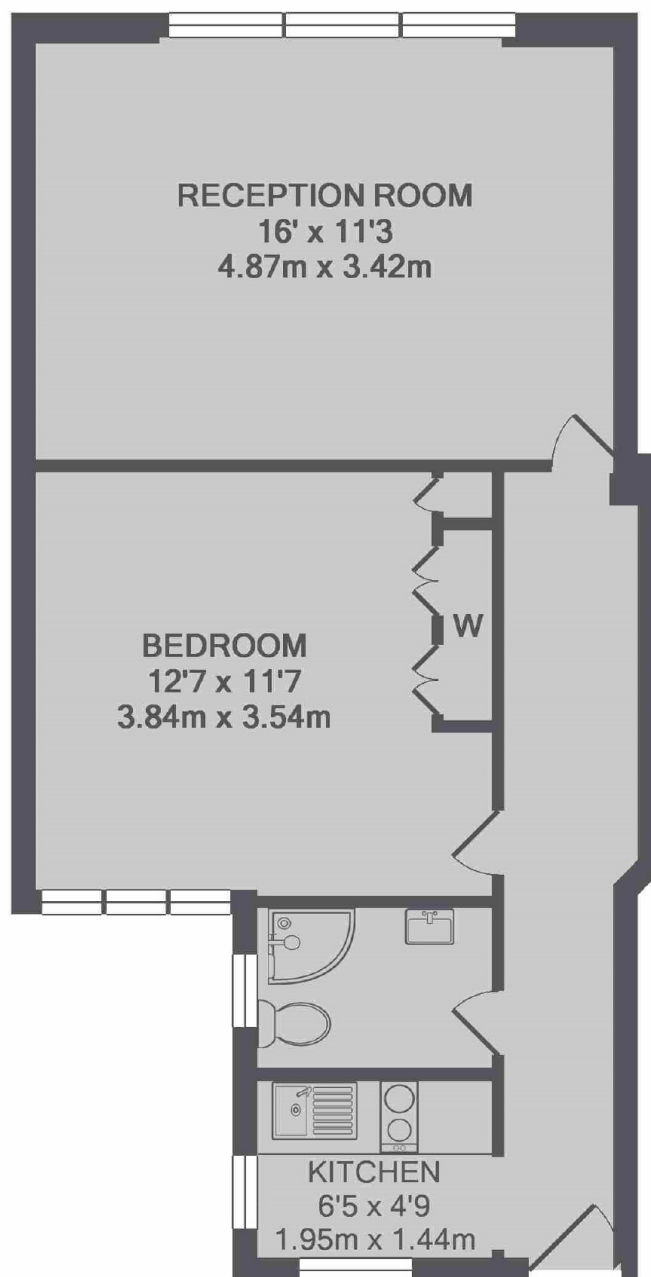

TOTAL APPROX. FLOOR AREA 474 SQ.FT. (44.0 SQ.M.)
Made with Metropix ©2018