



16a Newchapel Road

ST7 4SG

Offers In The Region Of £125,000



3



1



1



STEPHENSON BROWNE

NO ONWARD CHAIN & PRIVATE, SOUTH FACING REAR GARDEN - A versatile, two/three bedroom semi-detached dormer bungalow enjoying an elevated position on a well established road, close to local schooling and not too far from a wide variety of shops and day-to-day amenities that Kidsgrove has to offer.

The property does require some form of modernisation throughout however, benefits from a modern boiler, partial double glazing, parquet woodblock flooring to the majority of the ground floor, a downstairs bathroom with white suite and in addition there are a number of lean to alterations that have been added in more recent years.

Externally, there are gardens to both front and rear plus a tarmac driveway providing invaluable off road parking. The rear garden has a good degree of privacy, a southerly aspect and has a pleasant view overlooking Rookery.

Contact Stephenson Browne today to arrange your viewing!

Accommodation

Having a covered entrance porch and a wooden panelled entrance door opening into:

Entrance Porch

With tiled flooring, glazed windows to front, and side elevation, door into:

Entrance Hall

With tiled flooring, shelving, ceiling light, Door into:

Kitchen

9'2" x 7'5" (2.816 x 2.261)

With a continuation of the ceramic tiled flooring from the entrance hall, two double glazed windows to side elevation, two wall lights, decorative wall tiling, ceiling light, telephone point, a range of wall, base and drawer units with working surfaces over incorporating an inset, stainless steel sink/drainage unit with mixer tap, an integrated four ring gas hob with tiled splashback, extractor canopy over and built-in oven below, radiator and space for further under-counter, white goods.

Lounge

16'1" x 10'8" (4.921 x 3.254)

With parquet wood block flooring, double glazed window to front elevation, pendant light, TV point, radiator, a gas living flame effect feature fire with stone hearth and surround, two walls lights, an access door leading to the inner lobby, archway leading into:

Dining Area

12'2" x 9'2" (3.714 x 2.818)

With double glazed window to rear elevation, stairs to first floor, radiator, a wall mounted electric heater, a continuation of the wood block flooring from the lounge area, pendant light, coving and useful built-in understand storage cupboard.

Inner Lobby

With a built-in storage cupboard housing the hot water cylinder with an airing cupboard over, vinyl flooring, pendant lights, door into:

Bedroom

9'3" x 8'11" (2.823 x 2.742)

With vinyl flooring, double glazed sliding patio door, leading to the lean to conservatory/garden room, radiator, ample power points, coving and pendant light, door into:

Bathroom

With vinyl flooring, double glazed window to side elevation, ceiling light, radiator, partially tiled walls and white three-piece suite, comprising of: low-level WC, pedestal hand wash basin with chrome taps plus a panelled bath with chrome taps and a handheld shower attachment.

First Floor Landing

With access to both bedrooms, pendant light, door into:





Bedroom One

13'1" x 9'2" (3.991 x 2.810)

With double glazed window to front, pendant light, telephone point, radiator, ample power points, built-in bedroom furniture to include a range of cupboard storage, plus eaves storage where a wall mounted gas boiler can be found, serving the central heating and domestic hot water systems.

Bedroom Two

13'0" x 5'11" (3.983 x 1.815)

With double glazed window to front, pendant light, eaves storage, built-in storage plus additional bedroom furniture with cupboard space below and a radiator.

Lean-to Garden Room

16'7" x 5'9" (5.055 x 1.765)

With tiled flooring, power, glazed windows to front and side elevation and a glazed single sliding door giving access to the rear garden.

Externally

The rear garden is fully enclosed with a southerly aspect and enjoys a good degree of privacy. There is a paved patio area providing ample space for garden furniture, a number of external garden stores, an ornamental garden pond with water feature, a further seating area at the foot of the garden which can be accessed via steps with raised, easy to maintain borders either side home to a number of flower and shrub sections.

At the front the property is approached via a tarmac driveway in turn providing invaluable off road parking, step leading to the entrance door, a front garden which has been designed for ease of maintenance in mind (or could offer potential for additional parking), there are wrought iron double gates leading to a covered area with water point, a timber framed sun room/greenhouse plus access to the rear garden.

Council Tax Band

The council tax band for this property is B.

NB: Tenure

We have been advised that the property tenure is freehold, we would advise any potential purchasers to confirm this with a conveyancer prior to exchange of contracts.

NB: Land Registry

Please be advised that we have not been able to obtain a copy of the title register with land registry through our due diligence process. This does not conclude that the property is not registered however, we would advise you raise this point with a licensed conveyancer to avoid any potential delay with a purchase.

NB: Copyright

The copyright of all details, photographs and floorplans remain the possession of Stephenson Browne.

Floor Plan

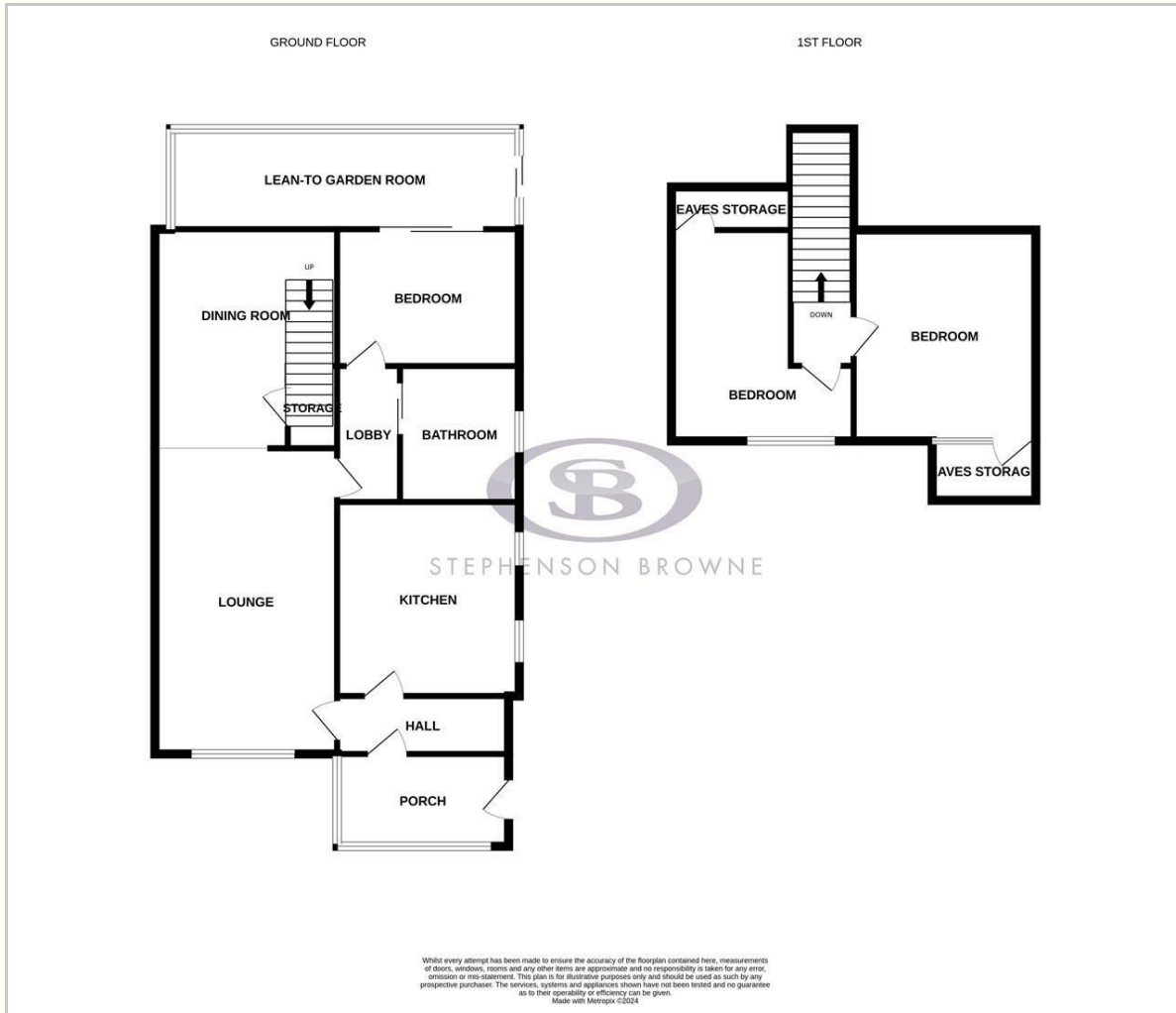

Viewing

Please contact our Alsager Office on 01270 883130 if you wish to arrange a viewing appointment for this property or require further information.

Area Map



Energy Efficiency Graph

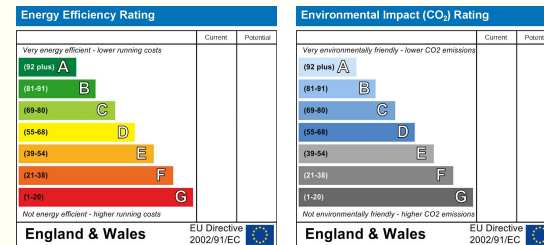

NOTICE: Stephenson Browne for themselves and for the vendors or lessors of this property whose agents they are give notice that: (1) the particulars are set out as a general guideline only for the guidance of intending purchasers or lessees, and do not constitute, nor constitute part of, an offer or contract; (2) all descriptions, dimensions, references to condition and necessary permissions for use and occupation, and other details are given in good faith and are believed to be correct but any intending purchasers or tenants should not rely on them as statements or representations of fact but must satisfy themselves by inspection or otherwise as to the correctness of each theme; (3) no person in the employment of Stephenson Browne has any authority to make representation or warranty whatever in relation to this property. (4) fixtures & fittings are subject to a formal list supplied by the vendors solicitors. **Referring to: Move with Us Ltd Average Fee: £123.64**

13 Crewe Road, Alsager, Stoke On Trent, ST7 2EW

T: 01270 883130 E: alsager@stephensonbrowne.co.uk | www.stephensonbrowne.co.uk